



TPI CORPORATION

America's Comfort Conditioning Company



2021 ELECTRICAL PRODUCTS CATALOG

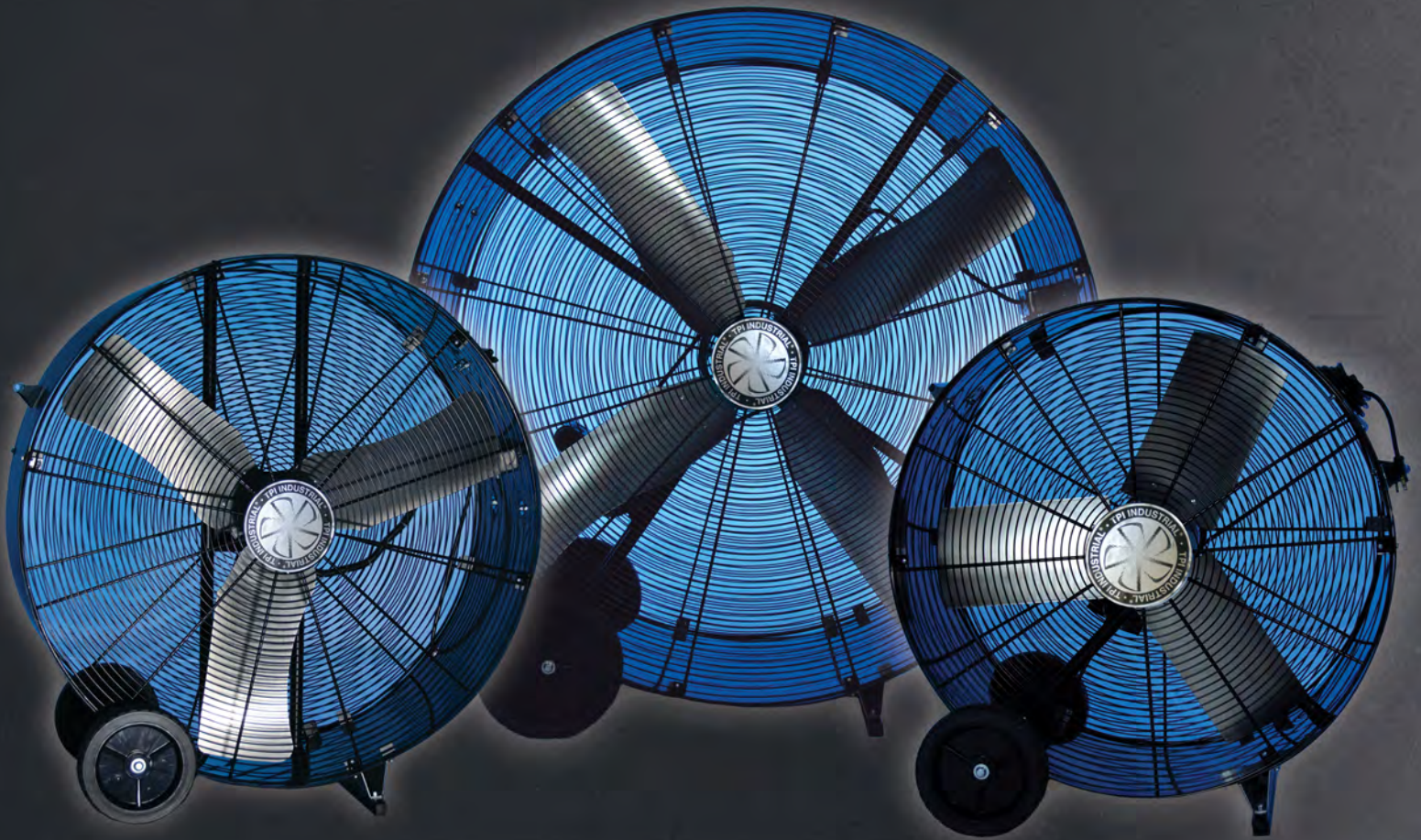

VENTILATION, FANS, & INDUSTRIAL LIGHTING
INDUSTRIAL - COMMERCIAL - RESIDENTIAL

© Copyright 2021; TPI Corporation, P.O. Box 4973, Johnson City, TN 37602
December 11, 2020: Distribution Products Catalog - REV: 08052021- PRINT DATE: 12/11/2020



www.facebook.com/tpicorporation



[@tpicorporation](https://twitter.com/tpicorporation)

Tel: 1-800-682-3398 | 1-423-477-4131 | Fax: 1-423-477-0064 | www.tpicorp.com

FANS

LIGHTS

Table Of Contents & Limited Warranty

CATEGORY	PAGE
INDUSTRIAL CIRCULATORS	
24" & 30" Assembled Maximum Duty	2
20" to 36" Assembled Circulator Heads & Mounts	3
20" 24" & 30" Unassembled Circulators	4
20" 24" & 30" Specialty Circulator Heads	5
Components - Motor Comparisons	6
Air Circulators - Motor Comparisons	7
COMMERCIAL CIRCULATORS	
20", 24" & 30" Commercial Non-Osc. Circulators	8
20", 24" & 30" Commercial Oscillating Circulators	8
COMMERCIAL BLOWERS	
36" 42" & 48" Belt Drive Portable	9
24" 30" & 36" Direct Drive Portable	9
INDUSTRIAL BLOWERS	
30" 36" & 42" Direct Drive Portable	10
48" Direct Drive Portable	10
36" 42" & 48" Belt Drive Portable	11
30" 36" & 42" Direct Drive Suspension	12
36" 42" & 48" Belt Drive Suspension	12
24" & 30" Mini	13
Heavy Duty Square Belt Drive Portable	13
High Velocity	14-15
Heavy Duty Direct Drive	16
Heavy Duty Permanent Mount Direct Drive	17
WORKSTATION FANS	
Industrial Floor	18
Corrosion Resistant Industrial Floor	18
Industrial Mounted	19
Outdoor Rated Yoke Mount	19
Commercial Floor	20
Oscillating Office	20
Wall Mounted With Pivoting Arm	21
Low Velocity "Special Application"	21
MISTING FANS	
18" Portable Self Contained	22

CATEGORY	PAGE
CEILING FANS	
Industrial Ceiling Fans	23
EXHAUST FANS & GUARDS	
Shutter Mounted Direct Drive	24
Guard Mounted Direct Drive	25
Venturi Mounted Direct Drive	26
Commercial Belt Drive - (Fans & Shutters)	27
Industrial Direct Drive	28
Industrial Belt Drive	29
Heavy Duty Direct Drive	30
Heavy Duty Belt Drive	31
Cabinet Exhaust Fans With Shutters	32
Accessories / Heavy Duty Shutters	33
Cabinet Accessories / Guards	34
Cabinet Exhaust Fan Package Options	35
Weather Hood	35
ROOF VENTILATORS	
Insulated Roof Curbs	36
Belt Drive Hooded Roof Ventilator	37
Direct Drive Roof Ventilator	38
Belt Drive Roof Ventilator	39
TUBEAXIAL DUCT FAN	
Direct Drive & Guards	40
Belt Drive	41
ATTIC FANS	
Roof Domes, Gable Fans, Attic Fans	42
INDUSTRIAL LIGHT PRODUCTS	
Portable Utility Lights	43
Heavy Duty Portable Utility Lights	44
Commercial Duty Portable Utility Lights	44
Loading Dock - Fully Assembled, Standard	45
Ceiling Mounted Incandescent Flex Arm	45
Modular Loading Dock Lights / Heavy Duty	46
Loading Dock Arm Fan	46
Machine Tube Lights	47
LED Machine Lights	48
Illuminated Fluorescent Magnifiers	48
PRODUCT INDEX	49-53

TPI Corporation provides a limited warranty of materials and workmanship for a period of (i) ten (10) years for elements in 2900 Series baseboard heaters, (ii) two (2) years for Thermostats and Controls, (iii) five (5) years on HD and HDH series fans, (iv) three (3) years on UHP and IHP series fans, (v) and twelve (12) months for all other products, with the warranty period commencing on the original date of purchase. The TPI warranty is limited to materials manufactured and work performed by TPI Corporation, and does not include damage or failure caused by acts of God, abuse, misuse, connected to or placed on other than rated voltage, abnormal usage, faulty installation, failure to follow suggested maintenance procedures enclosed with the product, improper maintenance or any repairs other than those provided by an authorized TPI Corporation service center. For the name of your nearest authorized TPI Corporation service center, please write to TPI Corporation, P.O. Box 4973, Johnson City, Tennessee, 37602 or call 1-800-682-3398.

During the warranty period, TPI Corporation will, at its sole option, repair or replace any defective parts or products returned, freight prepaid, to the TPI Corporation factory or such other location as TPI Corporation may designate. No parts or products will be accepted for repair or replacement without prior authorization from TPI Corporation and a return merchandise authority (RMA) number issued by TPI Corporation. Returned products must be packaged carefully and TPI Corporation shall not be responsible for damage in transit. When returning parts, the owner must provide the model number of the product and nature of difficulty being experienced.

This warranty does not obligate TPI Corporation to bear the cost of labor in replacing any assembly, unit or component part thereof, nor does TPI Corporation assume any liability for secondary charges, expenses for installing or removal, freight or damages. There will be charges rendered for product repairs made after the warranty period has expired. Proof of purchase, including date, must accompany request for in-warranty service. This warranty gives you specific legal rights and you may have other rights, which may vary, from state to state.

Except for the limited warranty provided in the foregoing paragraph, all parts and products sold by TPI Corporation are sold 'as is', 'where is', and without any other warranty of any kind or nature, whether express, implied, or statutory and including, without limitation, any implied warranty of specific performance or merchantability.

Under no circumstances, even with respect to claims covered by the foregoing warranty, will TPI Corporation be responsible for any incidental, consequential, special, or punitive damages of any kind or nature arising from or related to the parts or products sold by TPI Corporation.

In any event, TPI Corporation's maximum liability shall not in any case exceed the purchase price for the part or product claimed to be defective.

You hereby expressly agree to waive any and all rights to a trial by jury with respect to any product manufactured or supplied by TPI Corporation.

RETURN POLICY:

Requests for returns of non-defective standard stock units may incur testing and repackaging charges if units are not in like new condition. Requests for returns of build to order items are subject to cancellation charges prior to shipment and up to a 100% restocking charge after shipment. This also applies to any standard model with factory installed control options or other custom features. Changes made to custom products during production may incur labor charges. Please consult factory for details on any return or change order

TPI COMMERCIAL CIRCULATORS STATEMENT:

TPI Commercial circulators have been developed to equal the imported circulators that are sold by big-box retail stores and some catalogers. Because these circulators do not have totally enclosed motors, they should be used in clean, dry commercial applications - such as schools, shops, offices, and warehouses.

Note: Prices subject to change without notice.

Ventilation Products Warranty Coverage	
Series HD or HDH fans	5 Years
Series UHP or IHP fans	3 Years
All other ventilation products	1 Year

TPI Industrial Assembled Maximum Duty Circulators

Features

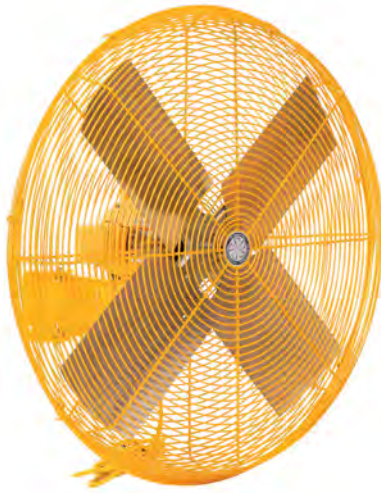

HDH Series

- Steel construction with safety yellow textured epoxy powder coated finish
- Direct drive, Totally Enclosed Air-Over (TEAO) motor generating up to 8,000-CFM's
- Aluminum 4-paddle blade system with steel hub and cast aluminum spider connections
- HDH-Series contains a pull-chain switch and 12' long SJT-Type cord with grounded plug
- HDH-JR Series contains a 12' long SJT-Type cord with grounded plug and 18" long drop-down cord assembled with an electrical (off, on low/high) switch enclosure
- Fully-Assembled Non-Oscillating fan heads in 24" or 30" diameter sizes
- 5-year motor warranty
- Made in the U.S.A. with domestic and foreign components

Motor Specifications

- 2-Speed
- 1-Phase, 120V
- Permanent split capacitor
- Frame size: 48
- 1/2 HP
- Ball bearing
- Totally enclosed, permanently lubricated
- 1/2" Shaft

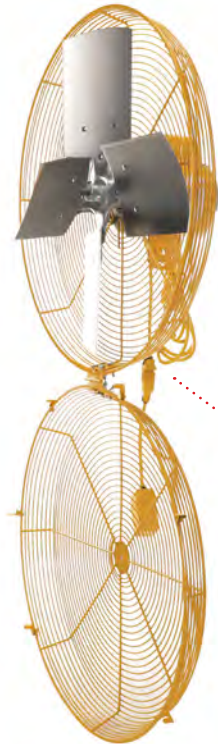

Hinged Guard



HDH-JR Series



Drop-Down Switch



Wall Mount see pg. 6

DIMENSIONS	
24"	27" Diameter x 14.5" Depth
30"	33.5" Diameter x 14.5" Depth

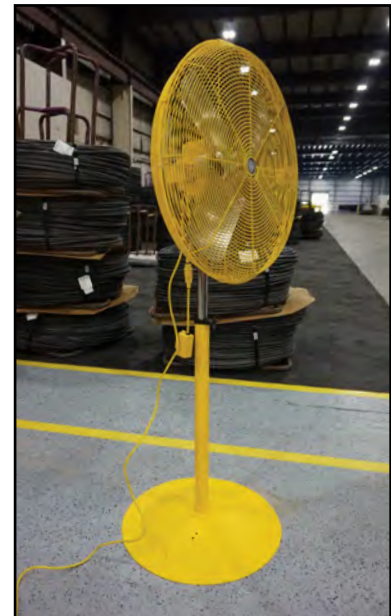

Pedestal Mount, see pg. 6



WARNING: This product can expose you to chemicals including nickel which is known to the State of California to cause cancer, and chromium, which is known to the State of California to cause birth defects and/or reproductive harm. For more information go to www.P65Warnings.ca.gov.

Standard Models

ASSEMBLED FAN HEAD		BLADE SIZE	SWITCH TYPE	HP	CFM* / RPM		VELOCITY PROFILE	AMPS	WT. (LBS)	LIST
MFG CATALOG NUMBER	MFG MODEL NUMBER				CFM / Area Sq Ft					
08744402	HDH 24-JR	24"	Drop Down	1/2	5600 / 1100	4900 / 800	7500 / 260	3.5	44	819
08744602	HDH 30-JR	30"			6800 / 1100	6000 / 800	8000 / 270	4	48	842
07960702	HDH 24	24"	Pull Chain		5600 / 1100	4900 / 800	7500 / 260	3.5	44	750
07960802	HDH 30	30"			6800 / 1100	6000 / 800	8000 / 270	4	48	768

*Measured 2 feet from face of fan

TPI offers six factory assembled and tested fan mounts that can be used with any of the non-oscillating TPI Industrial heads.

TPI Industrial Assembled Circulator Heads and Mounts

Features

- Steel construction with silver/gray powder coated; steel motor housing painted black
- Direct drive, Totally Enclosed Air-Over (TEAO) motor generating up to 12,000-CFM's
- Aluminum 3-paddle blade system with steel hub and cast aluminum spider connections
- All models contain a pull-chain switch and 12' long SJT-Type cord with grounded plug
- All models, except HDH-36, contain self-locking retaining clips to secure front/rear grills and meet OSHA safety requirements
- HDH-36 model operates at single speed, contains interlocking front/rear grills and includes a heavy-duty wall mounting bracket inside the carton
- HDH-GJR Series contains a 12' long SJT-Type cord with grounded plug and 18" long drop down cord assembled with an electrical (off, on low/high) switch enclosure
- Fully-Assembled ready for plug-&-play operation offered in Non-Oscillating (Stationary) and Oscillating fan heads in 20", 24" or 30" diameter sizes; mounts sold separately
- Oscillating models rotates in a 90° arc or can be locked in a fixed position
- Metal gears in the oscillating model allow the fan to operate at a maximum 30° downward tilt
- Motor warranty ranges from 1, 3 and 5-years
- Made in the U.S.A. with domestic and foreign components



ACM-IHP-HDH Series



HDH-G-JR Series
Drop-Down Plug
and Hinged Guard



ACH-O Series
Oscillating Motor

Motor Specifications

- 2-Speed
- 1 Phase, 120V
- Ball bearing
- Frame size: 48
- Totally enclosed
- Permanent split capacitor
- Permanently lubricated
- 1/2" Shaft

DIMENSIONS	
20"	22" Diameter x 14.5" Depth
24"	27" Diameter x 14.5" Depth
30"	33.5" Diameter x 14.5" Depth



WARNING: This product can expose you to chemicals including nickel which is known to the State of California to cause cancer, and chromium, which is known to the State of California to cause birth defects and/or reproductive harm. For more information go to www.P65Warnings.ca.gov.

Standard Models

H.P.	BLADE SIZE	MFG MODEL NUMBER	MFG CATALOG NUMBER	FAN HEAD TYPE	CFM*	VELOCITY PROFILE	RPM	AMPS	WT. (LBS)	LIST
						CFM / Area Sq Ft				
1 Year Warranty										
Industrial 1/4	20"	ACH 20	08684702	STATIONARY	3000 / 2600	5000 / 200	1100 / 900	2.4	39	384
	24"	ACH 24	07961602		3800 / 3400	6000 / 240	1100 / 800	2.5	40	431
	30"	ACH 30	07961702		4300 / 3800	7200 / 250	1100 / 800	2.7	44	445
3 Year Warranty										
High Performance 1/3	24"	IHP 24-H	07989802	STATIONARY	4300 / 3900	6000 / 240	1100 / 800	2.8	40	549
	30"	IHP 30-H	07989902		5400 / 4700	7200 / 250	1100 / 800	3	44	574
5 Year Warranty										
Heavy Duty 1/2	24"	HDH 24-G	08539202	STATIONARY	5600 / 4900	7500 / 260	1100 / 800	3.5	44	719
	30"	HDH 30-G	08528602		6800 / 6000	8000 / 270	1100 / 800	4	48	743
	24"	HDH 24-GJR	08745002		5600 / 4900	7500 / 260	1100 / 800	3.5	44	819
	30"	HDH 30-GJR	08745102		6800 / 6000	8000 / 270	1100 / 800	4	48	842
	36"	HDH 36	08197802		6970	12000 / 325	1100	5.2	90	788
1 Year Warranty										
Industrial Oscillating 1/4	20"	ACH 20-O	08684802	OSCILLATING	3000 / 2600	5000 / 200	1100 / 900	2.4	43	581
	24"	ACH 24-O	07963602		3800 / 3400	6000 / 240	1100 / 800	2.5	44	662
	30"	ACH 30-O	07963702		4300 / 3800	7200 / 250	1100 / 800	2.7	48	686

*Measured 2 feet from face of fan

HDH-36 Note: Wall mount only, mount included, unit imported to TPI specifications.

TPI offers six factory assembled and tested fan mounts that can be used with any of the non-oscillating TPI Industrial heads.

TPI Industrial Unassembled Circulators

Features

- Unassembled packaged kits, include: motor, blade, guards & mount (pedestal or wall)
- Steel construction with silver/gray powder coated; steel motor housing painted black
- Direct drive, Totally Enclosed Air-Over (TEAO) motor generating up to 7,200-CFM's
- Aluminum 3-paddle blade system with steel hub and cast aluminum spider connections
- All models contain a pull-chain switch and 12' long SJT-Type cord with grounded plug
- All models contain self-locking retaining clips to secure front/rear grills and meet OSHA safety requirements
- HDH-GJR Series contains a 12' long SJT-Type cord with grounded plug and 18" long drop down cord assembled with an electrical (off, on low/high) switch enclosure
- Offered in Non-Oscillating (Stationary) and Oscillating fan heads in 20", 24" or 30" diameter sizes
- Oscillating models rotates in a 90° arc or can be locked in a fixed position
- Metal gears in the oscillating model allow the fan to operate at a maximum 30° downward tilt
- Pedestal pole adjusts the center of fan from 48" to 67" tall; bolts to 27" diameter steel dome with 5-bolts
- Motor warranty from 1 or 3-years
- Made in the U.S.A. with domestic and foreign components

DIMENSIONS	
20"	22" Diameter x 14.5" Depth
24"	27" Diameter x 14.5" Depth
30"	33.5" Diameter x 14.5" Depth

WARNING: This product can expose you to chemicals including nickel which is known to the State of California to cause cancer, and chromium, which is known to the State of California to cause birth defects and/or reproductive harm. For more information go to www.P65Warnings.ca.gov.

Motor Specifications

- 2-speed
- 1-Phase, 120V
- Ball bearing
- Frame size: 48
- Totally enclosed
- Permanent split capacitor
- Permanently lubricated
- 1/2" Shaft



ACU-WO Series

Oscillating Fan Head with Wall Mount



UHP-P Series



Standard Models

FAN TYPE		MAXIMUM DUTY	MAX AMPS	HIGH PERFORMANCE	MAX AMPS	INDUSTRIAL	MAX AMPS	OSCILLATING	MAX AMPS							
MOTOR	HP	1/3		1/3		1/4		1/4								
CFM Velocity Profile / Area Sq. Ft.	20"	---	---	---	---	5000 / 200	2.4	5000 / 200	2.4							
	24"	6000 / 240	2.8	6000 / 240	2.8	6000 / 240	2.5	6000 / 240	2.5							
	30"	7200 / 250	3.0	7200 / 250	3.0	7200 / 250	2.7	7200 / 250	2.7							
WARRANTY		3 YEARS		3 YEARS		1 YEAR		1 YEAR								
SIZE	TYPE of MOUNT	MFG CATALOG NUMBER	MFG MODEL NUMBER	LIST	MFG CATALOG NUMBER	MFG MODEL NUMBER	WT. (LBS)	LIST	MFG CATALOG NUMBER	MFG MODEL NUMBER	WT. (LBS)	LIST	MFG CATALOG NUMBER	MFG MODEL NUMBER	WT. (LBS)	LIST
20"	Pedestal Mount	---	---	---	---	---	---	---	08681402	ACU 20-P	72	534	08681602	ACU 20-PO	76	565
	Wall Mount	---	---	---	---	---	---	---	08681502	ACU 20-W	42	435	08681702	ACU 20-WO	46	453
24"	Pedestal Mount	08745202	UHP 24-PJR	890	07990002	UHP 24-P	75	743	07962302	ACU 24-P	75	553	07964002	ACU 24-PO	79	839
	Wall Mount	08745402	UHP 24-WJR	751	07990202	UHP 24-W	45	607	07962402	ACU 24-W	45	461	07964102	ACU 24-WO	49	702
30"	Pedestal Mount	08745302	UHP 30-PJR	910	07990102	UHP 30-P	73	768	07962802	ACU 30-P	73	569	07964202	ACU 30-PO	82	857
	Wall Mount	08745502	UHP 30-WJR	776	07990602	UHP 30-W	48	629	07962902	ACU 30-W	48	478	07964302	ACU 30-WO	52	719

TPI Industrial Specialty Circulator Heads

Features

- No cord-junction box provided for hard wiring
- Steel hub/spider aluminum paddle blades
- Coated steel guards
- Meets OSHA standards
- 1 year limited warranty
- Made in U.S.A. with domestic and foreign components

Motor Specifications

- All 1 Speed (except 277V which is 2 Speed)
- Totally enclosed, permanently lubricated
- Ball bearing



ACH-EX SERIES



Intertek

*Listing applies to 277V models only

IHP-H-277 SERIES



IHP-H-WD SERIES

WARNING: This product can expose you to chemicals including nickel which is known to the State of California to cause cancer, and chromium, which is known to the State of California to cause birth defects and/or reproductive harm. For more information go to www.P65Warnings.ca.gov.

Standard Models

GENERAL DESCRIPTION	MFG MODEL NUMBER	MFG CATALOG NUMBER	SIZE	CFM*		VELOCITY PROFILE CFM / Area Sq Ft	MOTOR			AMPS (HIGH)					WT. (LBS)	LIST
				HIGH	LOW		HP	RPM	VOLTS	120v 1 ph	240v 1 ph	277v 1 ph	240v 3 ph	480v 3 ph		
Hazardous Location Class I Group D Class II Group F & G Unassembled Head	ACH 24-EX1	08551902	24"	4300		6000 / 240	1/4	1725	120 or 240 1-phase	5	2.6	----	----	----	66	1330
	ACH 30-EX1	08552002	30"	5400		7200 / 250									69	1443
	ACH 24-EX3	08552102	24"	4300		6000 / 240									66	1419
	ACH 30-EX3	08552202	30"	5400		7200 / 250									69	1553
240V / 480V 3-Phase Unassembled Head	ACH 24-TE3	08552302	24"	4300		6000 / 240	1/4	1725	240 or 480 3-phase	----	----	----	1.4	0.7	45	918
	ACH 30-TE3	08552402	30"	5400		7200 / 250									48	939
277 Volt Assembled Head	IHP 24-H-277	08541302	24"	4300	3900	6000 / 240	1/3	1125	277 1-phase	----	----	1	----	----	40	645
	IHP 30-H-277	08542202	30"	5400	4700	7200 / 250									44	686
Wash down rated 120V / 240V 1-Phase Assembled Head	IHP 20-H-WD	08721902	20"	3200		5200 / 220	1/3	1725	120 or 240 1-phase	4.5	2.2	----	----	----	46	1226
	IHP 24-H-WD	08541802	24"	4300		6000 / 240									48	1271
	IHP 30-H-WD	08541902	30"	5400		7200 / 250									52	1314

*Measured 2 feet from face of fan

Note: Wash down rated fan heads have heavy zinc coated guards - Use FDA white coated mounts shown on page 7 for food service applications

TPI Industrial Circulator Components

Standard Models

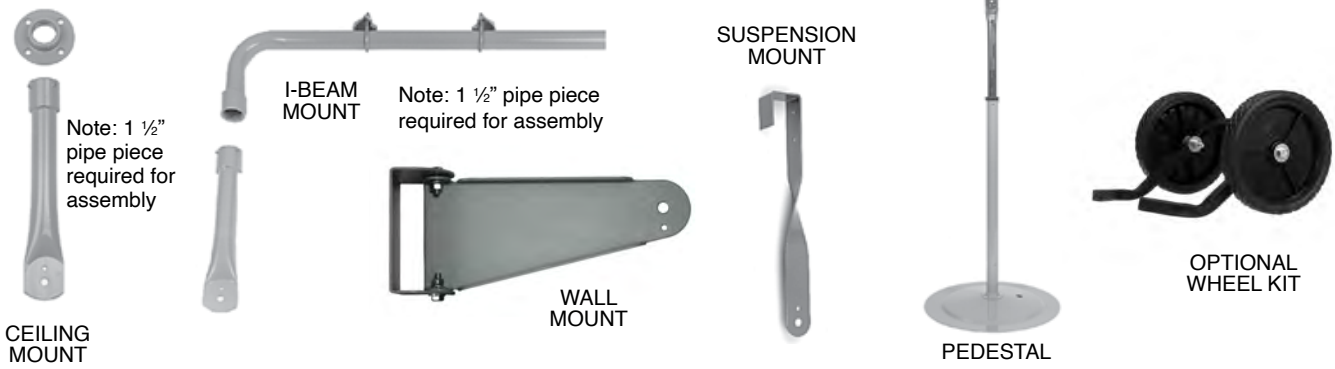

Product Specifications

- Pedestal pole adjusts the center of fan from 48" to 67" and bolts to 27" diameter steel dome base with 5 bolts
- I-beam mount & ceiling mount require 1 1/2" or longer pipe nipple for assembly (not supplied)
- Pole mount attaches to 4", 6", or 8" with U-bolts (not supplied)
- Wheel kit and pole mount have an all black textured powder coated finish

TYPE	MFG CATALOG NUMBER	MFG MODEL NUMBER	LIST
YELLOW MOUNTS			
PEDESTAL POLE & BASE	07960902	HDM-P	250
WALL MOUNT	07961002	HDM-W	100
I-BEAM MOUNT	07961102	HDM-I	190
CEILING MOUNT	07961202	HDM-C	109
GRAY MOUNTS			
PEDESTAL POLE & BASE	07961802	ACM-P	236
WALL MOUNT	07961902	ACM-W	91
I-BEAM MOUNT	07962002	ACM-I	179
CEILING MOUNT	07962102	ACM-C	118
SUSPENSION MOUNT	07962202	ACM-S	81
POLE MOUNT	08681802	ACM-PM	130
WHEEL KIT	08681302	ACM-WK	110
FDA WHITE MOUNTS FOR USE WITH WASHDOWN FAN HEADS IN FOOD SERVICE APPLICATIONS			
PEDESTAL POLE & BASE	08682502	WACM-P	233
WALL MOUNT	08682602	WACM-W	91

What to know when ordering TPI Air Circulators:

- 1) **What is the operating voltage and phase?**
 - a. 120V (most common)
 - b. 120V or 240V
 - c. 277V
 - d. 240 or 480V (offered in 3-phase)
- 2) **How will you be mounting or operating this unit?**
 - a. Wall / Vertical Surface (Most Common)
 - b. Floor – Pedestal Mount
 - c. Pole Mount
 - d. Ceiling
 - e. Suspension Mount
 - f. I-Beam Mount
- 3) **What environment will this unit be operating in?**
 - a. Industrial – see TPI Series: HDH, IHP or ACH's
 - i. Dirty, dusty jobsites or harsh industrial environment
 - ii. Wet, high moisture, or wash down rated environment
 - iii. Hazardous Location – Class I Group D, Class II Groups F & G
 - b. Commercial – see TPI Series; CACU's
 - i. Clean areas or non-dusty environment
- 4) **Will you need the fan head to rotate?**
 - a. Oscillating
 - b. Non-Oscillating Fan Heads
- 5) **Do you want to order assembled fan heads?**
 - a. Assembled Fan Head
 - b. Unassembled Fan Head (ACU, UHP & CACU Series)
- 6) **Do you have a color preference?**
 - a. Safety Yellow – HDH Series
 - b. Industrial Textured Gray Finish (Most popular)
 - c. Black Semi-Gloss Powder Coated Finish (CACU-Series)

Air Circulators - Motor Comparisons

Commercial Motors - Open Vent Motors



Ideal for schools and office areas - clean and non-dusty environments



- Offered in 1/4 HP & 1/3 HP
- Good output
- Open ventilated (air goes through the motor)
- Oscillating and Non-Oscillating
- Unassembled fan heads only
- 1-year limited warranty
- Ideal for Commercial Applications
 - Offered in 120V models

Commercial Fan Applications



Garage Areas

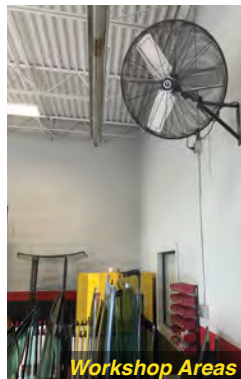

Workshop Areas

Industrial Motors -Totally Enclosed Motors (TEAO)



Ideal for dirty and harsh industrial applications. Specific models rated for even washdown and hazardous environments!



- Offered in 1/4 HP, 1/3 HP & 1/2 HP
- Higher quality and high CFP output
- Totally Enclosed Air Over (TEAO)
- Oscillating and Non-Oscillating
- Fully assembled fan heads
- No tools required to open grill assembly (retainer clips)
- 3-year warranty on 1/3 HP motors (5-year on 1/2 HP)
- Ideal for Commercial Applications
 - Offered in 120, 240, 277 & 480V models
 - Washdown and Hazardous Location Rated models

Industrial Fan Applications



Factory Areas



Workstation Areas

TPI Commercial Circulators



These circulators should be used in clean and dry commercial applications - such as schools, shops, offices or warehouses.

Commercial Circulator

Motor, blades, guards, and mount are packed and shipped in a single UPS-able carton.

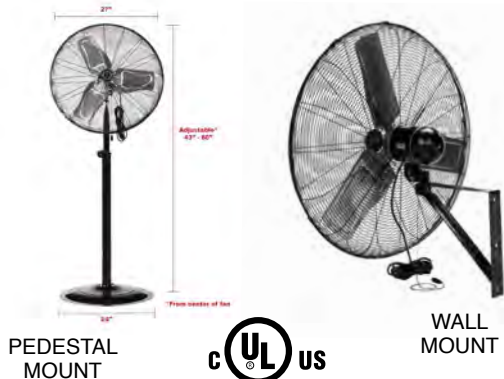

Features

- Black semi-gloss powder coated finish
- Pull chain switch
- SJT type 3 conductor, 9' long cord
- Coated steel guards with retaining clips
- Steel hub/spider aluminum paddle blades
- Pole adjusts center of fan from 43" to 60"
- Meets OSHA standards / 1-Year limited warranty
- Imported to TPI specifications

Motor Specifications

- 1-Phase
- 1/4 HP, 1/3 HP on HD Models
- Ball bearing
- Open ventilated
- 120V
- 3-Speed
- Permanently lubricated
- Permanent split capacitor

WARNING: This product can expose you to chemicals including nickel which is known to the State of California to cause cancer, and chromium, which is known to the State of California to cause birth defects and/or reproductive harm. For more information go to www.P65Warnings.ca.gov.

Standard Non-Oscillating Models

MFG CATALOG NUMBER	MFG MODEL NUMBER	SIZE	HP	TYPE	MOUNT TYPE	CFM*			VELOCITY PROFILE	AMPS (HIGH)	WT. (LBS)	LIST
						HIGH	MED	LOW	CFM / Area Sq Ft			
08778002	CACU 20-P	20"	1/10	Non - Oscillating	Pedestal Mount	1780	1600	1420	3300 / 125	1.4	52	310
08778102	CACU 20-W				Wall Mount						48	280
08706202	CACU 24-P	24"	1/4		Pedestal Mount	3400	3100	2800	5400 / 220	2.3	63	457
08706402	CACU 24-W				Wall Mount						43	391
08697402	CACU 30-P	30"	1/4		Pedestal Mount	4200	3800	3500	6700 / 240	2.4	66	504
08706302	CACU 30-W				Wall Mount						46	404
08761702	CACU 30-P-HD	30"	1/3		Pedestal Mount	5000	4600	4200	7000 / 250	3.60	56	586

*Measured 2 feet from face of fan

Note: Stocked models may differ in appearance from photograph

TPI Commercial Oscillating Fans

Standard Oscillating Models



MFG CATALOG NUMBER	MFG MODEL NUMBER	SIZE	HP	TYPE	MOUNT TYPE	CFM*			VELOCITY PROFILE	AMPS			WT. (LBS)	LIST
						HIGH	MED	LOW	CFM / Area Sq Ft	HIGH	MED	LOW		
08748902	CACU 24-PO	24"	1/4	Oscillating	Pedestal Mount	3200	3000	2800	5100 / 230	1.45	1.15	1.1	68	539
08749102	CACU 24-WO				Wall Mount								48	461
08749002	CACU 30-PO	30"	1/4		Pedestal Mount	4200	3800	3500	6700 / 250	2.0	1.8	1.6	70	566
08749202	CACU 30-WO				Wall Mount								51	501
08761802	CACU 30-PO-HD	30"	1/3		Pedestal Mount	5000	4600	4200	7000 / 250	3.60	3.02	2.94	64	725

Notes:

*Measured 2 feet from face of fan

Stocked models may differ in appearance from photograph - sizes are nominal
Units imported to TPI specifications.

WARNING: This product can expose you to chemicals including nickel which is known to the State of California to cause cancer, and chromium, which is known to the State of California to cause birth defects and/or reproductive harm. For more information go to www.P65Warnings.ca.gov.



36", 42", & 48" TPI Commercial Belt Drive Portable Blowers



⚠ WARNING: This product can expose you to chemicals including nickel which is known to the State of California to cause cancer, and chromium, which is known to the State of California to cause birth defects and/or reproductive harm. For more information go to www.P65Warnings.ca.gov.



Features

- Rotary switch
- SJT type cord - 3 conductor - 8' long
- Aluminum 4-paddle blade
- Spiral wire front and rear guards
- Black powder coated 20 gauge steel housing
- Stationary non-swivel housing
- 5" rubber wheels
- Meets OSHA standards / 1 Year limited warranty
- Imported to TPI specifications

Motor Specification

- 2-Speed
- 120V
- Ball bearing
- 1-Phase
- ODP type
- Permanently lubricated

MFG CATALOG NUMBER	MFG MODEL NUMBER	MOTOR HP	CFM*		VELOCITY PROFILE	MAX AMPS	WT. (LBS)	LIST
			HIGH	LOW	CFM / Area Sq Ft			
08734702	CPB 36-B	1/3	5,400	4,600	8600 / 300	4.8	82	713
08706602	CPB 42-B	1/2	7,600	6,700	12000 / 320	6.5	93	852
08722702	CPB 48-B	3/4	8,800	7,700	14000 / 500	9.0	129	1037

*Measured 2 feet from face of fan

Note: Photograph is a representation of stocked models. Actual model may vary in appearance

24", 30", & 36" TPI Commercial Direct Drive Portable Blowers



CPB 36-D



CPBS 30-D



Features

- Rotary or rocker switch
- SJT type cord - 3 conductor
- Spiral wire front and rear guards
- Black powder coated 20 gauge steel housing
- 5" rubber wheels
- Meets OSHA standards
- 1 Year limited warranty
- Imported to TPI specifications

Motor Specification

- 2-Speed
- 120 Volt
- Ball bearing
- 1-Phase
- Open ventilated
- Permanently lubricated

⚠ WARNING: This product can expose you to chemicals including nickel which is known to the State of California to cause cancer, and chromium, which is known to the State of California to cause birth defects and/or reproductive harm. For more information go to www.P65Warnings.ca.gov.

Standard Models

MFG CATALOG NUMBER	MFG MODEL NUMBER	BASE TYPE	MOTOR HP	CFM*		VELOCITY PROFILE	MAX AMPS	CORD LENGTH	SWITCH	BLADES	WT. (LBS)	LIST
				HIGH	LOW	CFM / Area Sq Ft						
08753502	CPB 30-D	Floor	1/5	4,400	3,800	6700 / 250	3.6	6'	Rocker	Aluminum	52	436
08710302	CPBS 30-D	Swivel	1/5	4,400	3,800	6700 / 250	3.6	6'	Rocker	Aluminum	60	470
08722602	CPB 36-D	Floor	1/3	5,400	4,600	8500 / 300	3.6	10'	Rotary	Steel	70	569
08770102	CPBS 24-DHV	Swivel	1/6	3,400	2,900	5400 / 240	2.4	9'	Rotary	Aluminum	38	268

*Measured 2 feet from face of fan

Note: Photograph is a representation of stocked models. Actual model may vary slightly in appearance

30", 36", & 42" TPI Industrial Direct Drive Portable Blowers



STANDARD MODEL



SWIVEL MODEL



WARNING: This product can expose you to chemicals including nickel which is known to the State of California to cause cancer, and chromium, which is known to the State of California to cause birth defects and/or reproductive harm. For more information go to www.P65Warnings.ca.gov.

Features

- Comes in sizes 30", 36", & 42"
- Rocker switch
- SJT type 3 conductor, 12' long cord
- Aluminum, 3 paddle blade
- Spiral, wire front and rear guards
- Corrosion and dent proof high density polyethylene housing
- 36" & 42" swivel model rotates 130° in 12 1/2° increments and locks in place with a steel locking pin
- Meets OSHA standards
- 1 Year limited warranty
- Made in U.S.A.

Motor Specifications

- 120V, 1-Phase
- 36"-1/3HP 42"-1/2HP
- Ball bearing
- Permanent split capacitor
- 2-Speed on 30" model
- 1-Speed on 42" model
- Permanently lubricated
- Totally enclosed

Standard Models

MFG CATALOG NUMBER	MFG MODEL NUMBER	FAN		WHEEL SIZE	MOTOR HP	CFM* / RPM		VELOCITY PROFILE	AMPS (HIGH)	WT. (LBS.)	LIST
		SIZE	TYPE			HIGH	LOW	CFM / Area Sq Ft			
08211002	PBX 30-D	30"	STANDARD	8"	1/4	4400 / 1100	3800 / 950	7200 / 250	2.5	65	738
08213602	PBSX 30-D	30"	SWIVEL	10"						70	1010
08211102	PBX 36-D	36"	STANDARD	8"	1/3	6500 / 1040	5400 / 950	11500 / 320	5.5	82	827
08213702	PBSX 36-D	36"	SWIVEL	10"						110	1269
08211202	PBX 42-D	42"	STANDARD	10"	1/2	9,000 / 825		15000 / 340	6.0	102	1077
08213802	PBSX 42-D	42"	SWIVEL	10"						128	1609

*Measured 2 feet from face of fan

Note: Photograph is a representation of stocked models. Actual model may vary slightly in appearance

48" TPI Industrial Direct Drive Portable Blowers



WARNING: This product can expose you to chemicals including nickel which is known to the State of California to cause cancer, and chromium, which is known to the State of California to cause birth defects and/or reproductive harm. For more information go to www.P65Warnings.ca.gov.

Features

- Corrosion and dent proof high density polyethylene housing
- Rocker switch
- SJT type 3 conductor, 12' long cord
- Steel, 2 paddle blade
- Spiral, wire front and rear guards
- 10" wheels
- Swivel model rotates 130° in 12 1/2° increments and locks in place with a steel locking pin
- Meets OSHA standards
- 1 Year limited warranty
- Made in U.S.A.

Motor Specifications

- 1-Phase
- 3/4 HP
- Ball bearing
- Permanent split capacitor
- 120V
- 1-Speed
- Permanently lubricated
- Totally enclosed

Features

MFG CATALOG NUMBER	MFG MODEL NUMBER	SIZE	FAN TYPE	MOTOR HP	CFM* / RPM	VELOCITY PROFILE	AMPS (HIGH)	DIMENSIONS			WT. (LBS)	LIST
						CFM / Area Sq Ft		"H"	"D"	"W"		
07997802	PB 48-D-OP	48"	STANDARD	3/4	11,800 / 825	14000 / 360	10.3	58.5	29	55.5	117	1892
07998002	PBS 48-D-OP	48"	SWIVEL	3/4	11,800 / 825	14000 / 360	10.3	----	----	----	142	2160

*Measured 2 feet from face of fan

Note: Photograph is a representation of stocked models. Actual model may vary slightly in appearance

36", 42", & 48" TPI Industrial Belt Drive Portable Blowers

Features



STANDARD MODEL



CORD WRAP INCLUDED WITH STANDARD MODEL

⚠ WARNING: This product can expose you to chemicals including nickel which is known to the State of California to cause cancer, and chromium, which is known to the State of California to cause birth defects and/or reproductive harm. For more information go to www.P65Warnings.ca.gov.



SWIVEL MODEL



- Comes in sizes 36", 42", and 48"
- Rocker switch on 120V, Single Phase models
- SJT type 3 conductor, 12' long cord on 120V, Single Phase models / no cord on dual voltage models
- 4 paddle blade: 36" PBX / PBSX & HL have aluminum blade; 42" & 48" PBX / PBSX have steel blade
- Spiral, wire front and rear guards
- Corrosion and dent proof high density polyethylene housing
- 8" wheels (36" model), 10" wheels (42" & 48" models)
- Swivel model rotates 130° in 12 1/2° increments and locks in place with a steel locking pin
- External junction boxes on dual voltage models allow units to be wired for either voltage without removing guards
- Hazardous location models have explosion proof motors, metal housings, and external junction boxes rated for Class I, Group D and Class II, Groups E, F, & G
- Meets OSHA standards
- 1 year limited warranty
- Made in U.S.A.

Motor Specifications

- 1-Speed
- Ball bearing
- Permanently lubricated

Standard Models

MOTOR LISTING	SIZE	MOTOR				CFM**	VELOCITY PROFILE	STANDARD MODEL				SWIVEL MODEL			
		TYPE	HP	RPM	AMPS		CFM / Area Sq Ft	MFG CATALOG NUMBER	MFG MODEL NUMBER	WT. (LBS)	LIST	MFG CATALOG NUMBER	MFG MODEL NUMBER	WT. (LBS)	LIST
	36"	120 V 1 PH ODP	1/2	500	8.0	6,900	14000 / 360	08211402	PBX 36-B	120	1072	08213302	PBSX 36-B	145	1633
	42"		3/4	430	11.0	10,600	17500 / 420	08211502	PBX 42-B	135	1285	08213402	PBSX 42-B	160	1877
	48"		1	390	15.0	14,400	23500 / 550	08211602	PBX 48-B	155	1420	08213502	PBSX 48-B	180	2116
	36"	240/480 V 3 PH ODP	1/2	500	2.3 / 1.1	6,900	14000 / 360	08508602	PB 36-B-3	127	1869	08509202	PBS 36-B-3	152	2203
	42"		3/4	430	3.3 / 1.5	10,600	17500 / 420	08508702	PB 42-B-3	143	2096	08509302	PBS 42-B-3	168	2613
	48"		1	390	3.4 / 1.7	14,400	23500 / 550	08508802	PB 48-B-3	164	2385	08509402	PBS 48-B-3	189	2750
---	36"	120/240 V 1 PH EXP	1/2	500	7.8 / 3.9	6,900	14000 / 360	08508902	PB 36-B-HL*	135	2817	08509502	PBS 36-B-HL	160	3109
	42"		3/4	430	10.8 / 5.4	10,600	17500 / 420	08509002	PB 42-B-HL*	150	2964	08509602	PBS 42-B-HL	175	3543
	48"		1	390	13.2 / 6.6	14,400	23500 / 550	08509102	PB 48-B-HL*	173	3477	08509702	PBS 48-B-HL	198	3835

**Measured 2 feet from face of fan *Models have no listing.
 Note: Products listed in this section are custom built and subject to 100% cancellation/restocking charges.
 Note: Photograph is a representation of stocked models. Actual model may vary slightly in appearance.

TPI Industrial Direct Drive Suspension Blowers



Features

- On-Off rocker switch
- SJT type 3 conductor, 12' long cord
- Aluminum blade
- Powder coated spiral wire front and rear guards
- Corrosion and dent proof high density polyethylene housing
- Meets OSHA standards
- 1 year limited warranty
- Mounting chain not included
- Made in U.S.A.

Motor Specifications

- 120V, 1-Phase
- Ball bearing
- Permanent split capacitor
- 2-Speed on 30" & 36" model
- 1-Speed on 42" model
- Permanently lubricated



WARNING: This product can expose you to chemicals including nickel which is known to the State of California to cause cancer, and chromium, which is known to the State of California to cause birth defects and/or reproductive harm. For more information go to www.P65Warnings.ca.gov.

Standard Models

SIZE	MOTOR HP	MFG CATALOG NUMBER	MFG MODEL NUMBER	CFM*		VELOCITY PROFILE	RPM HIGH	AMPS HIGH	WT. (LBS)	LIST
				HIGH	LOW	CFM / Area Sq Ft				
30"	1/4	08213002	SBX 30-D	4,400	3,800	7200 / 250	1050	2.5	58	805
36"	1/3	08213102	SBX 36-D	6,500	5,400	11500 / 320	1050	5.6	70	932
42"	1/2	08213202	SBX 42-D	9,000		15000 / 340	825	7.9	99	1313

*Measured 2 feet from face of fan

TPI Industrial Belt Drive Suspension Blowers



Features

- On-Off rocker switch on 120V, 1-Phase models
- SJT type 3 conductor, 12' long cord on 120V, 1 phase models
- No cord on dual voltage models
- Aluminum blade: SBX 36-B, SB 36-B-HL, SB 42-B-HL, SB 48-B-HL
- Steel blade: SBX 42-B, SBX 48-B
- Corrosion and dent proof high density polyethylene housing
- Powder coated spiral wire front and rear guards
- Meets OSHA standards
- 1 year limited warranty
- Mounting chain not included
- Made in U.S.A.

Motor Specifications

- 120V, 1-Phase
- Ball bearing
- Permanent split capacitor
- 2-Speed on 30" & 36" model
- 1-Speed on 42" model
- Permanently lubricated

External junction boxes on dual voltage models allow units to be wired for either voltage without removing guards.

Hazardous Location models have explosion proof motors and external junction boxes rated for Class I, Group D, & Class II, Groups E, F & G., (Metal housing and no switch)

Standard Models

MFG CATALOG NUMBER	MFG MODEL NUMBER	SIZE	MOTOR		CFM**	VELOCITY PROFILE	RPM	AMPS	WT. (LBS)	LIST
			TYPE	HP		CFM / Area Sq Ft				
08212702	SBX 36-B	36"	115 V, 1 PH, ODP	1/2	6,900	14000 / 360	500	8	120	1336
08212802	SBX 42-B	42"		3/4	10,600	17500 / 420	430	11	135	1521
08212902	SBX 48-B	48"		1	14,400	23500 / 550	390	15	155	1709
08509802	SB 36-B-3	36"	230 / 460 V, 3 PH, ODP	1/2	6,900	14000 / 360	500	2.3 / 1.1	127	1782
08509902	SB 42-B-3	42"		3/4	10,600	17500 / 420	430	3.3 / 1.5	143	2157
08510002	SB 48-B-3	48"		1	14,400	23500 / 550	390	3.8 / 1.9	164	2269
08510102	SB 36-B-HL*	36"	115 / 230 V, 1 PH, EXP	1/2	6,900	14000 / 360	500	7.8 / 3.9	135	2817
08510202	SB 42-B-HL*	42"		3/4	10,600	17500 / 420	430	10.8 / 5.4	150	3203
08510302	SB 48-B-HL*	48"		1	14,400	23500 / 550	390	13.2 / 6.6	173	3477

Note: Products listed in this section are custom built and subject to 100% cancellation/restocking charges.
 Note: Photograph is a representation of stocked models. Actual model may vary slightly in appearance.

*Models have no listing.
 **Measured 2 feet from face of fan

TPI Industrial Mini-Blowers



FLOOR MODEL



YOKE MOUNTED MODEL



MBM-W
(Optional Wall/
Ceiling Mount)



WARNING: This product can expose you to chemicals including nickel which is known to the State of California to cause cancer, and chromium, which is known to the State of California to cause birth defects and/or reproductive harm. For more information go to www.P65Warnings.ca.gov.

- ** USE IN DIRTY OR DUSTY ENVIRONMENTS
- ** FLOOR MODEL OR YOKE MOUNT AVAILABLE.
- ** BOLT TO ANY SURFACE OR USE WITH OPTIONAL WALL/CEILING MOUNT.

Features

- Floor models have rotary switch
- Yoke mounted models have pull chain switch
- SJT type 3 conductor, 10' long cord
- Aluminum blade
- Spiral, wire front and rear guards
- Corrosion and dent proof high density polyethylene housing
- Meets OSHA standards
- 1 year limited warranty
- Made in U.S.A. with domestic and foreign components

Motor Specifications

- 1-Phase
- 1/4 HP
- Ball bearing
- Totally enclosed
- 120V
- 2-Speed
- Permanently lubricated
- Permanent split capacitor

Standard Models

MFG CATALOG NUMBER	MFG MODEL NUMBER	FAN		CFM* / RPM		VELOCITY PROFILE CFM / Area Sq Ft	DIMENSIONS			AMPS (High)	WT. (LBS)	LIST
		TYPE	SIZE	HIGH	LOW		"H"	"W"	"D"			
08743502	MB 24-DF	FLOOR STYLE	24"	3300 / 1140	2900 / 1070	5200 / 240	29 1/2"	28 1/2"	14 1/4"	2.2	52	805
08743602	MB 24-DY	YOKE STYLE					29"	28 1/2"	14 1/4"			
08743702	MB 30-DF	FLOOR STYLE	30"	4400 / 1040	3900 / 730	7000 / 250	38 1/2"	37 1/2"	14 1/2"	2.5	58	889
08743802	MB 30-DY	YOKE STYLE					38"	37 1/2"	14 1/2"			
07989002	MBM-W	OPTIONAL WALL/CEILING MOUNT FOR YOKE STYLE MINI-BLOWER									4	163

*Measured 2 feet from face of fan

TPI Industrial Heavy Duty Square Belt Drive Portable Blowers



4" CASTERS



WARNING: This product can expose you to chemicals including nickel which is known to the State of California to cause cancer, and chromium, which is known to the State of California to cause birth defects and/or reproductive harm. For more information go to www.P65Warnings.ca.gov.

Features

- On-Off rocker switch
- SJT type 3 conductor, 12' long cord
- Steel blade
- Permanently lubricated bearings on blade drive shaft
- Powder coated front and rear guards
- Powder coated 20 gauge venturi
- 18 gauge galvanized steel housing
- Meets OSHA standards / 1 Year limited warranty
- Made in U.S.A.

Motor Specifications

- 1-Phase
- Ball bearing
- Drip proof motor
- 120V
- 1-Speed
- Permanently lubricated
- 1/2" Shaft

Standard Models

SIZE	MFG CATALOG NUMBER	MFG MODEL NUMBER	MOTOR			CFM*	VELOCITY PROFILE CFM / Area Sq Ft	DIMENSIONS			WT. (LBS)	LIST
			HP	RPM	AMPS			"H"	"W"	"D"		
36"	08683602	PCBT 36-B	1/2	1725	8.0	6,900	14,000 / 360	48 1/4"	40.38"	22 1/2"	120	2054
42"	08683702	PCBT 42-B	3/4		11.0	10,600	17,500 / 420	56 1/2"	48.38"	22 1/2"	140	2669
48"	08683802	PCBT 48-B	1		15.0	14,400	23,500 / 550	62 1/2"	54.38"	18 1/2"	185	3245

*Measured 2 feet from face of fan



Features

- ETL C/US listed for indoor spot cooling applications
- 20-gauge all steel construction housing with gray epoxy powder coated finish
- Heavy-duty yoke mounting bracket design with 2" square steel tubing frame
- Direct drive Totally Enclosed Air-Over (TEAO) motor generating up to 9,000-CFM's
- Single speed, ball bearing, with split capacitor, permanently lubricated, TEAO motor operates on 60HZ and 1725-RPMs, and requires hard-wired connection to the supplied electrical enclosure located on the motor housing
- Aluminum 3-paddle blade system with steel hub and cast aluminum spider connections
- Non-Oscillating fan heads offered 18", 24" & 30" diameter sizes
- 2-year motor warranty

Benefits

- Housing designed for all types of air circulating applications to provide directional – high velocity air flow.
- Built-in rotating design allows the supplied mounting bracket to pivot 120° in (9) adjustment settings at 15° variations.
- Front & rear spiral wound grills are OSHA approved and have a black powder coated finish.
- All units are shipped fully assembled and ready for hard-wired connections
- TEAO motor has a Class B rating, with automatic thermal protection and ball bearing design for harsh environments; rated up to 115°F max. ambient temperature.
- Single and three phase options available in 120, 277 & 480-Volt.

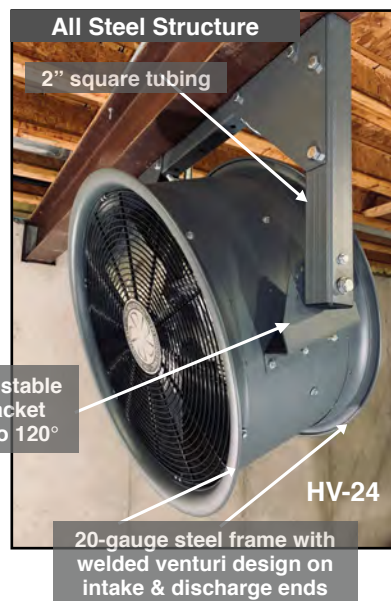

Specifications

- 1-Speed
- 1 Phase, 120V, 208/240V, 277V or 480V
- 3-Phase, 480V
- Ball bearing
- Totally enclosed, air over
- Permanent split capacitor/lubricate
- 1/2" Motor Shaft

Applications

Units are ideal for warehouse, material handling, and high-shelf areas for directing high volumes of air flow down aisles, loading dock areas, conveyor systems, processing centers, workstations, jobsite, and all types of industrial operations for rugged environments.

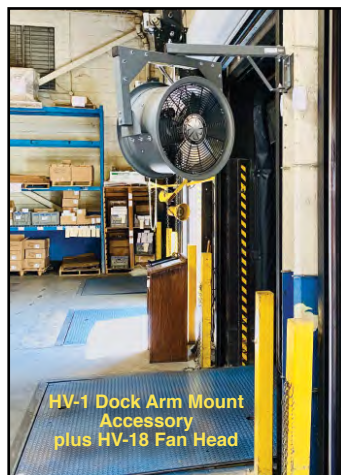

HV-30



HV-1

HV-3 Wall/Column Mount Accessory plus HV-30 Fan Head



TPI Industrial High Velocity Blowers

Standard Models

SIZE	MFG CATALOG NUMBER	MFG MODEL NUMBER	VOLTS	PH	AMPS (High)	HP	WATTS	RPM	CFM*	VELOCITY PROFILE CFM/Area Sq. Ft.	BLADE DIA.	DIMENSIONS (in.)			WT. (lbs.)	LIST
												L	W	H		
18"	08195602	HV-18-120V	120	1	3.4	1/2	373	1725	3000	5000 / 175	16"	13.5	27.4	26	45	1260
	08195702	HV-18-208/240V	208/240	1	1.9											
	08195802	HV-18-277V	277	1	1.5											
	08195902	HV-18-480V	480	1	1.0											
	08197202	HV-18-480V-3	208-230/460	3	1.4 / 0.8											
24"	08196002	HV-24-120V	120	1	3.8	1/2	373	1725	5290	8500 / 275	22"	13.5	33.3	31.4	58	1444
	08196102	HV-24-208/240V	208/240	1	2.1											
	08196202	HV-24-277V	277	1	1.7											
	08196302	HV-24-480V	480	1	1.1											
	08197302	HV-24-480V-3	208-230/460	3	1.5 / 0.8											
30"	08196402	HV-30-120V	120	1	7.6	1	746	1700	9000	14250 / 375	28"	16	38.9	39	85	2087
	08196502	HV-30-208/240V	208/240	1	4.3											
	08196602	HV-30-277V	277	1	3.2											
	08196702	HV-30-480V	480	1	1.6											
	08197402	HV-30-480V-3	208-230/460	3	3.4 / 1.6											

*Measured 2' from face of fan; Velocity is the highest recorded CFM

Dimensions:

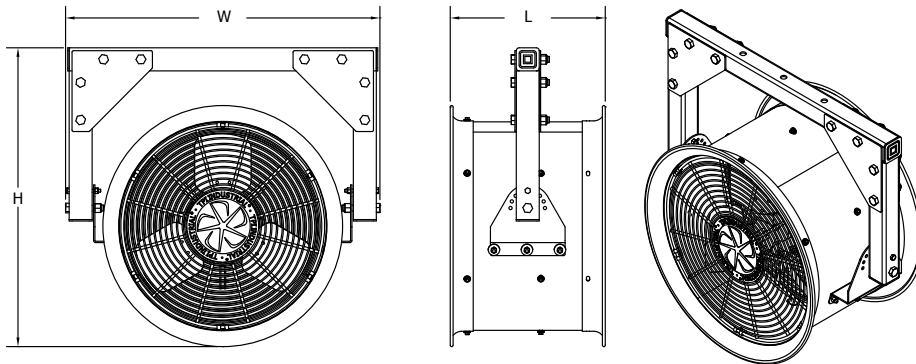

Dock Swing Arm - 24" Reach



Wall/Column Mount

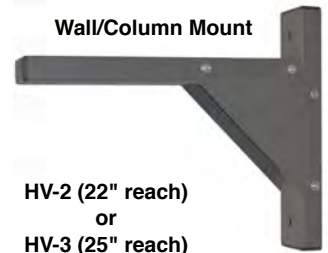

Accessory Models

MFG CATALOG NUMBER	MFG MODEL NUMBER	TYPE	FITS MODEL SERIES	LIST
08197502	HV-1	Dock Arm, 24" Reach	HV-18	184
08197602	HV-2	Wall / Column Mount	HV-18 & HV-24	263
08197702	HV-3	Wall / Column Mount	ALL	273
08199002	HV-4-18	Low Stand	HV-18	571
08199102	HV-4-24		HV-24	631
08199202	HV-4-30		HV-30	690
08199302	HV-5-18	Medium Stand	HV-18	888
08199402	HV-5-24		HV-24	977
08199502	HV-5-30		HV-30	1121
08199602	HV-6-18	High Stand	HV-18	1033
08199702	HV-6-24		HV-24	1174
08199802	HV-6-30		HV-30	1314
08199902	HV-7-DC-1	Disconnect Switch	1-Phase	604
08200002	HV-7-DC-3		3-Phase	630
08209802	HV-8	Caster Kit (Qty.4)	ALL Heads/Stands	195



Image Shown Includes

- HV-24 (Fan Head)
- HV-5-24 (Medium Stand)
- HV-8 (Caster Kit)

Note: All items must be ordered separately.

Note: Stands DO NOT include casters

Contact TPI customer Service for additional cost for mounting fan to the stand and wiring the disconnect prior to shipping.

TPI Industrial Heavy Duty Direct Drive Blowers

WARNING: This product can expose you to chemicals including nickel which is known to the State of California to cause cancer, and chromium, which is known to the State of California to cause birth defects and/or reproductive harm. For more information go to www.P65Warnings.ca.gov.



LOW STAND



MEDIUM STAND



HIGH STAND

Features

- Totally enclosed and explosion proof motors
- Explosion proof motors are Class 1, Div 1, Group D and Class 2, Div 1, Groups F & G
- Cast Aluminum props
- 14 gauge steel body and stand
- Acid resistant coating available
- Baked enamel coating
- 360° Swivel on high and medium stand units
- Meets federal OSHA requirements
- 1 year limited warranty

NOTE:

Single phase motors are field convertible 115V / 230V
 Three phase motors are field convertible 230V / 460V
 Motors are set to lower voltage at the factory unless a request is made at time of order to set to the higher voltage

Standard Models

SIZE	MFG MODEL NUMBER	HP	RPM	CFM	DB's @ 10'	WT. (LBS)			LIST											
						STAND			TEC		EXP		TEC		EXP		TEC		EXP	
						LOW	MED	HIGH	1PH	3PH	1PH	3PH	1PH	3PH	1PH	3PH	1PH	3PH	1PH	3PH
MODEL NUMBER SUFFIXES									-L	-L-3	-L	-L-3	-M	-M-3	-M	-M-3	-H	-H-3	-H	-H-3
18"	MCD18-1/4	1/4	1725	3050	74	103	145	210	3351	3336	3857	3939	4131	4116	4628	4722	4507	4493	5017	10151
	MCD18-1/3	1/3	1725	3450	76	105	150	215	3465	3493	4123	4293	4242	4267	4900	5079	4622	4645	5286	9567
	MCD18-1	1	1725	4600	77	117	165	230	3909	3765	4636	4722	4696	4542	5408	5502	5072	4922	5793	5880
24"	MCD24-1/4	1/4	1725	5200	80	115	165	230	3429	3417	3924	4020	4308	4302	4801	4900	4615	4408	5108	5206
	MCD24-1/3	1/3	1140	5300	74	126	175	250	3978	4020	5058	5116	4856	4900	5935	5996	5164	5010	6243	6300
	MCD24-1/2	1/2	1725	6000	80	120	170	240	3716	3730	4489	4408	4594	4610	5364	5286	4900	4722	5671	5593
	MCD24-3/4	3/4	1140	6900	74	140	190	260	4744	4293	5378	5231	5623	5179	6259	6109	5928	5286	6565	6414
	MCD24-1	1	1725	7400	82	130	180	250	4031	3886	4749	4835	4909	4765	5628	5714	5215	4872	5935	6021
	MCD24-1 1/2	1.5	1725	8200	84	137	190	255	4259	4073	6294	5173	5137	4957	7172	6050	5444	5065	7479	6356
	MCD24-3	3	1725	10500	87	160	210	270	----	4446	----	5623	----	5322	----	6508	----	5437	----	6807
30"	MCD30-1/3	1/3	1140	6900	80	150	205	260	4365	4408	5444	5502	5329	5372	6409	6472	5714	5757	6786	6851
	MCD30-1/2	1/2	1725	8900	86	141	195	250	4107	4123	4879	4801	5079	5093	5849	5774	5460	5472	6228	6150
	MCD30-3/4	3/4	1140	10400	80	210	260	320	5024	4580	5651	5507	5985	5544	6622	6477	6366	5922	6999	6859
	MCD30-1	1	1140	11200	81	200	260	310	6021	4830	7181	5714	6993	5799	8150	6678	7370	6178	8528	7057
	MCD30-1 1/2	1.5	1725	12000	92	200	250	310	4636	4451	6672	5551	5600	5424	7644	6522	5978	5799	8021	6901
	MCD30-2	2	1140	14000	84	225	270	330	----	5164	----	6429	----	6135	----	7400	----	6514	----	7779
	MCD30-3	3	1725	16000	94	220	265	325	----	4728	----	5908	----	5700	----	6878	----	6082	----	7251
36"	MCD36-1	1	1140	13000	82	250	320	375	6800	5608	7958	6487	7994	6807	9156	7688	8245	7051	9400	7930
	MCD36-1 1/2	1.5	1725	14850	88	250	320	375	5378	5194	7413	6294	6573	6386	8607	7487	6821	6633	8858	7737
	MCD36-2	2	1140	17500	82	255	325	380	----	5737	----	7007	----	6936	----	8201	----	7181	----	8450
	MCD36-3	3	1725	18500	90	260	330	390	----	5480	----	6657	----	6672	----	7856	----	6921	----	8100
	MCD36-5	5	1725	23000	94	260	330	390	----	5573	----	6865	----	6764	----	8057	----	7007	----	8300
42"	MCD42-2	2	1140	19500	85	315	415	565	----	6587	----	7856	----	7856	----	9122	----	8358	----	9629
	MCD42-5	5	1725	27000	98	320	420	570	----	6414	----	7714	----	7688	----	8978	----	8193	----	9493
48"	MCD48-5	5	1140	32000	92	500	620	710	----	8701	----	10835	----	10100	----	12235	----	10990	----	13127
	MCD48-7 1/2	7.5	1140	37000	105	625	745	835	----	10100	----	13635	----	11502	----	15035	----	12392	----	15921
	MCD48-10	10	1140	41000	105	682	800	890	----	11820	----	14971	----	13220	----	16362	----	14108	----	17256
60"	MCD60-3	3	690	35000	87	690	855	965	----	18543	----	----	----	21184	----	----	----	21790	----	----
	MCD60-5	5	690	45000	87	730	895	1005	----	20854	----	----	----	23489	----	----	----	24104	----	----
	MCD60-7 1/2	7.5	870	47000	90	945	1110	1220	----	17477	----	----	----	20112	----	----	----	20720	----	----
	MCD60-10	10	870	57200	91	1035	1200	1310	----	21754	----	----	----	24390	----	----	----	25004	----	----
	MCD60-15	15	870	60750	92	1080	1245	1355	----	28453	----	----	----	31087	----	----	----	31701	----	----

Manual Starter Switches

MFG MODEL NUMBER		H.P. RATING	LIST PRICE	
1 PH	3 PH		TEC	
			1 PH	3 PH
SW-1/4	SW-1/4-3	1/4-1/3	647	1542
SW-1/2	SW-1/2-3	1/2-3/4	647	1542
SW-1	SW-1-3	1	647	1542
SW-1 1/2	SW-1 1/2-3	1.5	1516	1542
----	SW-2-3	2	----	1542
----	SW-3-3	3	----	1542
----	SW-5-3	5	----	1542
----	SW-7 1/2-3	7.5	----	1463

Polyolifin Casters

MFG MODEL NUMBER	FAN SIZE	WHEEL SIZE	WT. (LBS)	LIST
CAS - 18	18" - 30"	4"	10	620
CAS - 48	36" - 48"	5"	14	873

(FOR LOW & MEDIUM STAND)
 4 CASTERS - 2 LOCKING

Note: Products listed in this section are custom built and subject to 100% cancellation/restocking charges

TPI Industrial Heavy Duty Permanent Mount Direct Drive Blowers



1-WAY SWIVEL



2-WAY SWIVEL

⚠ WARNING: This product can expose you to chemicals including nickel which is known to the State of California to cause cancer, and chromium, which is known to the State of California to cause birth defects and/or reproductive harm. For more information go to www.P65Warnings.ca.gov.

Features

- Front and rear spiral guards
- Explosion proof motors are Class 1, Div 1, Group D and Class 2, Div 1, Groups F & G
- Cast aluminum props
- 14 gauge steel body and stand
- Meets federal OSHA requirements
- 1 year limited warranty

NOTE:

Single Phase motors are field convertible 115V / 230V
 Three Phase motors are field convertible 230V / 460V
 Motors are set to lower voltage at the factory unless a request is made at time of order to set to the higher voltage

Standard Models

BLADE SIZE	MFG MODEL NUMBER	HP	RPM	CFM	DB'S @ 10'	WT. (LBS)		LIST PRICE							
								1-WAY SWIVEL				2-WAY SWIVEL			
						TEC		EXP		TEC		EXP			
						1PH	3PH	1PH	3PH	1PH	3PH	1PH	3PH		
MODEL NUMBER SUFFIXES						-T	-T-3	-T	-T-3	-S	-S-3	-S	-S-3		
18"	MCD18-1/4	1/4	1725	3050	74	130	140	4446	4431	4942	5030	5578	5566	6087	6173
	MCD18-1/3	1/3	1725	3450	76	135	145	4559	4580	5216	5387	5694	5714	6356	6531
	MCD18-1	1	1725	4600	77	145	155	5000	4856	5723	5816	6143	5996	6865	6951
24"	MCD24-1/4	1/4	1725	5200	80	145	155	4580	4559	5072	5173	5774	5752	6259	6356
	MCD24-1/3	1/3	1140	5300	74	155	165	5129	5173	6209	6264	6314	6356	7394	7450
	MCD24-1/2	1/2	1725	6000	80	150	160	4866	4879	5636	5559	6050	6072	6821	6744
	MCD24-3/4	3/4	1140	6900	74	170	180	5893	5450	6531	6379	7080	6636	7714	7571
	MCD24-1	1	1725	7400	82	160	170	5179	5035	5902	5985	6366	6222	7086	7172
	MCD24-1 1/2	1.5	1725	8200	84	165	175	5400	5224	7442	6323	6592	6409	8628	7511
30"	MCD24-3	3	1725	10500	87	190	200	----	5593	----	6771	----	6779	----	7958
	MCD30-1/3	1/3	1140	6900	80	180	190	5559	5600	6636	6694	6873	6915	7943	8007
	MCD30-1/2	1/2	1725	8900	86	170	180	5300	5315	6082	5996	6617	6629	7387	7307
	MCD30-3/4	3/4	1140	10400	80	240	250	6216	5765	6851	6700	7523	7080	8159	8016
	MCD30-1	1	1140	11200	81	230	240	7215	6021	8379	6908	8528	7336	9686	8215
	MCD30-1 1/2	1.5	1725	12000	92	230	240	5830	5645	7866	6744	7143	6958	9177	8057
36"	MCD30-2	2	1140	14000	84	255	265	----	6356	----	7621	----	7672	----	8934
	MCD30-3	3	1725	16000	94	250	260	----	5922	----	7107	----	7228	----	8414
	MCD36-1	1	1140	13000	82	295	305	8287	7086	9444	7964	9913	8714	11071	9598
	MCD36-1 1/2	1.5	1725	14850	88	295	305	6851	6672	8895	7770	8540	8300	10520	9400
	MCD36-2	2	1140	17500	82	300	310	----	7215	----	8486	----	8852	----	10116
	MCD36-3	3	1725	18500	90	315	325	----	6958	----	8138	----	8585	----	9765
MCD36-5	5	1725	23000	94	305	315	----	7042	----	8343	----	8680	----	9971	

Exhaust Ventilation Guide

Minute air change chart for Commercial and Industrial Applications

$$\text{CFM Required for Ventilation} = \frac{\text{Building Cubic Feet}}{\text{Minutes Per Air Change}}$$

Place	Typical	Range
Assembly	(6)	2-10
Auditoriums	(6)	1-20
Bakeries	(2)	1-3
Banks	(6)	3-10
Bars	(4)	2-5
Barns	(15)	10-20
Boiler Rooms	(2)	1-3
Bowling Alley	(3)	1-5
Cafeteria	(4)	3-5
Churches	(6)	2-10
Classrooms	(6)	4-8
Compressor Rooms	(2)	1-3
Dance Halls	(6)	2-10
Dairies	(4)	2-5
Dormitories	(6)	4-8
Dry Cleaning Plant	(3)	1-5

Place	Typical	Range	Place	Typical	Range
Engine Rooms	(3)	1-5	Mills	(4)	2-5
Factories	(7)	4-10	Packing Houses	(4)	3-5
Foundries	(5)	2-8	Plants	(7)	4-10
Garages	(7)	4-10	Plating Plants	(4)	2-5
Generating Plants	(4)	2-5	Print Shops	(7)	4-10
Glass Plants	(2)	1-3	Restaurants	(6)	2-10
Gymnasiums	(6)	2-10	Rest Rooms	(7)	4-10
Hallways	(8)	4-12	Schools	(7)	4-10
Kitchens (Comm.)	(3)	1-5	Stores	(7)	4-10
Laboratories	(3)	1-5	Theaters	(6)	4-8
Libraries	(4)	2-5	Transformer Rooms	(3)	1-5
Laundries	(2)	1-3	Turbine Rooms	(4)	2-5
Locker Rooms	(6)	2-10	Waiting Rooms	(12)	10-15
Machine Shops	(4)	2-5	Warehouses	(7)	4-10
Markets	(6)	2-10	Welding Rooms	(3)	1-4

Note: Products listed in this section are custom built and subject to 100% cancellation/restocking charges

Industrial Workstation Floor Fans



WARNING: This product can expose you to chemicals including nickel which is known to the State of California to cause cancer, and chromium, which is known to the State of California to cause birth defects and/or reproductive harm. For more information go to www.P65Warnings.ca.gov.



Features

- Rotary switch
- Head tilts 360°
- Coated steel guards
- SJT type 3 conductor, 10' long cord
- Steel hub/spider aluminum paddle blades
- Meets OSHA standards
- 1 Year limited warranty
- Imported to TPI specifications.

Motor Specifications

- Sleeve bearing
- Totally enclosed
- 1-Phase, 120V
- 3-Speed
- Permanently lubricated
- Frame size: 42
- 5/16" Shaft

Standard Models

SIZE	MFG CATALOG NUMBER	MFG MODEL NUMBER	FAN TYPE	MOTOR HP	CFM** / RPM			VELOCITY PROFILE CFM / Area Sq Ft	DIMENSIONS			MAX AMPS	WT. (LBS)	LIST
					HIGH	MED	LOW		"H"	"W"	"D"			
12"	07986102	F-12-TE	FLOOR MODEL	1/12	900 / 1590	800 / 1380	700 / 1080	1400 / 50	15 1/4"	14 1/2"	9 1/2"	1.1	13	181
18"	07972902	F-18-TE		1/8	1800 / 1660	1500 / 1550	1300 / 1370	2900 / 125	20 1/2"	20 1/2"	10 1/2"	2.2	20	227
24"	08528502	F-24-TE		1/8	2100 / 1634	1900 / 1484	1600 / 1200	3500 / 150	26"	26"	10 1/2"	2.4	23	273
24"	08775402	F-24-TE-HV		1/4	3800 / 1100	3600 / 950	3400 / 800	6000 / 240	26"	26"	10 1/2"	2.7	25	310
18"	07973002	F-18H-TE*	HIGH STAND	1/8	1800 / 1660	1500 / 1550	1300 / 1370	2900 / 125	53"	25"	27"	2.2	27	342
24"	08540602	F-24H-TE*		1/8	2100 / 1634	1900 / 1484	1600 / 1200	3500 / 150	53"	30"	27"	2.4	30	382

**Measured 2 feet from face of fan

*Made in U.S.A. with domestic and foreign components.

Corrosion Resistant Industrial Workstation Fans



WARNING: This product can expose you to chemicals including nickel which is known to the State of California to cause cancer, and chromium, which is known to the State of California to cause birth defects and/or reproductive harm. For more information go to www.P65Warnings.ca.gov.

Features

- Pull chain switch
- Head tilts 360°
- FDA white coated steel guards
- SJTW type 3 conductor, 10' long cord
- Steel hub/spider aluminum paddle blades
- Corrosion resistant motor and switch
- Meets OSHA standards / 1 Year limited warranty
- Made in U.S.A. with domestic and foreign components



Motor Specifications

- Sleeve bearing
- Totally enclosed
- 1-Phase, 120V
- 3-Speed
- Permanently lubricated
- Frame size: 42
- 1/2" Shaft
- Sealed electrical enclosure

Standard Models

SIZE	MFG CATALOG NUMBER	MFG MODEL NUMBER	FAN TYPE	MOTOR HP	CFM* / RPM			VELOCITY PROFILE CFM / Area Sq Ft	DIMENSIONS			MAX AMPS	WT. (LBS)	LIST
					HIGH	MED	LOW		"H"	"W"	"D"			
18"	08763202	F-18-CR	FLOOR MODEL	1/8	1800 / 1660	1500 / 1550	1300 / 1370	2900 / 125	20 1/2"	20 1/2"	10 1/2"	2.2	20	476
24"	08763502	F-24-CR		1/8	2100 / 1634	1900 / 1484	1600 / 1200	3500 / 150	26"	26"	10 1/2"	2.4	23	543
18"	08763302	F-18H-CR	HIGH STAND	1/8	1800 / 1660	1500 / 1550	1300 / 1370	2900 / 125	53"	25"	27"	2.2	27	631
24"	08763602	F-24H-CR		1/8	2100 / 1634	1900 / 1484	1600 / 1200	3500 / 150	53"	30"	27"	2.4	30	680
18"	08763102	U-18-CR	WALL/CEILING MODEL	1/8	1800 / 1660	1500 / 1550	1300 / 1370	2900 / 125	21 1/2"	20 1/2"	10 1/2"	2.2	20	476
24"	08763402	U-24-CR		1/8	2100 / 1634	1900 / 1484	1600 / 1200	3500 / 150	27"	26"	10 1/2"	2.4	23	543

*Measured 2 feet from face of fan

Industrial Mounted Workstation Fans

Features



⚠ WARNING: This product can expose you to chemicals including nickel which is known to the State of California to cause cancer, and chromium, which is known to the State of California to cause birth defects and/or reproductive harm. For more information go to www.P65Warnings.ca.gov.

FAN SIZE	DIMENSIONS		
	"H"	"W"	"D"
12"	15 1/4"	14 1/2"	9 1/2"
18"	21 1/2"	20 1/2"	10 1/2"
24"	27"	26"	10 1/2"

- Pull chain switch
- Head rotates 360° vertically and horizontally
- Coated steel guards
- SJT type 3 conductor, 10' long cord
- Steel hub/spider aluminum paddle blades
- Meets OSHA standards / 1 Year limited warranty
- Imported to TPI specifications



Motor Specifications

- Sleeve bearing
- Totally enclosed, permanently lubricated
- Frame size: 42
- 3-Speed
- 1-Phase, 120V
- 5/16" (12" fan only) and 1/2" shaft

Standard Models

Pipe Mount Adaptor

FAN SIZE	MFG CATALOG NUMBER	MFG MODEL NUMBER	MOTOR HP	CFM* / RPM			VELOCITY PROFILE CFM / Area Sq Ft	MAX AMPS	WT. (LBS)	LIST	PIPE DIAMETER	MFG CATALOG NUMBER	MFG MODEL NUMBER	LIST
				HIGH	MED	LOW								
12"	07986002	U-12-TE	1/12	900 / 1590	800 / 1380	700 / 1080	1400 / 50	1.1	13	190	1"	08512402	PM-1	64
18"	07972802	U-18-TE	1/8	1800 / 1660	1500 / 1550	1300 / 1370	2900 / 125	2.2	20	234	1 1/2"	08512502	PM-1.5	70
											2"	08512602	PM-2	78
24"	08540702	U-24-TE	1/8	2100 / 1634	1900 / 1484	1600 / 1200	3500 / 150	2.4	23	263	2 1/2"	08512702	PM-2.5	84
											3"	08512802	PM-3	91
24"	08775502	U-24-TE-HV	1/4	3800 / 1100	3600 / 950	3400 / 800	6000 / 240	2.7	25	280				

*Measured 2 feet from face of fan **Note: Mount with one bolt or lag screw to walls, ceilings, work benches, machines or any surface.**

Outdoor Rated Yoke Mount Fans



⚠ WARNING: This product can expose you to chemicals including nickel which is known to the State of California to cause cancer, and chromium, which is known to the State of California to cause birth defects and/or reproductive harm. For more information go to www.P65Warnings.ca.gov.

Features

- Direct drive totally enclosed motor
- Pull chain switch
- Head rotates 360° vertically and horizontally
- Knobs allow for 180° vertical rotation
- Coated black finish steel guards
- Steel yoke mounting bracket
- All black finish with aiming handle
- SJT type 3 conductor, 10' long cord
- Steel hub/spider aluminum 3-paddle blades
- Meets OSHA standards / 1 Year limited warranty
- Imported to TPI specifications

Motor Specifications

- Sleeve bearing
- Totally enclosed, permanently lubricated
- Frame size: 42
- 3-Speed
- 1-Phase, 120V
- 1/2" shaft



Standard Models

FAN SIZE	MFG CATALOG NUMBER	MFG MODEL NUMBER	MOTOR HP	RPM	CFM			VELOCITY PROFILE CFM/Area Sq. Ft.	MAX AMPS	WT. (LBS)	LIST
					HIGH	MED	LOW				
18"	08194502	U-18-TE-HD	1/10	1625	1900	1500	1300	3100 / 125	1.1	20	270
24"	08211802	U-24-TE-HD	1/4	1625	3800	3600	3400	6000 / 240	2.4	28	290

*Measured 2 feet from face of fan

TPI Commercial Floor Fans



CF-20



WARNING: This product can expose you to chemicals including nickel which is known to the State of California to cause cancer, and chromium, which is known to the State of California to cause birth defects and/or reproductive harm. For more information go to www.P65Warnings.ca.gov.

Features

- Rotary switch
- SJT type cord - 3 conductor - 7' long
- Aluminum blade
- Coated steel guards with retaining clips
- Meets OSHA standards / 1 Year limited warranty
- Imported to TPI specifications

Motor Specification

- 3-Speed
- 120V
- Sleeve bearing
- 1-Phase
- Open ventilated
- Permanently lubricated

Standard Models

MFG CATALOG NUMBER	MFG MODEL NUMBER	SIZE	TYPE	MOTOR HP	CFM			MAX AMPS	WT. (LBS)	LIST
					HIGH	MED	LOW			
08723002	CF-12	12"	FLOOR	1/12	1050	875	750	0.6	10	106
08723102	CF-18	18"	FLOOR	1/5	1600	1480	1380	1.4	16	131
08706502	CF-20	20"	FLOOR	1/5	1725	1600	1480	1.9	18	181

Units should be used in clean, dry, commercial applications. Note: Photograph is a representation of stocked models. Actual model may vary in appearance.

Workstation Oscillating Office Fans



DESK FAN

STAND FAN

Features

- 3-speed oscillating fans with push button controls
- 3 conductor SPT cord & plug
- White powder coated wire mesh guards
- White plastic housing and blade
- Stand fan extends to 40" height
- Meets OSHA standards / 1 Year limited warranty
- Imported to TPI specifications

WARNING: This product can expose you to chemicals including nickel which is known to the State of California to cause cancer, and chromium, which is known to the State of California to cause birth defects and/or reproductive harm. For more information go to www.P65Warnings.ca.gov.

Standard Models

SIZE	MFG CATALOG NUMBER	MFG MODEL NUMBER	FAN TYPE	SPEEDS	CFM HIGH	AMPS HIGH	WT. (LBS)	LIST
12"	08513002	ODF-12	DESK	3	860	0.4	5.4	90
16"	08513102	ODF-16	DESK	3	1530	0.5	8.5	106
16"	08513202	OSF-16	STAND	3	1530	0.5	15.5	133

Workstation Wall Mount Fan With Pivoting Arm

18" HIGH VELOCITY FAN MOUNTED ON 24", 40", or 60" PIVOTING ARMS



WARNING: This product can expose you to chemicals including nickel which is known to the State of California to cause cancer, and chromium, which is known to the State of California to cause birth defects and/or reproductive harm. For more information go to www.P65Warnings.ca.gov.

Mounting Arm Features

- 1 1/2" square, 14 gauge, steel tubing
- 3" x 5" x 3/16" mounting plate attaches with (4) 3/8" bolts
- 5' long, 18/3 SJWT conductor cord and NEMA 5-15 grounded plug
- Dual electrical outlets embedded in arm to allow connection of modular fan and optional light
- Made in U.S.A. with domestic and foreign components



Modular Fan Features

- 18" high velocity circulator, with 3 speed, 1/8 HP, 115V, 1-Phase permanently lubricated, totally enclosed, PSC motor
- Modular fan plugs into electrical outlet on arm
- Coated steel guards / Aluminum blades
- Meets OSHA standards / 1 year limited warranty

Use on loading docks to cool off workers entering hot truck trailers.

Use at factory workstations to cool off people or the machines.

Standard Models

MFG CATALOG NUMBER	MFG MODEL NUMBER	FAN SIZE	ARM LENGTH	FAN CFM*			VELOCITY PROFILE CFM / Area Sq Ft	MAX AMPS	WT. (LBS)	LIST
				HIGH	MED	LOW				
08009102	24-LDF-TE	18"	24"	1800	1500	1300	2900 / 125	2.2	31	382
08009202	40-LDF-TE		40"						38	477
08009302	60-LDF-TE		60"						44	511

*Measured 2 feet from face of fan

Loading Dock Arm Fan

MFG CATALOG NUMBER	MFG MODEL NUMBER	FAN SIZE	FAN CFM*			MAX AMPS	WT. (LBS)	LIST
			HIGH	MED	LOW			
07971802	LDF-18-TE	18"	1800	1500	1300	2.2	20	238

Optional Modular Lights



DKL-INC



DKL-QH



Light Features

- Plugs into embedded outlet in arm
- On/Off switch and wire guard included
- Bulb included with DKL-QH and DKL-FL
- Made in U.S.A. with domestic and foreign components

Standard Models

WARNING: This product can expose you to chemicals including nickel which is known to the State of California to cause cancer, and chromium, which is known to the State of California to cause birth defects and/or reproductive harm. For more information go to www.P65Warnings.ca.gov.

MFG CATALOG NUMBER	MFG MODEL NUMBER	LIGHT HEAD TYPE	MAX WATTS	MAX LUMENS	AVE. BULB LIFE (HRS)	WT. (LBS)	LIST
04465602	DKL-INC	Incandescent	300	3,700	2,000	5	98
04465702	DKL-QH	Quartz Halogen	500	11,000	2,000	6	147

Low Velocity "Special Application" Workstation Fan



WALL MOUNT

WARNING: This product can expose you to chemicals including nickel which is known to the State of California to cause cancer, and chromium, which is known to the State of California to cause birth defects and/or reproductive harm. For more information go to www.P65Warnings.ca.gov.

Features

- 12" aluminum blade air circulator for wall, ceiling, or bench mount
- 120V, 1-phase, 1/12HP with direct wire electrical connection
- Toggle switch with 2-speed control generating up to 1200 CFM
- All metal construction with a gray powder coated finish
- Fan head tilts 90° in horizontal and vertical plane
- Conforms to U.S. Navy Specification MIL-DTL-68G
- Meets OSHA standards / 1-year limited warranty
- Made in the U.S.A. with domestic and foreign components

Standard Models

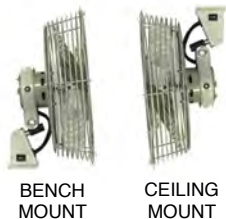

BENCH MOUNT

CEILING MOUNT

SIZE	MFG CATALOG NUMBER	MFG MODEL NUMBER	MOTOR HP	CFM* / RPM		VELOCITY PROFILE CFM / Area Sq Ft	AMPS HIGH	WT. (LBS)	LIST
				HIGH	LOW				
12"	08708902	N-12	1/12	800 / 1350	600 / 1000	1200 / 40	0.6	12	398

*Measured 2 feet from face of fan

Portable 18" Self Contained Power Mister



PM-18C



PM-18S

This outdoor rated portable misting system operates at 120-Volts and is created through the process of evaporation. TPI's self-contained power misting equipment creates a "fog" by pumping water at a medium flow rate through small nozzles from the misting hub. When combined with the air added by fan blades, this fog is rapidly evaporated. The heat required to evaporate the fog is extracted from the air causing a reduced air temperature. This cooler air is then distributed to people or animals creating a direct cooling zone.

Features

- Medium pressure 125 PSI diaphragm pumps water from a 10-gallon tank providing a "fog" like misting zone that can cover up to 400-sg.ft.
- 3-speed non-oscillating 18" diameter 3-paddle blades operates at 120-Volt, generates over 3100-CFMs pulling less than 3-amps, and includes an 18' long GFCI cord and 3-prong cord.
- Totally enclosed, weather-tight, 1/10-HP motor is UL / C-UL recognized, designed for outdoor applications, and is encased with steel spiral front and rear wire guards that meets OSHA requirements
- 4-nozzle misting hub system is standard, and additional misting nozzle and safety caps included
- Cart and stand models include a 10-gallon white water container including fill-line, drain cap & intake line with filter
- PM18-C model contains a black finish steel frame, includes operating handle, tank platform, upright stem and 10" wheel base and is shipped unassembled
- PM18-F offered a replacement fan head unit is shipped with no water container and can be placed onto existing 10-gallon igloo coolers
- Shipped in one single carton; unit is designed, engineered, tested and assembled in the U.S.A.



Additional nozzle & caps included with all models



Units include intake tubing line and water filter



Switch allows for Off, Fan Only or Fan & Mist Operation



PM-18FO

Motor Specification

- 1-Phase / 120V
- 3-Speed, 1/10 HP
- Sleeve bearing
- Permanently lubricated
- Totally Enclosed
- Weather-tight
- Outdoor rated
- All (3) models contain the same fan head, misting ring and pump assembly

Standard Models

MFG CATALOG NUMBER	MFG MODEL NUMBER	TYPE	FAN SIZE	MOTOR HP	AMPS	CFM*	VELOCITY PROFILE	WT. (LBS)	LIST
							CFM / Area Sq Ft		
08554702	PM-18S	Hand Carry	18"	1/10	1.1	1900	3100 / 140	30	1363
08554902	PM-18C	Cart						76	1733
08555202	PM-18FO	Fan Head Only						28	1168

*Measured 2 feet from face of fan

Replacement Parts

MFG CATALOG NUMBER	MFG MODEL NUMBER	DESCRIPTION	FITS MODELS	WT. (LBS)	LIST
08760702	NK-PM18	REPLACEMENT NOZZLE KIT	All PM18s	1	32

WARNING: This product can expose you to chemicals including nickel which is known to the State of California to cause cancer, and chromium, which is known to the State of California to cause birth defects and/or reproductive harm. For more information go to www.P65Warnings.ca.gov.

Industrial Ceiling Fans

Features

- 120-Volt / single phase, 60HZ electrical service
- Permanently sealed double radial ball bearing PSC AC motor provides maintenance free and quiet operation
- Low energy consumption – high efficiency performance
- White powder coated finish on steel motor housing & downrod
- White polymer 3-paddle blade system designed for quiet operation
- Includes 24" stainless steel safety cable kit
- Easy to mount to the supplied steel J-Hook connection
- Satisfies the U.S. Department of Energy's "Energy Guide" requirements
- E-CF models contain (4) 24" long lead wires for forward/reverse direct wire options providing year round operation in downflow or upflow direction
- E60-CFC has 3-speeds, includes cord/controller & IP65 rated equivalent for wet locations
- ETL Listed for USA & Canada / 5-year limited warranty



Models: E56-CF or E60-CF

Forward / Reverse wiring options



Model: E60-CFC
Indoor / Outdoor Rated
Plug & Play Install
Includes Speed Controller



Motor Specifications

- 1-Phase, 120V
- Permanent sealed
- Ball bearing PSC AC Motor

Model #	Amps	Watts
E-56CF	0.70	85
E-60CF	0.70	90
E-60CFC	0.80	95

WARNING: This product can expose you to chemicals including nickel which is known to the State of California to cause cancer, and chromium, which is known to the State of California to cause birth defects and/or reproductive harm. For more information go to www.P65Warnings.ca.gov.



Standard Models

MFG CATALOG NUMBER	MFG MODEL NUMBER	BLADE DIAMETER	AIRFLOW OPTIONS	DOWNROD LENGTH	MAX CFM	MOTOR RPM	MOTOR TYPE	CORD INCLUDED	SPEED CONTROLLER	WEIGHT (LBS.)	LIST
08198202	E-56CF	56"	Forward/Reverse	18"	7,775	290	Moisture Rated	None	Sold Separately	22	256
08198302	E-60CF	60"	Forward/Reverse	18"	8,434	260	Moisture Rated	None	Sold Separately	22	315
08198402	E-60CFC	60"	Down Draft	24"	9,630	250	Wet Rated	Yes	Included; 3-Speed	28	495

Accessories

MFG CATALOG NUMBER	MFG MODEL NUMBER	TYPE	VOLTS	MAX AMPS	VARIABLE CONTROL KNOB	REVERSING SWITCH	# OF FANS	FOR USE WITH	LIST
07994102	KBWC-110K	Solid State Variable Speed Controllers	120	10	Yes w/ 3" X 5" Aluminum Plate **	No	1-10	All 3-Models	202
08666802	KBWC-15SK			5		Yes	1-5	E-56CF & E60CF	185
08210602	DR36	Down Rod Extender	36" long, steel, white finish, 3/4" diameter					All 3-Models	60

** Fits 2" x 4" Opening

How to Determine the Total # of Ceiling Fans Needed

Ceiling Height (feet)	Coverage Area (square feet)
10 - 11	600
12 - 13	800
14 - 15	950
16 - 17	1100
18 - 19	1300
20 - 21	1450

What to Measure:
Total Square Footage (L x W)
Maximum Ceiling Height

Small Area Example:

If you had a 3,000 square foot facility with 16' ceilings:
Calculation (Total Sq.Ft. / Coverage Area): 3,000/1,100 = 2.73
Total # of fans needed = 3

Large Area Example:

If you had a 10,000 square foot facility with 13' ceilings:
Calculation (Total Sq.Ft. / Coverage Area): 10,000/800 = 12.5
Total # of fans needed = 12 (See chart for layout)

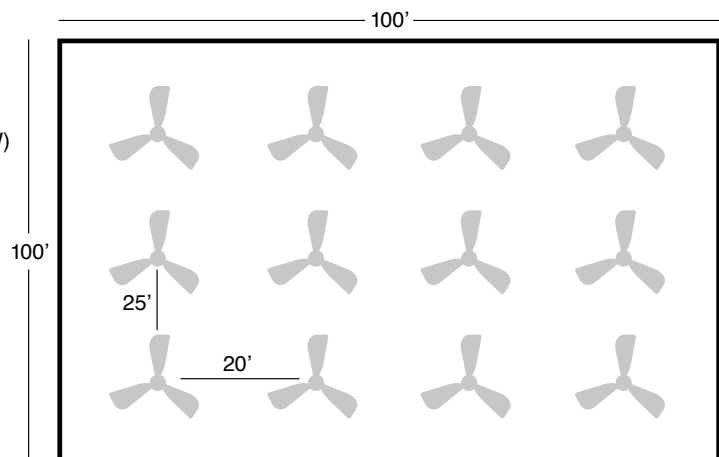

Shutter Mounted Direct Drive Exhaust Fans

Features

- Can be installed from inside wall
- Eliminates need for external framing and shutter
- Pull chain switch
- No Cord-Junction box provided for direct wiring
- Aluminum blade
- Steel spiral wire guards
- Made in U.S.A. with domestic and foreign components.
- See sizing chart on page 17



Motor Specifications

- 120V, 1-Phase, totally enclosed, permanently lubricated
- 1/12 HP motor is 3-Speed sleeve bearing permanent split capacitor
- 1/8 HP motor is 3-Speed sleeve bearing permanent split capacitor
- 1/4 HP motor is 2-Speed ball bearing permanent split capacitor

Note: Rough-in hole size is 1/2" inch larger than fan blade size

⚠ WARNING: This product can expose you to chemicals including nickel which is known to the State of California to cause cancer, and chromium, which is known to the State of California to cause birth defects and/or reproductive harm. For more information go to www.P65Warnings.ca.gov.

Standard Models

FAN SIZE	MFG CATALOG NUMBER	MFG MODEL NUMBER	HP	CFM / RPM			AMPS HIGH	WT. (LBS)	LIST
				HIGH	MED	LOW			
10"	08689902	CE 10-DS	1/12	680 / 1560	540 / 1250	460 / 1080	1	11	383
12"	07986202	CE 12-DS	1/12	825 / 1560	710 / 1250	560 / 1080	1.1	16	434
14"	08690002	CE 14-DS	1/8	1520 / 1660	1400 / 1550	1250 / 1370	2	17	549
16"	08690102	CE 16-DS	1/8	2100 / 1660	1900 / 1550	1700 / 1370	2.1	18	574
18"	07986302	CE 18-DS	1/8	2300 / 1660	2100 / 1050	1850 / 1370	2.2	25	624
20"	08690202	CE 20-DS	1/4	2925 / 1140	-	2380 / 1070	2.3	34	740
24"	07986402	CE 24-DS	1/4	3400 / 1140	-	2770 / 1070	2.5	47	822
30"	07986502	CE 30-DS	1/4	3950 / 1140	-	3080 / 1070	2.7	54	1030

Dimensions (Inches)

SIZE	DEPTH	DIMENSIONS		
		"A"	"B"	"C"
10"	5.81"	13.125"	10"	12.375"
12"	7.18"	15.125"	12"	14.375"
14"	7.18"	17.125"	14"	16.375"
16"	7.18"	19.125"	16"	18.250"
18"	7.18"	21.125"	18"	21.750"
20"	7.18"	23.125"	20"	23.686"
24"	7.18"	27.125"	24"	27.750"
30"	7.18"	33.125"	30"	33.750"

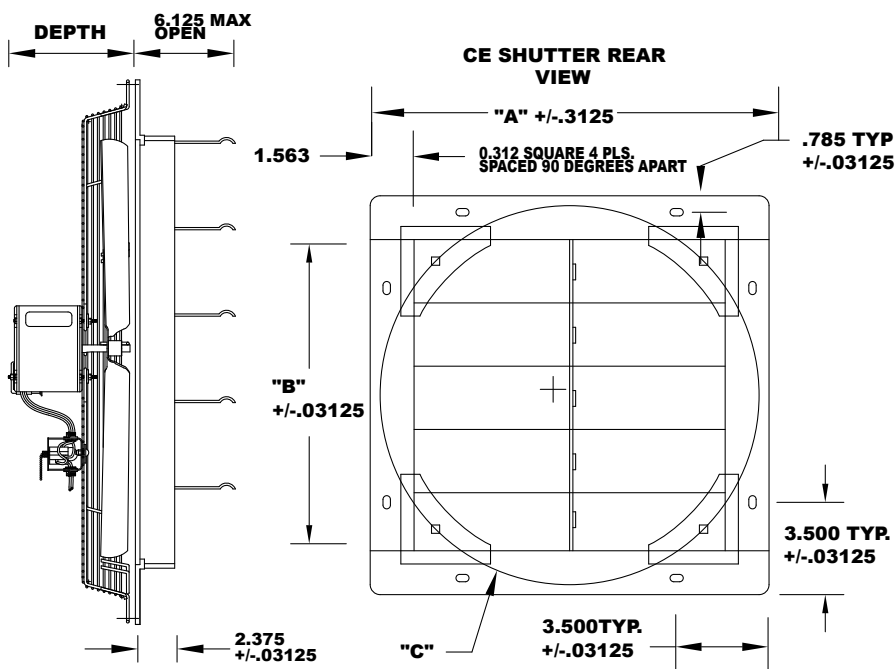

Guard Mounted Direct Drive Exhaust Fans

Features

- Bolts directly to the wall
 - Can be used with or without external shutter
 - Pull chain switch
 - No Cord-Junction box provided for direct wiring
 - Aluminum blade
 - Steel spiral wire guards
 - Made in U.S.A. with domestic and foreign components.
- Note: Rough-in hole size is 1/2" inch larger than fan blade size

WARNING: This product can expose you to chemicals including nickel which is known to the State of California to cause cancer, and chromium, which is known to the State of California to cause birth defects and/or reproductive harm. For more information go to www.P65Warnings.ca.gov.



Motor Specifications

- 120V, 1-Phase, totally enclosed, permanently lubricated
- 1/12 HP motor is 3-Speed sleeve bearing permanent split capacitor
- 1/8 HP motor is 3-Speed sleeve bearing permanent split capacitor
- 1/4 HP motor is 2-Speed ball bearing permanent split capacitor

Standard Models

FAN SIZE	MFG CATALOG NUMBER	MFG MODEL NUMBER	HP	CFM / RPM			AMPS HIGH	WT. (LBS)	LIST
				HIGH	MED	LOW			
10"	08689502	CE 10-D	1/12	680 / 1560	540 / 1250	460 / 1080	1	11	326
12"	07985002	CE 12-D	1/12	825 / 1560	710 / 1250	560 / 1080	1.1	12	368
14"	08689602	CE 14-D	1/8	1520 / 1660	1400 / 1550	1250 / 1370	2	17	390
16"	08689702	CE 16-D	1/8	2100 / 1660	1900 / 1550	1700 / 1370	2.1	18	408
18"	07984902	CE 18-D	1/8	2300 / 1660	2100 / 1050	1850 / 1370	2.2	19	448
20"	08689802	CE 20-D	1/4	2925 / 1140	-	2380 / 1070	2.3	34	582
24"	07984802	CE 24-D	1/4	3400 / 1140	-	2770 / 1070	2.5	38	648
30"	07984702	CE 30-D	1/4	3950 / 1140	-	3080 / 1070	2.7	42	755

Dimensions (Inches)

SIZE	BOLT HOLE CENTER WIDTH	DEPTH
10"	14.14"	5.81"
12"	16.46"	7.18"
14"	18.30"	7.18"
16"	20.34"	7.18"
18"	22.64"	7.18"
20"	25.46"	7.18"
24"	29.08"	7.18"
30"	34.89"	7.18"

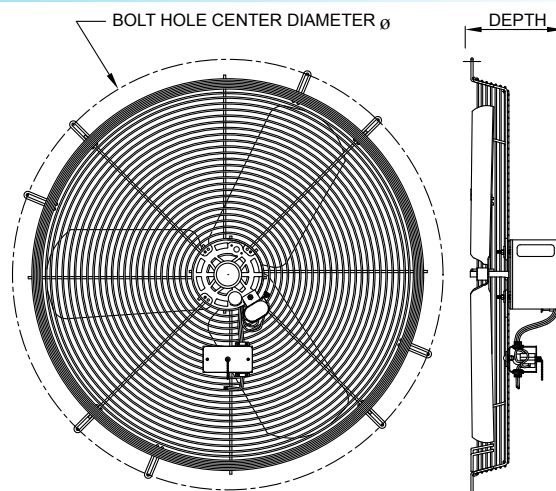

Optional Wall Shutters

FAN SIZE	MFG CATALOG NUMBER	MFG MODEL NUMBER	WT. (LBS)	LIST
10"	08684302	CES-10G	5	87
12"	07985502	CES-12G	5.5	120
14"	08684502	CES-14G	6.5	147
16"	08514702	CES-16G	8	170
18"	07985602	CES-18G	9	206
20"	07975202	CES-20G	10	229
24"	07985702	CES-24G	13	255
30"	07985802	CES-30G	19	298

Venturi Mounted Direct Drive Exhaust Fans

Features

- Can be installed from inside wall
- Can be used with external shutter
- Pull chain switch
- No Cord-Junction box provided for direct wiring
- Aluminum blade
- Steel spiral wire guards
- Made in U.S.A. with domestic and foreign components

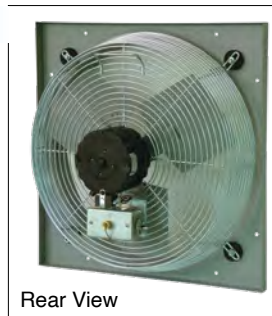

Motor Specifications

- 120V, 1-Phase, totally enclosed, permanently lubricated
- 1/12 HP motor is 3-Speed sleeve bearing permanent split capacitor
- 1/8 HP motor is 3-Speed sleeve bearing permanent split capacitor
- 1/4 HP motor is 2-Speed ball bearing permanent split capacitor

Note: Rough-in hole size is 1/2" inch larger than fan blade size

WARNING: This product can expose you to chemicals including nickel which is known to the State of California to cause cancer, and chromium, which is known to the State of California to cause birth defects and/or reproductive harm. For more information go to www.P65Warnings.ca.gov.

Standard Models

FAN SIZE	MFG CATALOG NUMBER	MFG MODEL NUMBER	HP	CFM / RPM			AMPS HIGH	WT. (LBS)	LIST
				HIGH	MED	LOW			
10"	08690302	CE 10-DV	1/12	680 / 1560	540 / 1250	460 / 1080	1	11	383
12"	07986602	CE 12-DV	1/12	825 / 1560	710 / 1250	560 / 1080	1.1	17	433
14"	08690402	CE 14-DV	1/8	1520 / 1660	1400 / 1550	1250 / 1370	2	17	549
16"	08690502	CE 16-DV	1/8	2100 / 1660	1900 / 1550	1700 / 1370	2.1	18	574
18"	07986702	CE 18-DV	1/8	2300 / 1660	2100 / 1050	1850 / 1370	2.2	26	624
20"	08690602	CE 20-DV	1/4	2925 / 1140	-	2380 / 1070	2.3	34	740
24"	07986802	CE 24-DV	1/4	3400 / 1140	-	2770 / 1070	2.5	48	822
30"	07986902	CE 30-DV	1/4	3950 / 1140	-	3080 / 1070	2.7	55	1030

Dimensions (Inches)

SIZE	DEPTH	DIMENSIONS				
		"A"	"B"	"C"	"D"	"E"
10"	5.81"	10.250"	12.63"	12.375"	2.000"	12.875"
12"	7.18"	12.250"	14.50"	14.375"	2.000"	14.625"
14"	7.18"	14.250"	17.13"	16.375"	2.500"	17.375"
16"	7.18"	16.250"	19.13"	18.250"	2.875"	20.000"
18"	7.18"	18.125"	21.00"	21.750"	2.750"	22.875"
20"	7.18"	20.250"	23.13"	23.686"	2.750"	25.625"
24"	7.18"	24.250"	29.50"	27.750"	2.875"	27.875"
30"	7.18"	30.250"	33.50"	33.750"	2.875"	33.875"

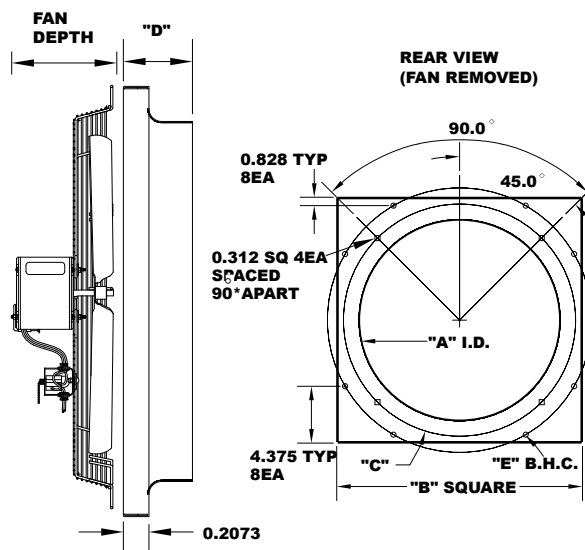

Optional Wall Shutters

FAN SIZE	MFG CATALOG NUMBER	MFG MODEL NUMBER	DIMENSIONS		WT. (LBS)	LIST
			WIDTH	LENGTH		
10"	08684302	CES-10G	13.13"	13.13"	5.0	87
12"	07985502	CES-12G	15.13"	15.13"	5.5	120
14"	08684502	CES-14G	17.13"	17.13"	6.5	147
16"	08514702	CES-16G	19.00"	19.00"	8.0	170
18"	07985602	CES-18G	21.13"	21.13"	9.0	206
20"	07975202	CES-20G	23.13"	23.13"	10.0	229
24"	07985702	CES-24G	27.13"	27.13"	13.0	255
30"	07985802	CES-30G	33.13"	33.13"	19.0	298

Belt Drive Exhaust Fans & Optional Shutters

Venturi Mounted Belt Drive Exhaust Fan

Features

- Steel venturi frame exhaust fan, bolts directly to an inside wall or framed / vertical surface
- Motor is designed for direct wiring connection; NO cord provided
- Operates at 115/120V at single-phase or 230/460V at 3-phase; 1725 RPMs
- Single speed, belt drive motor constructed of ball bearing, split capacitor, drip proof and is permanently lubricated
- Steel frame has a gray powder coated finish and uses a 4-paddle aluminum blade
- Designed for harsh industrial and commercial environments to improve air quality
- Belt drive motor allows for quieter operation and higher air volume performance
- Can be used with or without external shutter (sold separately)
- UL recognized motor has a frame size of 56
- Proudly Designed, Engineered, Tested and Assembled in the USA



Dimensions (Inches)

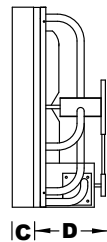
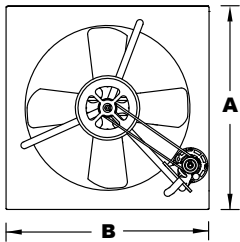

MODEL	DIMENSIONS A x B x C x D
CE-24B	29.5" x 28" x .75" x 17"
CE-30B	35.5" x 34" x .75" x 17"
CE-36B	41.5" x 40" x .75" x 17"
CE-42B	48" x 48" x .75" x 17"
CE-48B	54" x 54" x .75" x 17"

WARNING: This product can expose you to chemicals including nickel which is known to the State of California to cause cancer, and chromium, which is known to the State of California to cause birth defects and/or reproductive harm. For more information go to www.P65Warnings.ca.gov.

Standard Models

SIZE	MOTOR HP	AMPS		CFM	WT. (LBS)	115V 1-PHASE			230/460V 3-PHASE		
		115V	230/460V			MFG CATALOG NUMBER	MFG MODEL NUMBER	LIST	MFG CATALOG NUMBER	MFG MODEL NUMBER	LIST
24	1/3	5	1.9 / .9	10,000	50	07967002	CE-24B	931	08510402	CE-24B-3	1071
30	1/3	6	1.9 / .9	11,600	60	07967102	CE-30B	1049	08510502	CE-30B-3	1196
36	1/2	8	2.3 / 1.1	14,000	65	07967202	CE-36B	1211	08510602	CE-36B-3	1353
42	3/4	11	3.3 / 1.5	17,500	75	07967302	CE-42B	1520	08510702	CE-42-B-3	1886
48	1	15	3.8 / 1.9	23,500	98	07967402	CE-48B	1899	08510802	CE-48-B-3	2009

Optional Exhaust Shutters



Features

- Air open - gravity close
- Aluminum frame
- Aluminum louvers
- Weather stripping for tighter seal
- For ONLY CE-Series BELT Drive Fans
- Made in U.S.A.

Standard Models

MFG CATALOG NUMBER	MFG MODEL NUMBER	WT. (LBS)	LIST
07967502	CES-24	11	313
07967602	CES-30	15	383
07967702	CES-36	19	670
07967802	CES-42	23	853
07967902	CES-48	28	983

Shutter Dimensions (Inches)

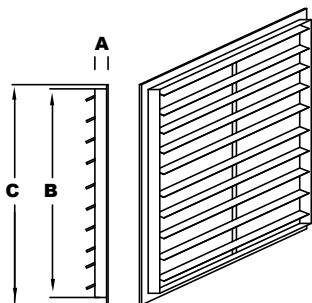

- (A) Thickness
- (B) Blade Housing Size
- (C) Overall Size

MFG MODEL NUMBER	OUTSIDE FRAME DIMENSIONS A x C x C	INSIDE FRAME DIMENSIONS B x B
CES-24	3" x 27" x 27"	24" x 24"
CES-30	3" x 33" x 33"	30" x 30"
CES-36	3" x 39" x 39"	36" x 36"
CES-42	3" x 45" x 45"	42" x 42"
CES-48	3" x 51" x 51"	48" x 48"

* Recommend adding 1/2" to inside frame dimension for wall opening

Industrial Direct Drive Exhaust Fans

Features

- Totally enclosed motors:
 - 1-Phase motors are field convertible 115V / 230V
 - 3-Phase motors are field convertible 230V / 460V
 - Motors are set to lower voltage at the factory, unless a request is made at time of order to set to the higher voltage
- 14 gauge steel venturi with steel pipe bracing
- 4-blade steel propeller
- 1 year limited warranty



WARNING: This product can expose you to chemicals including nickel which is known to the State of California to cause cancer, and chromium, which is known to the State of California to cause birth defects and/or reproductive harm. For more information go to www.P65Warnings.ca.gov.

Options

- CES Shutters
- EMF Front Guards
- IBG Rear Guards

Standard Models

BLADE SIZE	MFG MODEL NUMBER		PANEL SIZE (Sq.)	HP	RPM	CFM 0" SP	db's @ 10'	WT. (LBS)	LIST	
	1-PHASE	3-PHASE							TEC	
	115/230V-60Hz	208/230/460v-60Hz							1 PH	3 PH
12"	IED12-1/4	IED12-1/4-3	16"	1/4	1725	1480	64	30	1591	1596
16"	IED16-1/3	IED16-1/3-3	20"	1/3	1725	2834	73	40	1905	1944
18"	IED18-1/2	IED18-1/2-3	24"	1/2	1725	3890	74	55	2140	2158
20"	IED20-3/4	IED20-3/4-3	24"	3/4	1725	4574	77	65	2486	2486
24"	IED24-1	IED24-1-3	30"	1	1725	6632	81	155	2869	2713
30"	IED30-1	IED30-1-3	36"	1	1150	8600	79	185	5616	3251
36"	IED36-1 1/2	IED36-1 1/2-3	42"	1.5	1150	12103	82	260	7079	4349
42"	-----	IED42-2-3	48"	2	1150	17315	87	280	--	4662
48"	-----	IED48-3-3	54"	3	850	24280	86	360	--	6535

Note: Products listed in this section are custom built and subject to 100% cancellation/restocking charges

Dimensions

SIZE	BLADE DIAMETER	PANEL SIZE	DEPTH DIMENSION
12"	12"	16"	11"
16"	16"	20"	11"
20"	20"	24"	13"
24"	24"	30"	15"
30"	30"	36"	15"
36"	36"	42"	18"
42"	42"	48"	18"
48"	48"	54"	20"

Note: Depth dimension varies with motor selection

Industrial Belt Drive Exhaust Fans

Features

- Totally enclosed motors:
 - 1-Phase motors are field convertible 115V / 230V
 - 3-Phase motors are field convertible 230V / 460V
 - Motors are set to lower voltage at the factory, unless a request is made at time of order to set to the higher voltage
- 16 gauge steel venturi with steel pipe bracing
- Steel blades
- Double pillow block bearing shaft support
- 1 year limited warranty



⚠ WARNING: This product can expose you to chemicals including nickel which is known to the State of California to cause cancer, and chromium, which is known to the State of California to cause birth defects and/or reproductive harm. For more information go to www.P65Warnings.ca.gov.

Options

- CES Shutters
- EMF Front Guard
- IBG Rear Guards

Standard Models

BLADE SIZE	MFG MODEL NUMBER		PANEL SIZE (Sq.)	HP	RPM	CFM	db's @ 10'	WT. (LBS)	LIST	
	1-PHASE	3-PHASE							1 PH	3PH
	115/230V-60Hz	208/230/460v-60Hz								
24"	IE24-1/3	IE24-1/3-3	30"	1/3	825	5300	61	70	2764	2786
	IE24-1/2	IE24-1/2-3		1/2	925	6200	66	75	2854	2870
	IE24-3/4	IE24-3/4-3		3/4	1050	7000	71	82	3091	2902
	IE24-1	IE24-1-3		1	1175	7800	73	90	3124	2975
30"	IE30-1/3	IE30-1/3-3	36"	1/3	570	7500	62	95	2891	2913
	IE30-1/2	IE30-1/2-3		1/2	625	8500	64	95	3224	3005
	IE30-3/4	IE30-3/4-3		3/4	725	10000	66	105	3229	3047
	IE30-1	IE30-1-3		1	825	11000	70	115	3301	3151
36"	IE36-1/3	IE36-1/3-3	42"	1/3	425	9000	64	103	3182	3199
	IE36-1/2	IE36-1/2-3		1/2	500	10500	66	105	3278	3301
	IE36-3/4	IE36-3/4-3		3/4	575	11900	68	110	3567	3335
	IE36-1	IE36-1-3		1	650	13100	70	120	3549	3400
	IE36-1 1/2	IE36-1 1/2-3		1 1/2	750	15000	72	155	4056	3872
	IE36-2	IE36-2-3		2	830	16500	74	165	----	3951
42"	IE42-3/4	IE42-3/4-3	48"	3/4	430	14000	67	175	3977	3796
	IE42-1	IE42-1-3		1	490	15400	69	180	4007	3866
	IE42-1 1/2	IE42-1 1/2-3		1 1/2	550	17200	71	185	4197	4019
	IE42-2	IE42-2-3		2	620	19400	74	200	----	4584
	-----	IE42-3-3		3	700	22000	79	225	----	4742
48"	IE48-3/4	IE48-3/4-3	54"	3/4	350	17000	70	185	4352	4169
	IE48-1	IE48-1-3		1	400	19100	71	190	4384	4239
	IE48-1 1/2	IE48-1 1/2-3		1 1/2	460	22000	72	200	4565	4388
	IE48-2	IE48-2-3		2	520	24000	74	250	----	5108
	-----	IE48-3-3		3	590	27500	80	260	----	5266
	-----	IE48-5-3		5	660	30500	83	280	----	5307
60"	IE60-2	IE60-2-3	66"	2	320	31000	77	320	----	7107
	-----	IE60-3-3		3	370	35000	84	330	----	7263
	-----	IE60-5-3		5	420	39000	86	350	----	7325

Note: Products listed in this section are custom built and subject to 100% cancellation/restocking charges

Dimensions

SIZE	BLADE DIAMETER	PANEL SIZE	DEPTH DIMENSION
24"	24"	30"	18"
30"	30"	36"	18"
36"	36"	42"	20"
42"	42"	48"	20"
48"	48"	54"	22"
60"	60"	66"	28"

Note: Depth dimension varies with motor selection

Heavy Duty Direct Drive Exhaust Fans

Features

- Totally enclosed and explosion proof motors
 - Explosion proof motors are Class 1, Div 1 Group D and Class 2, Div 1, Groups F & G
- Fans are shipped completely assembled
- Cast aluminum blades
- 14 gauge steel panel with welded steel pipe bracing
- 1 year limited warranty

⚠ WARNING: This product can expose you to chemicals including nickel which is known to the State of California to cause cancer, and chromium, which is known to the State of California to cause birth defects and/or reproductive harm. For more information go to www.P65Warnings.ca.gov.



Options

- CES Shutters
- EMF Front Guards
- IBG Rear Guards
- Acid Resistant Coating
- Reversed Air Flow
- Flat Front Venturi

Standard Models

BLADE SIZE	MFG MODEL NUMBER		PANEL SIZE (Sq.)	HP	RPM	CFM @ 0" SP	db's @ 10'	WT. (LBS)	LIST			
	1-PHASE	3-PHASE							TEC		EXP*	
	115/230V-60Hz	208/230/460v-60Hz							1 PH	3 PH	1 PH	3 PH
12"	EHD12-1/4	EHD12-1/4-3	16"	1/4	1725	1180	74	35	2014	2003	2523	2608
16"	EHD16-1/4	EHD16-1/4-3	20"	1/4	1725	2800	75	45	2457	2472	2967	3052
18"	EHD18-1/3	EHD18-1/3-3	20"	1/3	1725	3375	75	60	2608	2629	3273	3451
	EHD18-1/2	EHD18-1/2-3		1/2	1725	4150	76	60	2721	2738	3502	3465
20"	EHD20-1/4	EHD20-1/4-3	24"	1/4	1725	3720	75	60	2494	2481	3008	3088
	EHD20-1/2	EHD20-1/2-3		1/2	1725	4800	76	65	2687	2709	3471	3437
	EHD20-1	EHD20-1-3		1	1725	6900	77	70	3002	2858	3751	3815
24"	EHD24-1/4	EHD24-1/4-3	30"	1/4	1725	5200	82	135	2645	2629	3156	3243
	EHD24-1/3	EHD24-1/3-3		1/3	1150	4975	75	145	3199	3243	4285	4345
	EHD24-1/2	EHD24-1/2-3		1/2	1725	6510	82	140	2930	2942	3709	3674
	EHD24-3/4	EHD24-3/4-3		3/4	1725	6900	83	145	3165	2985	3952	3760
	EHD24-1	EHD24-1-3		1	1725	7425	83	155	3251	3101	4003	4064
	EHD24-2	EHD24-2-3		2	1725	9525	83	165	4101	3365	----	4489
-----	EHD24-3-3	3	1725	10500	85	170	----	3657	----	4856		
30"	EHD30-1/3	EHD30-1/3-3	36"	1/3	1150	6950	79	145	3502	3545	4585	4653
	EHD30-1/2	EHD30-1/2-3		1/2	1725	8980	89	135	3259	3273	4037	4003
	EHD30-3/4	EHD30-3/4-3		3/4	1150	10440	79	175	4172	3723	4809	4666
	-----	EHD30-1-3		1	870	10640	74	215	----	4601	----	----
	EHD30-1 1/2	EHD30-1 1/2-3		1 1/2	1725	12000	89	165	3795	3609	5860	4722
	EHD30-2	EHD30-2-3		2	1150	14000	82	215	----	4302	----	5578
-----	EHD30-3-3	3	1725	16000	89	190	----	3866	----	5058		
36"	EHD36-1	EHD36-1-3	42"	1	1150	13600	84	225	6007	4800	7215	5694
	-----	EHD36-2-3		2	1150	17620	84	250	----	4942	----	6222
	-----	EHD36-3-3		3	1150	20500	85	255	----	5681	----	7186
	-----	EHD36-5-3		5	1725	28000	94	250	----	4765	----	6072
42"	-----	EHD42-1-3	48"	1	870	15800	82	300	----	5578	----	----
	EHD42-2	EHD42-2-3		2	1150	17964	88	260	----	5256	----	6536
	-----	EHD42-3-3		3	1150	24500	88	270	----	5908	----	7413
	-----	EHD42-5-3		5	1150	28970	88	285	----	6143	----	8292
48"	-----	EHD48-3-3	54"	3	1150	28600	92	290	----	7128	----	8636
	-----	EHD48-5-3		5	1150	32000	94	305	----	7467	----	9621
60"	-----	EHD60-3-3	66"	3	1150	40000	97	700	----	8852	----	10355
	-----	EHD60-5-3		5	1150	45000	97	730	----	9686	----	11844
	-----	EHD60-7 1/2-3		7 1/2	870	47000	92	740	----	12721	----	----
	-----	EHD60-10-3		10	870	57200	93	750	----	17047	----	----

Single Phase motors are field convertible 115V/230V. Three phase motors are field convertible 230V/460V. Motors are set to lower voltage at the factory, unless a request is made at time of order to set to the higher voltage. Note: Products listed in this section are custom built and subject to 100% cancellation/restocking charges *Not all EXP motors are 208V capable

Dimensions

SIZE	BLADE DIAMETER	PANEL SIZE	DEPTH DIMENSION
12"	12"	16"	11"
16"	16"	20"	11"
20"	20"	24"	13"
24"	24"	30"	15"
30"	30"	36"	15"
36"	36"	42"	18"
42"	42"	48"	18"
48"	48"	54"	20"
60"	60"	66"	22"

Note: Depth dimension varies with motor selection

Heavy Duty Belt Drive Exhaust Fans

Features

- Totally enclosed and explosion proof motors
 - Explosion proof motors are Class 1, Div 1 Group D and Class 2, Div 1, Groups F & G
- Fans are shipped completely assembled
- Heavy gauge steel blades on TEC models
- Cast aluminum blades on EXP explosion proof models
- 14 gauge steel panel with welded steel pipe bracing
- 1 year limited warranty
- For optimum shutter efficiency, mount shutter 1/3 the distance of the fan opening size.
Example: 36" fan shutter would be mounted 12" from the fan blade

⚠ WARNING: This product can expose you to chemicals including nickel which is known to the State of California to cause cancer, and chromium, which is known to the State of California to cause birth defects and/or reproductive harm. For more information go to www.P65Warnings.ca.gov.

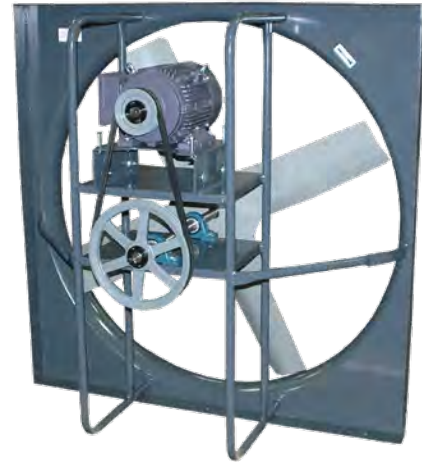

Options

- CES Shutters
- EMF Front Guards
- IBG Rear Guards
- Reversed Air Flow
- Flat Front Venturi

Standard Models

BLADE SIZE	MFG MODEL NUMBER		PANEL SIZE (Sq.)	HP	RPM	CFM 0" SP	db's @ 10"	WT. (LBS)	LIST			
	1-PHASE	3-PHASE							TEC		EXP*	
	115/230V-60Hz	208/230/460v-60Hz							1 PH	3 PH	1 PH	3 PH
24"	EHB24-1/4	EHB24-1/4-3	30"	1/4	780	4900	60	100	3331	3316	4524	4611
	EHB24-1/2	EHB24-1/2-3		1/2	980	6219	66	130	3524	3537	4981	4938
	EHB24-3/4	EHB24-3/4-3		3/4	1140	7090	71	140	3766	3572	5231	5037
	EHB24-1	EHB24-1-3		1	1250	7180	73	140	4011	3858	5287	5358
30"	EHB30-1/4	EHB30-1/4-3	36"	1/4	540	7178	61	140	3552	3537	4975	5061
	EHB30-1/3	EHB30-1/3-3		1/3	595	7909	63	150	3615	3638	5189	5366
	EHB30-1/2	EHB30-1/2-3		1/2	640	8507	64	155	3709	3723	5425	5388
	EHB30-3/4	EHB30-3/4-3		3/4	770	10235	66	165	4031	3838	5753	5559
	EHB30-1	EHB30-1-3		1	975	10668	70	170	4237	4089	5801	5875
	EHB30-1 1/2	EHB30-1 1/2-3		1 1/2	1140	12473	77	180	4422	4224	7322	6174
36"	EHB36-1/3	EHB36-1/3-3	42"	1/3	460	9113	64	160	4202	4224	5646	5823
	EHB36-1/2	EHB36-1/2-3		1/2	530	10500	66	180	4303	4317	6009	5967
	EHB36-3/4	EHB36-3/4-3		3/4	605	11985	68	200	4580	4395	6287	6095
	EHB36-1	EHB36-1-3		1	665	13174	70	200	4611	4457	6296	6358
	EHB36-1 1/2	EHB36-1 1/2-3		1 1/2	720	13660	72	210	5195	5010	7979	6825
	EHB36-2	EHB36-2-3		2	870	16554	74	215	5738	5137	----	7074
42"	EHB42-1/3	EHB42-1/3-3	48"	1/3	335	10614	64	205	4372	4395	6174	6351
	EHB42-1/2	EHB42-1/2-3		1/2	390	12343	65	210	4466	4481	6387	6358
	EHB42-3/4	EHB42-3/4-3		3/4	435	14040	67	225	4760	4573	6760	6557
	EHB42-1	EHB42-1-3		1	490	15429	69	230	4823	4671	6765	6825
	EHB42-1 1/2	EHB42-1 1/2-3		1 1/2	550	17420	71	240	5017	4831	8308	7152
	EHB42-2	EHB42-2-3		2	725	20653	74	245	5946	5343	----	7469
	----	EHB42-3-3		3	830	23645	79	250	----	5518	----	7702
48"	EHB48-1/2	EHB48-1/2-3	54"	1/2	330	15230	69	190	5524	5537	7680	7645
	EHB48-3/4	EHB48-3/4-3		3/4	370	17339	70	195	5794	5609	8144	7951
	EHB48-1	EHB48-1-3		1	410	19188	71	235	5831	5681	8151	8224
	EHB48-1 1/2	EHB48-1 1/2-3		1 1/2	465	21731	72	245	6066	5881	9681	8523
	EHB48-2	EHB48-2-3		2	520	24274	74	250	7038	6438	----	8799
	----	EHB48-3-3		3	680	28150	80	270	----	6623	----	9060
	----	EHB48-5-3		5	800	33160	83	285	----	6701	----	9237
60"	EHB60-1	EHB60-1-3	66"	1	280	23090	76	380	8130	7979	11016	11088
	EHB60-1 1/2	EHB60-1 1/2-3		1 1/2	340	28068	77	390	8322	8139	12552	11401
	EHB60-2	EHB60-2-3		2	390	32200	78	395	8807	8216	----	11552
	----	EHB60-3-3		3	450	37183	84	410	----	8616	----	11930
	----	EHB60-5-3		5	540	44600	86	420	----	8681	----	12101

Single Phase motors are field convertible 115V/230V. Three phase motors are field convertible 230V/460V. Motors are set to lower voltage at the factory, unless a request is made at time of order to set to the higher voltage. Note: Products listed in this section are custom built and subject to 100% cancellation/restocking charges. *Not all EXP motors are 208V capable.

Dimensions

SIZE	BLADE DIAMETER	PANEL SIZE	DEPTH DIMENSION
24"	24"	30"	16"
30"	30"	36"	16"
36"	36"	42"	18"
42"	42"	48"	20"
48"	48"	54"	21"
60"	60"	66"	26"

Note: Depth dimension varies with motor selection.

Cabinet Exhaust Fans With Shutters

Features

- 120V, 1-Phase or 230 / 460V, 3-Phase, ball bearing, permanently lubricated, drip proof motor - UL listed
- Permanently lubricated bearings on blade drive shaft
- Aluminum blade
- Aluminum shutter
- 20 gauge powder coated venturi
- 18 gauge galvanized steel housing
- 1725 RPM motor
- Motor frame size 56 / Shaft: 5/8"
- Ships fully assembled
- Meets OSHA Standards
- 1 year warranty
- Made in U.S.A.



⚠ WARNING: This product can expose you to chemicals including nickel which is known to the State of California to cause cancer, and chromium, which is known to the State of California to cause birth defects and/or reproductive harm. For more information go to www.P65Warnings.ca.gov.

Standard Models

SIZE	MOTOR HP	AMPS		CFM	WT. (LBS)	115V 1-PHASE			230 / 460V 3-PHASE		
		115V	230/460V			MFG CATALOG NUMBER	MFG MODEL NUMBER	LIST	MFG CATALOG NUMBER	MFG MODEL NUMBER	LIST
		24	1/3			5	1.9 / .9	10,000	100	08683902	CBT-24B
30	1/3	6	1.9 / .9	11,600	120	08684002	CBT-30B	2219	08685302	CBT-30B-3	2380
36	1/2	8	2.3 / 1.1	14,000	135	08684102	CBT-36B	2504	08685402	CBT-36B-3	2710
42	3/4	11	3.3 / 1.5	17,500	155	08684202	CBT-42B	3080	08685502	CBT-42B-3	3323
48	1	15	3.8 / 1.9	23,500	200	08685102	CBT-48B	3816	08685002	CBT-48B-3	4064

Dimensions

SIZE	OUTSIDE DIMENSIONS			MAXIMUM REQUIRED INSIDE WALL OPENING
	HEIGHT	WIDTH	DEPTH	
24"	28 1/4"	28 1/4"	22 1/2"	28 3/4" x 28 3/4"
30"	34 1/4"	34 1/4"	22 1/2"	34 1/2" x 34 1/2"
36"	40 1/4"	40 1/4"	18 1/2"	40 1/2" x 40 1/2"
42"	48 1/2"	48 1/2"	18 1/2"	48 3/4" x 48 3/4"
48"	54 1/2"	54 1/2"	21 1/2"	54 3/4" x 54 3/4"

Exhaust Fan Accessories - Heavy Duty Exhaust Shutter

Features

- Air open - Gravity close
- Aluminum construction
- Heavy duty blades
- Weather stripping for tighter seal
- For optimum shutter efficiency, mount shutter 1/3 the distance of the fan opening size. Example: 36" fan shutter would be mounted 12" from the fan blade
- Shutter should be sized to fit exhaust opening
- For IE, IED, EHB and EHD models

Standard Models

FAN SIZE	MFG CATALOG NUMBER	MFG MODEL NUMBER	INSIDE FRAME DIMENSIONS	OUTSIDE FRAME DIMENSIONS	WT. (LBS)	LIST
12"	07983302	CES 12-HD	12" x 12"	14" x 15"	4	182
16"	08709102	CES 16-HD	16" x 16"	19" x 19"	7	219
18"	08518902	CES 18-HD	18" x 18"	21" x 21"	8	251
20"	08696602	CES 20-HD	20" x 20"	23" x 23"	9	257
24"	08757202	CES 24-HD	24" x 24"	27" x 27"	11	313
30"	08757302	CES 30-HD	30" x 30"	33" x 33"	15	383
36"	08757402	CES 36-HD	36" x 36"	39" x 39"	19	670
42"	08757502	CES 42-HD	42" x 42"	45" x 45"	23	853
48"	08757602	CES 48-HD	48" x 48"	51" x 51"	28	983
54"	08775102	CES 54-HD	54" x 54"	57" x 57"	39	1110
60"	07998702	CES 60-HD	60" x 60"	63" x 63"	47	1364



WARNING: This product can expose you to chemicals including nickel which is known to the State of California to cause cancer, and chromium, which is known to the State of California to cause birth defects and/or reproductive harm. For more information go to www.P65Warnings.ca.gov.

Heavy Duty Shutter Motor Kit Features



- Used to open shutter when shutter is used to provide make-up air (Shutter should be one size larger than exhaust fan size and should be located on opposite wall)
- Used for positive closure of exhaust shutter
- 115V or 230V, 60 HZ, 1-Phase

Standard Models

MFG CATALOG NUMBER	MFG MODEL NUMBER	DESCRIPTION	WT. (LBS)	LIST
07971002	MK-1	For shutter sizes 12" thru 30" (Single Panel)	5	507
07971102	MK-2	For shutter sizes 36" thru 48" (Double Panel)	8	670
08777102	MK-3	For shutter sizes 54" thru 72" (Double Panel)	12	863

Motorized Supply Air Intake Shutter

Features

- Inward opening blades for use with intake fans when shutter is located directly in air stream
- Galvanized construction
- 115V or 230V, 60 HZ, 1-Phase
- For IE, IED, EHB and EHD models

Standard Models

FAN SIZE	MFG CATALOG NUMBER	MFG MODEL NUMBER	ROUGH OPENING	OVERALL SIZE	WT. (LBS)	LIST
24"	08516902	CESM-24	24" x 24"	27" x 27"	15	1296
30"	08007102	CESM-30	30" x 30"	33" x 33"	18	1513
36"	08004602	CESM-36	36" x 36"	39" x 39"	21	1653
42"	08517202	CESM-42	42" x 42"	45" x 45"	35	2699
48"	07997202	CESM-48	48" x 48"	51" x 51"	42	3813
60"	07983002	CESM-60	60" x 60"	63" x 63"	56	4496



WARNING: This product can expose you to chemicals including nickel which is known to the State of California to cause cancer, and chromium, which is known to the State of California to cause birth defects and/or reproductive harm. For more information go to www.P65Warnings.ca.gov.

Exhaust Fan Accessories - Fan Guards

Rear Box Guard Bolt Together With Wire Guards



⚠ WARNING: This product can expose you to chemicals including nickel which is known to the State of California to cause cancer, and chromium, which is known to the State of California to cause birth defects and/or reproductive harm. For more information go to www.P65Warnings.ca.gov.

Features

- For IE, IED, EHB and EHD models
- ¼" Smaller than the panel size of the fan
- Meets OSHA requirements

Standard Models

MFG MODEL NUMBER	FITS FAN SIZE	LIST
IBG-24	24"	1134
IBG-30	30"	1195
IBG-36	36"	1437
IBG-42	42"	1508
IBG-48	48"	1848
IBG-60	60"	2851

Rear Expanded Metal Box Guard



⚠ WARNING: This product can expose you to chemicals including nickel which is known to the State of California to cause cancer, and chromium, which is known to the State of California to cause birth defects and/or reproductive harm. For more information go to www.P65Warnings.ca.gov.

Features

- For IE, IED, EHB and EHD models
- ¼" Smaller than the panel size of the fan
- Meets OSHA requirements

Standard Models

MFG MODEL NUMBER	FITS FAN SIZE	LIST
IBG-12	12"	696
IBG-16	16"	696
IBG-18	18"	771
IBG-20	20"	771

Spiral Front and Rear Guards

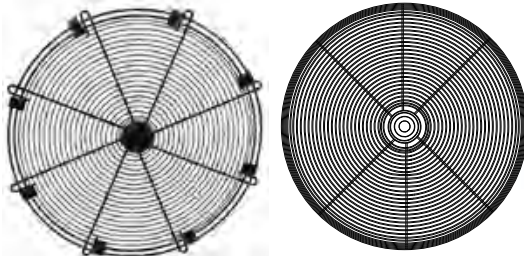

Spiral Front

Spiral Rear

⚠ WARNING: This product can expose you to chemicals including nickel which is known to the State of California to cause cancer, and chromium, which is known to the State of California to cause birth defects and/or reproductive harm. For more information go to www.P65Warnings.ca.gov.

Features

- For EHD models only
- Fits between motor and blade
- Rear guard installed at factory only
- Meets OSHA requirements

Standard Models

MFG MODEL NUMBER	TYPE	FITS FAN SIZE	LIST
SF-12	SPIRAL FRONT	12"	382
SF-16		16"	410
SF-18		18"	454
SF-20		20"	465
SF-24		24"	501
SR-12	SPIRAL REAR	12"	396
SR-16		16"	421
SR-18		18"	465
SR-20		20"	481
SR-24		24"	517

Expanded Metal Front Guard

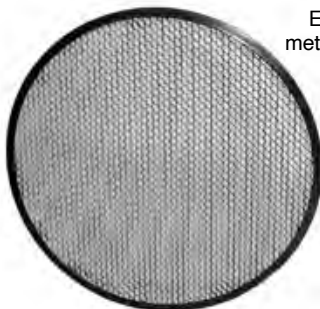

Expanded metal guard 60"

⚠ WARNING: This product can expose you to chemicals including nickel which is known to the State of California to cause cancer, and chromium, which is known to the State of California to cause birth defects and/or reproductive harm. For more information go to www.P65Warnings.ca.gov.

Features

- For EHB, EHD, IE, & IED models
- 1" Larger than blade size
- Meets OSHA requirements

Standard Models

MFG MODEL NUMBER	FITS FAN SIZE	LIST
EMF-12	12"	457
EMF-16	16"	473
EMF-20	20"	500
EMF-24	24"	525
EMF-30	30"	664
EMF-36	36"	821
EMF-42	42"	864
EMF-48	48"	943
EMF-60	60"	1423

Cabinet Exhaust Fan Package Option

With Bolt Together Rear Guard

Package Includes

- Wall collar
- Automatic shutter
- Rear box guard

Features

- For IE, IED, EHB and EHD models
- Wall collar OD is 1/4" larger than fan panel size
- Meets OSHA requirements

Standard Models

MFG MODEL NUMBER	FAN SIZE	LIST
CEFP-24	24"	2025
CEFP-30	30"	2287
CEFP-36	36"	2840
CEFP-42	42"	3264
CEFP-48	48"	3896



⚠ WARNING: This product can expose you to chemicals including nickel which is known to the State of California to cause cancer, and chromium, which is known to the State of California to cause birth defects and/or reproductive harm. For more information go to www.P65Warnings.ca.gov.

With Expanded Metal Rear Guard

Package Includes

- Wall collar
- Automatic shutter
- Rear box guard

Features

- For IE, IED, EHB and EHD models
- Wall collar OD is 1/4" larger than fan panel size
- Meets OSHA requirements

Standard Models

MFG MODEL NUMBER	FAN SIZE	LIST
CEFP-12	12"	1268
CEFP-16	16"	1353
CEFP-18	18"	1528
CEFP-20	20"	1586
CEFP-60	60"	5850

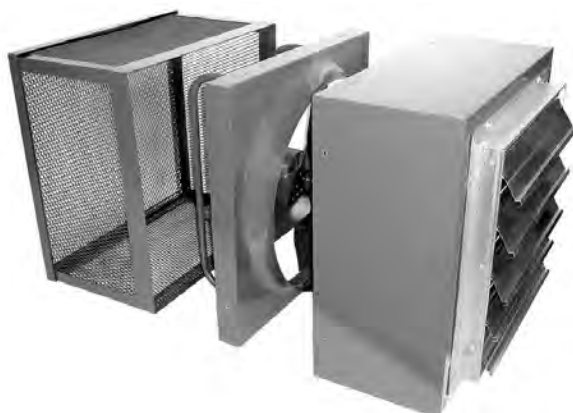

⚠ WARNING: This product can expose you to chemicals including nickel which is known to the State of California to cause cancer, and chromium, which is known to the State of California to cause birth defects and/or reproductive harm. For more information go to www.P65Warnings.ca.gov.

Exterior Weather Hood Option

Features

- For IE, IED, EHB and EHD models.
- Galvanized housing with 1/2 - 16 expanded metal bird screen
- Can be used for intake or exhaust
- Meets OSHA requirements

Standard Models

MFG MODEL NUMBER	FAN SIZE	LIST
WH-12	12"	1274
WH-16	16"	1329
WH-18	18"	1357
WH-20	20"	1380
WH-24	24"	1962
WH-30	30"	2043
WH-36	36"	2534
WH-42	42"	2633
WH-48	48"	3047
WH-60	60"	4074

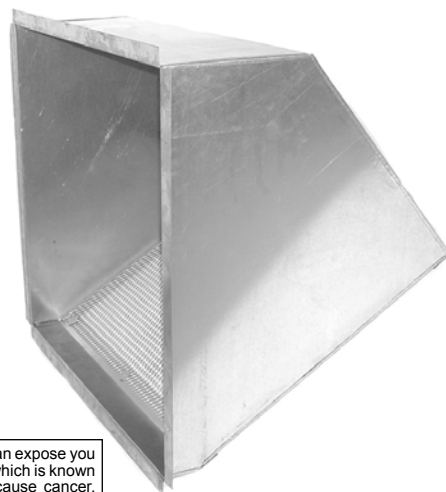

⚠ WARNING: This product can expose you to chemicals including nickel which is known to the State of California to cause cancer, and chromium, which is known to the State of California to cause birth defects and/or reproductive harm. For more information go to www.P65Warnings.ca.gov.

Insulated Roof Curbs



SLS-24

Features

- Used with UEB, UED, and RE roof ventilators
- For flat, single slope or ridge style roofs
- Galvanized steel construction
- 1 1/2" insulated thickness, 3 pounds density
- 8" height overall
- Not for corrugated roofs

⚠ WARNING: This product can expose you to chemicals including nickel which is known to the State of California to cause cancer, and chromium, which is known to the State of California to cause birth defects and/or reproductive harm. For more information go to www.P65Warnings.ca.gov.

Standard Models

FAN	MFG MODEL NUMBER			BASE DIMENSION	OVERALL DIMENSION	LIST		
	FLAT	SLOPE	RIDGE			FLAT	SLOPE	RIDGE
18"	FLS-18	SLS-18	RDS-18	32" x 32"	44" x 44"	607	1170	1380
24"	FLS-24	SLS-24	RDS-24	38" x 38"	50" x 50"	701	1339	1571
30"	FLS-30	SLS-30	RDS-30	44" x 44"	56" x 56"	792	1500	1772
36"	FLS-36	SLS-36	RDS-36	50" x 50"	62" x 62"	864	1645	1894
42"	FLS-42	SLS-42	RDS-42	56" x 56"	68" x 68"	952	1805	2137
48"	FLS-48	SLS-48	RDS-48	62" x 62"	74" x 74"	1282	2426	2875
54"	FLS-54	SLS-54	RDS-54	68" x 68"	80" x 80"	1397	2636	3121
60"	FLS-60	SLS-60	RDS-60	74" x 74"	86" x 86"	1516	2869	3394

Back Draft Dampers to Fit in Curb

UEB and UED models require higher curb height when used with back draft damper; consult factory

FAN SIZE	MFG MODEL NUMBER	SHUTTER SIZE	LIST
18"	CD-18	28" x 28"	803
24"	CD-24	34" x 34"	938
30"	CD-30	40" x 40"	1293
36"	CD-36	46" x 46"	1597
42"	CD-42	52" x 52"	1764
48"	CD-48	58" x 58"	2140
54"	CD-54	64" x 64"	2684
60"	CD-60	70" x 70"	2917

Motor Kit for Dampers

115V or 230V, 60Hz, 1-Phase. (Specify Voltage)

MFG MODEL NUMBER	DESCRIPTION	WT. (LBS)	LIST
DMKP1	For shutter sizes 18" thru 36"	5	733
DMKP2	For shutter sizes 42" thru 60"	8	874

Belt Drive Hooded Roof Ventilators

Features

- Used for exhaust or intake
- Heavy industrial steel base with aluminum hood
- Steel blades
- Bird screen included
- No back draft protection in standard construction
- Dampers offered as optional accessory
- 1 year limited warranty

WARNING: This product can expose you to chemicals including nickel which is known to the State of California to cause cancer, and chromium, which is known to the State of California to cause birth defects and/or reproductive harm. For more information go to www.P65Warnings.ca.gov.

Options

- Direct drive
- Protective coatings
- Roof curb
- Filters

Dimensions

SIZE	MINIMUM ROOF HOLE (SQUARE)	HOLE LENGTH x WIDTH	HOOD HEIGHT	ROOF CURB O.D. (SQUARE)
24"	30"	54" x 64"	30"	39"
30"	36"	60" x 76"	36"	45"
36"	42"	72" x 82"	40"	51"
42"	48"	80" x 89"	43"	57"
48"	54"	87" x 95"	46"	63"
54"	60"	92" x 98"	54"	69"
60"	66"	90" x 107"	56"	75"



CLOSED



OPEN

Standard Models

BLADE SIZE	1-PHASE 115/230V	3-PHASE 208/230/460v	HP	RPM	C.F.M - STATIC PRESSURE				Db's @ 10'	WT. (LBS)	LIST			
					MFG MODEL NUMBER						EXHAUST		INTAKE	
					0"	1/8"	1/4"	1/2"			1 PH	3 PH	1 PH	3 PH
24"	RE24-1/4	RE24-1/4-3	1/4	780	4900	4222	2807	800	60	340	7637	7605	7637	7605
	RE24-1/2	RE24-1/2-3	1/2	980	6219	5716	5061	2600	66	350	7914	7832	7914	7832
	RE24-3/4	RE24-3/4-3	3/4	1140	7090	6648	6144	4413	71	360	8084	7956	8084	7956
	RE24-1	RE24-1-3	1	1250	7180	6696	6271	4464	73	365	8523	8280	8523	8280
30"	RE30-1/3	RE30-1/3-3	1/3	595	7909	6380	3617	767	60	385	8865	8816	8865	8816
	RE30-1/2	RE30-1/2-3	1/2	640	8507	7170	4486	1373	64	385	9001	8920	9001	8920
	RE30-3/4	RE30-3/4-3	3/4	770	10235	9192	7657	3833	66	400	9310	9181	9310	9181
	RE30-1	RE30-1-3	1	975	10668	9959	8626	5184	70	400	9619	9374	9619	9374
	RE30-1 1/2	RE30-1 1/2-3	1.5	1140	12473	11867	11112	8135	77	410	9813	9449	9813	9449
36"	RE36-1/3	RE36-1/3-3	1/3	460	9113	6992	3722	486	64	425	10742	10691	10742	10691
	RE36-1/2	RE36-1/2-3	1/2	530	10500	8821	5985	2084	66	425	10872	10789	10872	10789
	RE36-3/4	RE36-3/4-3	3/4	605	11985	10583	8563	4017	68	435	11089	10961	11089	10961
	RE36-1	RE36-1-3	1	665	13174	11932	10299	5729	70	440	11340	11096	11340	11096
	RE36-1 1/2	RE36-1 1/2-3	1.5	720	13660	12012	9579	5000	72	440	11786	11381	11786	11381
	RE36-2	RE36-2-3	2	870	16554	15376	14088	9691	74	455	12664	11976	12664	11976
42"	RE42-1/2	RE42-1/2-3	1/2	390	12343	9352	4957	1642	65	540	12049	11966	12049	11966
	RE42-3/4	RE42-3/4-3	3/4	435	14040	11530	7633	3311	67	545	12471	12342	12471	12342
	RE42-1	RE42-1-3	1	490	15429	13194	10438	4668	69	555	12722	12479	12722	12479
	RE42-1 1/2	RE42-1 1/2-3	1.5	550	17420	15421	13117	7289	71	560	12974	12569	12974	12569
	RE42-2	RE42-2-3	2	725	20653	19128	17503	11319	74	570	13763	13079	13763	13079
	-----	RE42-3-3	3	830	23645	22296	20984	17290	79	585	-----	13244	-----	13244
48"	RE48-3/4	RE48-3/4-3	3/4	370	17339	13700	7389	2244	70	650	14624	14494	14624	14494
	RE48-1	RE48-1-3	1	410	19188	16078	10903	4037	71	660	14883	14639	14883	14639
	RE48-1 1/2	RE48-1 1/2-3	1.5	465	21731	19010	14991	7081	72	665	15110	14706	15110	14706
	RE48-2	RE48-2-3	2	520	24274	21943	19080	10125	74	680	15980	15289	15980	15289
	-----	RE48-3-3	3	680	28150	25683	23615	16930	80	700	-----	15482	-----	15482
	-----	RE48-5-3	5	800	33160	30900	29290	25000	83	720	-----	15606	-----	15606
54"	RE54-1	RE54-1-3	1	410	23130	20588	17500	9600	73	910	17709	17464	17709	17464
	RE54-1 1/2	RE54-1 1/2-3	1.5	450	25400	22600	19300	10316	75	920	18066	17661	18066	17661
	RE54-2	RE54-2-3	2	480	27200	24312	20660	11010	76	930	18522	17831	18522	17831
	-----	RE54-3-3	3	550	31213	28722	25830	15420	77	940	-----	18156	-----	18156
	-----	RE54-5-3	5	660	37458	35238	32893	26538	80	960	-----	18293	-----	18293
60"	RE60-1	RE60-1-3	1	250	23090	19161	12850	-----	76	1150	18635	18392	18635	18392
	RE60-1 1/2	RE60-1 1/2-3	1.5	340	28068	23283	15624	8000	77	1150	19350	18943	19350	18943
	RE60-2	RE60-2-3	2	390	32200	26710	17924	9380	78	1200	19774	19083	19774	19083
	-----	RE60-3-3	3	450	37183	32356	25324	15013	84	1220	-----	19417	-----	19417
	-----	RE60-5-3	5	540	44600	41232	35819	23237	86	1240	-----	19537	-----	19537
	-----	RE60-7 1/2-3	7.5	620	50184	47603	43981	32880	89	1285	-----	20227	-----	20227

Note: Products listed in this section are custom built and subject to 100% cancellation/restocking charges

Direct Drive Roof Ventilators



Features

- Cast Aluminum blades on most models
- Totally enclosed and explosion proof motors
- 1-Phase motors are field convertible 115V/230V
- 3-Phase motors are field convertible 230V/460V
- Motors are set to lower voltage at the factory unless a request is made at time of order to set them to the higher voltage
- Explosion proof motors are Class 1, Div 1, Group D and Class 2, Div 1, Groups F & G
- Wind band is 18 gauge galvanized steel
- Rubber shim under dampers for better seal
- Size of roof opening to be 6" larger than fan size
- Some models available with low R.P.M. motor for quieter operation
- 1 year limited warranty

⚠ WARNING: This product can expose you to chemicals including nickel which is known to the State of California to cause cancer, and chromium, which is known to the State of California to cause birth defects and/or reproductive harm. For more information go to www.P65Warnings.ca.gov.

Options

- Protective coating
- Prefabricated curbs
- Disconnect switch

Standard Models

BLADE SIZE	1-PHASE 115/230V	3-PHASE 208/230/460v	HP	RPM	C.F.M - STATIC PRESSURE				Db's @ 10'	WT. (LBS)	LIST			
					MFG MODEL NUMBER						TEC		EXP*	
					0"	1/8"	1/4"	1/2"			1 PH	3 PH	1 PH	3 PH
18"	UED18-1/4	UED18-1/4-3	1/4	1140	2570	2263	1673	854	66	170	5688	5711	6072	6402
	UED18-1/3	UED18-1/3-3	1/3	1725	3375	3000	2600	1400	75	175	5263	5252	6082	6257
	UED18-1/2	UED18-1/2-3	1/2	1725	4133	3938	3724	3132	76	180	5404	5382	6232	6385
	UED18-1	UED18-1-3	1	1725	4600	4375	4080	3000	77	190	6024	5894	6866	6931
24"	UED24-1/4	UED24-1/4-3	1/4	1725	5200	4200	2820	----	75	240	5885	5913	6272	6601
	UED24-3/4	UED24-3/4-3	3/4	1140	6900	6450	6265	3300	76	260	7125	6834	7942	7878
	UED24-1	UED24-1-3	1	1725	7425	7000	6350	5000	83	280	6425	6312	7275	7355
	-----	UED24-3-3	3	1725	10500	9800	9500	8700	85	295	-----	6778	-----	8055
30"	UED30-3/4	UED30-3/4-3	3/4	1140	10440	9750	8750	6000	79	310	7459	6969	8280	8225
	-----	UED30-1-3	1	870	10800	10100	9100	6360	74	330	-----	8102	-----	-----
	UED30-1 1/2	UED30-1 1/2-3	1.5	1140	10410	9686	8834	6420	81	325	10317	7638	-----	8697
	UED30-2	UED30-2-3	2	1140	14000	13750	12900	10450	82	335	12438	7823	-----	8954
	-----	UED30-3-3	3	1725	16000	15350	14700	12900	89	335	-----	7141	-----	8425
36"	UED36-2	UED36-2-3	2	1140	17620	16500	15200	12300	84	430	13835	9268	-----	10399
	-----	UED36-3-3	3	1140	20500	19500	18500	15850	85	455	-----	9828	-----	11685
	-----	UED36-5-3	5	1140	22600	21700	20500	19000	87	465	-----	10490	-----	12583
42"	UED42-2	UED42-2-3	2	1140	17964	17277	15326	12351	88	500	14775	10228	-----	11356
	-----	UED42-5-3	5	1140	28970	27960	26840	24200	89	500	-----	11402	-----	13491
48"	-----	UED48-3-3	3	1140	28600	26500	24400	20000	92	550	-----	12309	-----	13556
	-----	UED48-5-3	5	870	33000	31500	29750	25300	86	665	-----	14693	-----	-----
	-----	UED48-7 1/2-3	7.5	1140	37000	35100	32800	28000	94	740	-----	14760	-----	17425
	-----	UED48-10-3	10	1140	41000	39200	38300	35400	95	875	-----	15538	-----	18372
60"	-----	UED60-5-3	5	870	45200	41500	37000	26000	90	940	-----	19418	-----	-----
	-----	UED60-7 1/2-3	7.5	870	47000	45500	43600	38700	92	950	-----	20772	-----	-----

Note: Products listed in this section are custom built and subject to 100% cancellation/restocking charges

*Not all EXP motors are 208v capable

Dimensions

SIZE	MINIMUM ROOF HOLE SIZE (SQUARE)	WIND BAND OUTER DIMENSION	ROOF CURB OUTER DIMENSION (SQUARE)	WIND BAND HEIGHT
18"	28"	24"	33"	16"
24"	34"	30"	39"	19"
30"	40"	36"	45"	22"
36"	46"	42"	51"	25"
42"	52"	48"	57"	27"
48"	58"	54"	63"	30"
60"	70"	66"	75"	42"

Belt Drive Roof Ventilators

Features

- Standard blades are heavy gauge steel
- Totally enclosed motors
- 1-Phase motors are field convertible 115V/230V
- 3-Phase motors are field convertible 230V/460V
- Motors are set to lower voltage at factory unless a request is made at time of order to set them to the higher voltage
- Wind band is 18 gauge galvanized steel
- Galvanized steel butterfly damper with rubber stops and seals
- Size of the roof opening to be 6" larger than fan size (Wind Band O.D.) dimension
- 1 year limited warranty



WARNING: This product can expose you to chemicals including nickel which is known to the State of California to cause cancer, and chromium, which is known to the State of California to cause birth defects and/or reproductive harm. For more information go to www.P65Warnings.ca.gov.

Options

- Protective coating
- Prefabricated curbs
- Disconnect switch

Standard Models

BLADE SIZE	1-PHASE 115/230V	3-PHASE 208/230/460v	HP	RPM	C.F.M - STATIC PRESSURE				Db's @ 10'	WT. (LBS)	LIST	
					0"	1/8"	1/4"	1/2"			TEC	
	MFG MODEL NUMBER				1 PH	3 PH						
24"	UEB24-1/3	UEB24-1/3-3	1/3	780	4900	4222	2807	800	64	300	6393	6385
	UEB24-1/2	UEB24-1/2-3	1/2	980	6219	5716	5661	2600	66	305	6586	6563
	UEB24-3/4	UEB24-3/4-3	3/4	1140	7090	6648	6144	4413	71	310	6810	6691
30"	UEB30-1/2	UEB30-1/2-3	1/2	640	8507	7170	4486	1373	64	350	6892	6866
	UEB30-3/4	UEB30-3/4-3	3/4	770	10235	9192	7657	3833	66	360	7261	7131
	UEB30-1	UEB30-1-3	1	975	10668	9959	8626	5184	70	370	7734	7660
36"	UEB36-1/2	UEB36-1/2-3	1/2	530	10500	8821	5985	2084	66	360	8143	8120
	UEB36-3/4	UEB36-3/4-3	3/4	605	11985	10583	8563	4017	68	370	8601	8472
	UEB36-1	UEB36-1-3	1	665	13174	11932	10299	5729	70	390	8921	8888
	UEB36-1 1/2	UEB36-1 1/2-3	1.5	720	13660	12012	9579	5000	72	395	9289	9140
42"	UEB42-3/4	UEB42-3/4-3	3/4	435	14040	11530	7633	3311	67	455	9372	9243
	UEB42-1	UEB42-1-3	1	490	15429	13194	10438	4668	69	465	9766	9750
	UEB42-1 1/2	UEB42-1 1/2-3	1.5	550	17420	15421	13117	7289	71	470	10344	10191
	UEB42-2	UEB42-2-3	2	725	20653	19128	17503	11319	74	485	11083	10673
	-----	UEB42-3-3	3	830	23645	22296	20984	17290	79	495	-----	10826
48"	UEB48-3/4	UEB48-3/4-3	3/4	370	17339	13700	7389	2244	70	505	10840	10719
	UEB48-1	UEB48-1-3	1	410	19188	16078	10903	4037	71	520	11169	11090
	UEB48-1 1/2	UEB48-1 1/2-3	1.5	465	21731	19010	14991	7081	72	535	11362	11241
	UEB48-2	UEB48-2-3	2	520	24274	21943	19080	10125	74	545	12426	12046
	-----	UEB48-3-3	3	680	28150	25683	23615	16930	80	560	-----	12247
54"	UEB54-1	UEB54-1-3	1	410	23130	20588	17500	9600	73	870	15163	15033
	UEB54-1 1/2	UEB54-1 1/2-3	1.5	450	25400	22600	19300	10316	75	880	15506	15371
	UEB54-2	UEB54-2-3	2	480	27200	24312	20660	11010	76	890	15940	15586
	-----	UEB54-3-3	3	550	31213	28722	25830	15420	80	900	-----	16141
	-----	UEB54-5-3	5	660	37458	35238	32843	26538	82	920	-----	16317
60"	UEB60-1 1/2	UEB60-1 1/2-3	1.5	340	28068	23203	15624	8000	78	940	16502	16365
	UEB60-2	UEB60-2-3	2	390	32200	26710	17924	9380	80	960	16864	16518
	-----	UEB60-3-3	3	450	37183	32356	25324	15013	84	985	-----	17375
	-----	UEB60-5-3	5	540	44600	41232	35819	23237	86	1000	-----	17537

Note: Products listed in this section are custom built and subject to 100% cancellation/restocking charges

Dimensions

SIZE	MINIMUM ROOF HOLE SIZE (SQUARE)	WIND BAND OUTER DIMENSION	ROOF CURB OUTER DIMENSION (SQUARE)	WIND BAND HEIGHT
24"	34"	30"	39"	19"
30"	40"	36"	45"	22"
36"	46"	42"	51"	25"
42"	52"	48"	57"	27"
48"	58"	54"	63"	30"
54"	64"	60"	69"	36"
60"	70"	66"	75"	42"

Tubeaxial Direct Drive Duct Fans



Features

- Totally enclosed and explosion proof motors
- 1-Phase motors are field convertible 115V/230V
- 3-Phase motors are field convertible 230V/460V
- Motors are set to lower voltage at the factory unless a request is made at time of order to set them to the higher voltage
- Explosion proof motors are Class 1, Div 1, Group D and Class 2, Div 1, Groups F & G
- 14 gauge steel drum including mounting flanges
- Fan can be mounted to operate in any position
- Rugged cast aluminum blade, non-sparking
- 1 year limited warranty

Dimensions

SIZE	HOUSING I.NNER DIM.	HOUSING OUTER DIM.	BOLT HOLE CENTERS	HOUSING DEPTH
12"	12"	14"	13 1/8"	14"
18"	18"	20"	19 1/8"	14"
24"	24"	27"	25 3/4"	18"
27"	27"	30"	28 3/4"	18"
30"	30"	33"	31 3/4"	18"
34"	34"	37"	35 3/4"	18"
42"	42"	45"	43 9/16"	18"
48"	48"	51"	49 5/8"	18"

⚠ WARNING: This product can expose you to chemicals including nickel which is known to the State of California to cause cancer, and chromium, which is known to the State of California to cause birth defects and/or reproductive harm. For more information go to www.P65Warnings.ca.gov.

Options

- Companion flanges
- Fan guards
- Protective coating
- Access doors

Standard Models

BLADE SIZE	1-PHASE 115/230V	3-PHASE 230/460v	HP	RPM	BLADES	C.F.M - STATIC PRESSURE				Db's @ 10'	WT. (LBS)	LIST			
						MFG MODEL NUMBER						TEC		EXP	
						0"	1/4"	1/2"	3/4"			1 PH	3 PH	1 PH	3 PH
12"	TXD12-1/4	TXD12-1/4-3	1/4	1725	4	1180	520	----	----	77	40	2035	2014	2532	2617
	TXD12-1/2	TXD12-1/2-3	1/2	3450	4	1875	1400	1250	1100	82	45	2093	2086	2828	3146
	TXD12-3/4	TXD12-3/4-3	3/4	3450	6	2044	1920	1650	1500	83	45	2170	2170	3019	3251
18"	TXD18-1/4	TXD18-1/4-3	1/4	1725	4	3450	2500	----	----	74	55	2405	2382	2897	2981
	TXD18-1/3	TXD18-1/3-3	1/3	1725	6	3375	2600	1400	----	75	65	2523	2544	3166	3344
	TXD18-1/2	TXD18-1/2-3	1/2	1725	6	4150	3150	1700	----	77	65	2622	2636	3387	3309
	TXD18-1	TXD18-1-3	1	1725	6	4600	4080	3000	2100	80	70	2956	2812	3689	3752
24"	TXD24-1/4	TXD24-1/4-3	1/4	1725	2	5200	2820	----	----	80	95	2636	2622	3132	3151
	TXD24-1/3	TXD24-1/3-3	1/3	1140	6	4975	4250	2850	----	74	110	3173	3224	4329	4304
	TXD24-1/2	TXD24-1/2-3	1/2	1725	4	6510	5200	3100	1800	80	115	2914	2927	3676	3597
	TXD24-3/4	TXD24-3/4-3	3/4	1140	6	6900	6265	3300	----	74	125	3934	3500	4559	4415
	TXD24-1	TXD24-1-3	1	1725	6	7425	6350	5000	3300	82	120	3229	3082	3965	4030
	TXD24-2	TXD24-2-3	2	1725	6	9525	8810	7980	6960	84	120	3909	3329	5446	4422
	-----	TXD24-3-3	3	1725	6	10500	9500	8700	7800	86	130	----	3618	----	4784
27"	TXD27-1/2	TXD27-1/2-3	1/2	1725	4	7550	6000	4000	2000	86	125	3182	3188	3934	3857
	TXD27-1	TXD27-1-3	1	1725	4	9600	8400	7050	4800	86	155	3447	3309	4183	4247
	TXD27-2	TXD27-2-3	2	1725	6	11500	10700	9300	8000	86	165	4204	3626	5742	4720
30"	TXD30-1/2	TXD30-1/2-3	1/2	1725	4	8980	6300	4350	2300	86	130	3309	3322	4072	3993
	TXD30-3/4	TXD30-3/4-3	3/4	1140	6	10440	8750	6000	----	80	150	4447	4007	5073	4944
	TXD30-2	TXD30-2-3	2	1725	6	12000	10450	8700	6000	89	155	4325	3745	5864	4838
	-----	TXD30-3-3	3	1725	6	16000	14700	12900	10200	89	175	----	3915	----	5087
34"	TXD34-1 1/2	TXD34-1 1/2-3	1.5	1725	4	13350	10000	7300	----	88	175	4447	4261	6464	5350
	TXD34-2	TXD34-2-3	2	1725	4	14850	12100	8800	4000	89	200	4923	4346	6464	5442
	-----	TXD34-3-3	3	1140	3	19300	17230	14800	11614	86	250	----	5629	----	7107
	-----	TXD34-5-3	5	1725	6	21000	18900	17500	14850	91	220	----	4627	----	5915
36"	TXD36-2	TXD36-2-3	2	1140	6	17620	15200	12300	8500	84	210	----	4826	----	6085
	-----	TXD36-3-3	3	1725	4	18500	15700	13900	11500	89	230	----	5371	----	6845
42"	-----	TXD42-1-3	1	870	4	15800	13480	5800	900	81	270	----	5836	----	----
	TXD42-2	TXD42-2-3	2	1140	4	17964	15326	12351	7600	87	260	----	5497	----	6746
	-----	TXD42-3-3	3	1140	4	24500	23000	19650	14000	87	260	----	6159	----	7637
	-----	TXD42-5-3	5	1140	4	28970	26840	24200	19500	87	300	----	6387	----	8499
48"	-----	TXD48-3-3	3	1140	4	28600	24400	20000	15900	94	290	----	7680	----	9155
	-----	TXD48-5-3	5	870	4	33000	29750	25300	18000	86	500	----	9764	----	----

Duct Fan Guards

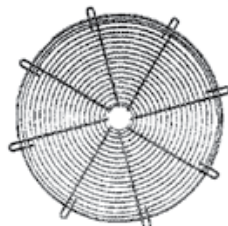

Features

- Enamel finish
 - Can be used as front or rear guards.
- (Rear guard for TXD models must be ordered with fan)

⚠ WARNING: This product can expose you to chemicals including nickel which is known to the State of California to cause cancer, and chromium, which is known to the State of California to cause birth defects and/or reproductive harm. For more information go to www.P65Warnings.ca.gov.

Standard Models

FAN SIZE	MFG MODEL	LIST	FAN SIZE	MFG MODEL	LIST
12"	TXG-12	174	30"	TXG-30	237
15"	TXG-15	174	34"	TXG-34	302
18"	TXG-18	174	36"	TXG-36	312
24"	TXG-24	190	42"	TXG-42	343
27"	TXG-27	237	48"	TXG-48	447

Note: Products listed in this section are custom built and subject to 100% cancellation/restocking charges

Tubeaxial Belt Drive Duct Fans

Features

- Eliminates fumes and vapors from paint spray booths and other hazardous areas
- Totally enclosed and explosion proof motors
- 1-Phase motors are field convertible 115V/230V
- 3-Phase motors are field convertible 230V/460V
- Motors are set to lower voltage at the factory unless a request is made at time of order to set them to the higher voltage
- Explosion proof motors are Class 1, Div 1, Group D and Class 2, Div 1, Groups F & G
- Recommended for most paint spray applications because motor is out of air
- 14 gauge steel drum including mounting flanges at each end
- Completely enclosed belt and ball bearing housing
- Adjustable motor base for proper belt tension
- Rugged cast aluminum blade, non-sparking
- Fan can be mounted to operate in any position
- 1 year limited warranty

WARNING: This product can expose you to chemicals including nickel which is known to the State of California to cause cancer, and chromium, which is known to the State of California to cause birth defects and/or reproductive harm. For more information go to www.P65Warnings.ca.gov.



Options

- Companion flanges
- Protective coating
- Access doors
- Belt guards
- Motor covers
- Fan guards

Standard Models

BLADE SIZE	1-PHASE 115/230V-60Hz		3-PHASE 230/460V-60Hz		HP	RPM	BLADES	C.F.M - STATIC PRESSURE				Db's @10'	WT (LBS)	LIST			
	MFG MODEL NUMBER							0"	1/4"	1/2"	3/4"			TEC		EXP	
	1 PH	3 PH	1 PH	3 PH				1 PH	3 PH	1 PH	3 PH						
12"	TXB12-1/4	TXB12-1/4-3	1/4	2625	4	1444	1033	380	----	77	62	2744	2729	3260	3345		
	TXB12-1/3	TXB12-1/3-3	1/3	2875	4	1586	1135	415	----	78	65	2799	2829	3471	3648		
	TXB12-1/2	TXB12-1/2-3	1/2	3450	4	1875	1400	1250	1100	83	65	2799	2799	3449	3741		
15"	TXB12-3/4	TXB12-3/4-3	3/4	3450	6	2044	1920	1650	1500	83	67	3048	3048	3684	3952		
	TXB15-1/4	TXB15-1/4-3	1/4	2000	6	2600	1700	----	----	77	67	3020	3006	3533	3619		
	TXB15-1/3	TXB15-1/3-3	1/3	2200	6	2950	2100	1000	----	78	69	3110	3134	3776	3952		
18"	TXB15-1/2	TXB15-1/2-3	1/2	1890	6	3350	2650	1500	----	76	75	3203	3217	3994	3910		
	TXB15-3/4	TXB15-3/4-3	3/4	2200	6	3900	3400	2700	1150	78	85	3485	3302	4277	4079		
	TXB18-1/4	TXB18-1/4-3	1/4	1600	6	3050	2000	----	----	76	80	3189	3175	3704	3789		
24"	TXB18-1/3	TXB18-1/3-3	1/3	1725	6	3375	2600	1400	----	77	85	3225	3273	3917	4094		
	TXB18-1/2	TXB18-1/2-3	1/2	1890	6	3850	3100	2000	----	78	95	3345	3359	4136	4051		
	TXB18-1	TXB18-1-3	1	1725	6	4600	4080	3000	2100	77	105	3816	3640	4543	4616		
27"	TXB18-1 1/2	TXB18-1 1/2-3	1.5	1990	6	5350	4830	3950	3000	80	105	3994	3809	6082	4936		
	TXB24-1/2	TXB24-1/2-3	1/2	1298	6	5643	4826	3500	----	78	120	3628	3640	4416	4331		
	TXB24-3/4	TXB24-3/4-3	3/4	1600	6	6906	5900	4650	2750	80	130	3961	3776	4749	4552		
30"	TXB24-1	TXB24-1-3	1	1725	6	7425	6350	5000	3300	84	140	3994	3839	4749	4822		
	TXB24-1 1/2	TXB24-1 1/2-3	1.5	1540	6	8200	7650	6850	5500	81	145	4855	4671	6933	5795		
	TXB24-2	TXB24-2-3	2	1600	6	9760	8830	8090	7000	82	170	5521	4927	7101	6049		
34"	-----	TXB24-3-3	3	1725	6	10500	9500	8700	7800	86	190	-----	5081	-----	6292		
	TXB27-3/4	TXB27-3/4-3	3/4	1250	6	8330	7550	6500	4650	78	150	4850	4658	5632	5443		
	TXB27-1	TXB27-1-3	1	1400	6	9400	8480	7300	5200	82	155	4878	4728	5632	5697		
36"	TXB27-1 1/2	TXB27-1 1/2-3	1.5	1600	6	10700	9700	8375	6000	84	170	5099	4912	7173	6027		
	TXB27-2	TXB27-2-3	2	1350	6	11500	10700	9300	8000	81	210	5684	5088	7273	6220		
	TXB30-1/2	TXB30-1/2-3	1/2	1140	4	8900	6660	2300	----	79	140	4585	4611	5378	5301		
42"	TXB30-1	TXB30-1-3	1	1298	6	9867	7980	4120	----	82	150	5088	4941	5844	5917		
	TXB30-1 1/2	TXB30-1 1/2-3	1.5	1035	6	11100	9700	7500	3500	78	165	5309	5123	7387	6249		
	TXB30-2	TXB30-2-3	2	1176	6	12100	11000	9322	6700	81	215	5809	5216	7399	6347		
48"	-----	TXB30-3-3	3	1350	6	13480	12498	11465	10380	84	215	-----	5563	-----	6763		
	-----	TXB30-5-3	5	1650	6	16440	15242	13982	12659	88	230	-----	5626	-----	6942		
	TXB34-1 1/2	TXB34-1 1/2-3	1.5	1170	6	13695	11100	6000	1015	82	190	6135	5954	8214	7069		
48"	TXB34-2	TXB34-2-3	2	1027	6	14657	12590	10000	8000	81	240	6834	6241	8418	7370		
	-----	TXB34-3-3	3	1175	6	17580	15896	14095	12000	85	260	-----	6404	-----	7605		
	-----	TXB34-5-3	5	1416	6	20500	19000	17500	16000	88	305	-----	6446	-----	7774		
48"	TXB42-1 1/2	TXB42-1 1/2-3	1.5	750	4	18960	14662	7200	----	78	250	7273	7308	9570	8425		
	TXB42-2	TXB42-2-3	2	820	4	20700	17002	11400	4000	80	260	7786	7429	9613	8553		
	-----	TXB42-3-3	3	890	4	23700	20200	16970	9950	82	260	-----	7582	-----	8783		
48"	-----	TXB42-5-3	5	850	6	26900	24403	22250	18400	82	270	-----	7979	-----	9302		
	-----	TXB48-5-3	5	800	6	33000	29000	25600	20000	85	375	-----	11828	-----	13153		
	-----	TXB48-7 1/2-3	7.5	900	6	37000	34500	31000	27000	87	520	-----	12564	-----	14792		

Dimensions

SIZE	HOUSING INNER DIMENSION	HOUSING OUTER DIMENSION	BOLT HOLE CENTERS	HOUSING DEPTH
12"	12"	14"	13 1/8"	12"
15"	15"	17"	16 1/8"	12"
18"	18"	20"	19 1/8"	12"
24"	24"	27"	25 3/4"	12" & 16"
27"	27"	30"	28 3/4"	16"
30"	30"	33"	31 3/4"	16"
34"	34"	37"	35 3/4"	16"
42"	42"	45"	43 1/16"	18"
48"	48"	51"	49 5/8"	24"

Note: Products listed in this section are custom built and subject to 100% cancellation/restocking charges

Attic Fans

Power Attic Mount Dome Ventilator



WARNING: This product can expose you to chemicals including nickel which is known to the State of California to cause cancer, and chromium, which is known to the State of California to cause birth defects and/or reproductive harm. For more information go to www.P65Warnings.ca.gov.

Features

- 120V Motor / 1-Phase
- Automatic thermostat (60°-120°F)
- Insect and bird screen installed
- Black or brown painted finish or mill finish
- Made in U.S.A.

Note: Photograph is a representation of stocked models. Actual model may vary in appearance

Standard Models

MFG CATALOG NUMBER	MFG MODEL NUMBER	DOMES COLOR	SPEED	CFM .03 SP	VOLTS	HP	RPM	ATTIC SIZE / SQ. FT.*	WT. (LBS)	LIST
08664202	PDV-305-1MB-GY-G	Mill	1	1000	120	1/12	1050	Average/1600	19	217
08664302	PDV-305-1MB-BR-G	Brown	1	1000	120	1/12	1050	Average/1600	19	
08664402	PDV-305-1MB-BLK-G	Black	1	1000	120	1/12	1050	Average/1600	19	

*@ 4:12 Pitch Roof

Gable Exhaust Fan



Damper requires 16 1/2 x 16 1/2 opening



WARNING: This product can expose you to chemicals including nickel which is known to the State of California to cause cancer, and chromium, which is known to the State of California to cause birth defects and/or reproductive harm. For more information go to www.P65Warnings.ca.gov.

Features

- 120V motor / 1-Phase
- Automatic adjustable thermostat (60°-120°F)
- Partially assembled (mounting tabs must be assembled)
- 14" blade diameter
- 4 mounting tabs on 16" centers
- Made in U.S.A.

Standard Models

MFG CATALOG NUMBER	MFG MODEL NUMBER	DESCRIPTION	CFM .03 SP	ATTIC SIZE/ SQ. FT.*	WT. (LBS)	LIST
08663702	GV-405-2B-G	Gable Mount Ventilator	1540	Average/2400	13	169
08665202	AGD-1416B-G	White Aluminum Damper for GV-405-2	----	----	3	98

*@ 4:12 Pitch Roof

Belt Drive Wholehouse Fans



WARNING: This product can expose you to chemicals including nickel which is known to the State of California to cause cancer, and chromium, which is known to the State of California to cause birth defects and/or reproductive harm. For more information go to www.P65Warnings.ca.gov.

Features

- 120V, 1-Phase, 2-Speed motors
- Shutters automatically open when fan is turned on and close tightly when fan is turned off
- Made in U.S.A.

NOTE: Belt Drive Fan with "No Joist Cut" Shutter

Standard Models

MFG CATALOG NUMBER	MFG MODEL NUMBER	SIZE	SPEED	MOTOR HP	CFM @ .1 IN. H2O PRESSURE DROP w/ SHUTTER	FAN SPEED RPM	FAN MOUNTING DIMENSIONS (IN)			EXHAUST SQ. FT. REQ'D	AMPS	WT. (LBS)	LIST
							A	B	C				
07936202	BD24-2-WHS	24"	2	1/3	4500/2700	612/410	28	29.5	14.5	7	5.7/4.8	40	984
07936302	BD30-2-WHS	30"	2	1/3	7600/5800	520/350	34	35.5	14.5	9	6.9/5.5	50	1057
07936402	BD36-2-WHS	36"	2	1/3	9675/6400	395/265	40	41.5	14.5	12	6.3/3.1	64	1162

Fan Dimensions

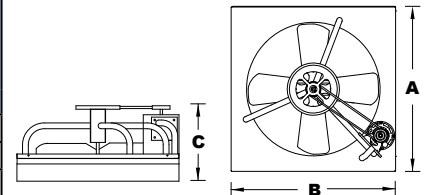

Ceiling Shutters

MFG CATALOG NUMBER	MFG MODEL NUMBER	FIT HOLE SIZE (I.D.)	OUTSIDE SIZE (O.D.)	FAN SIZE	WT. (LBS)	LIST
07944802	CS-10-W	26X26	28X28	24"	8	174
07944602	CS-13-W	32X34	34X36	30"	10	182
07945302	CS-14-W	34X34	36X36	30"	10	191
07944702	CS-18-W	32X43	34X45	36"	11	207
07945202	CS-19-W	34X43	36X45	36"	11	224

"Joist out style" (For replacement only)

Control Options

MFG CATALOG NUMBER	MFG MODEL NUMBER	DESCRIPTION	WT. (LBS)	LIST
07927002	2-SW	2 Speed wall switch & plate	1	49
05000802	1A22-7	SP Close on rise (Attic Thermostat) (80°-130°F)	1	59

WARNING: This product can expose you to chemicals including nickel which is known to the State of California to cause cancer, and chromium, which is known to the State of California to cause birth defects and/or reproductive harm. For more information go to www.P65Warnings.ca.gov.

Portable Utility Lights

HOW TO ORDER

1. Select your Light Head Source (LED or Quartz)
2. Select the # of Light Heads (one or two)
3. Select your Base or Mount

All items shipped in individual cartons.

Styles of Light Sources



LED-37-1



LED-37-2



QH-2

LED

- Lexan housing with safety tempered glass front lens cover
- Black finish, NEMA 4 rated enclosure with push button on/off switch
- Each shade size is 7-3/4" wide x 10" high x 3-3/4" deep
- 120V, 3,680-Lumens, 3,000K, 30,000+ hour lamp life
- 15' long, 18/3 SJT, 120V cordset with NEMA 15-5 grounded plug
- Compliant with RoHS 2 Directive (2011/65/EU), that of which includes the application exemptions outlined in Annex III of the directive. ETL C/US Listed.



Quartz Halogen

- QH model includes (2) 500 Watt quartz halogen bulbs and weatherproof die cast aluminum light heads with impact resistant lens
- Black finish, weatherproof aluminum die-cast light heads
- Includes: On/Off switch, aiming handle, adjustment knob & steel yoke
- Each shade size is 9" wide x 7-1/4" high x 9-3/4" deep
- 120V, 3,680-Lumens, 3,000K, 30,000+ hour lamp life
- 15' long, 18/3 SJT, 120V cordset with NEMA 15-5 grounded plug
- ETL C/US listed for indoor & semi-protected outdoor use

5 Types of Bases and Mounts

Pedestal Base



PED

- 16 gauge round steel tube construction
- Height adjustable from 5'- 6" to 8'- 6" high
- 18" heavy duty steel base

Cart Base

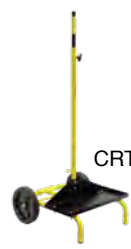

CRT

- 16 gauge round steel tube construction
- Height adjustable from 5' to 8' high
- 10" diameter wheels

Floor Base



FLR

- 12 gauge steel base
- Handle included
- Base covers 16" diameter area

Clamp-On Mount



CLP

- Clamp secures light head to most surfaces up to 3"

Magnet Mount



MAG

- 210 lb. magnetic strength
- 1/4" steel arm
- Extends 6" from mounting surface

Standard Models

Complete Unit Examples:



Light Source:
Model #: **LED-37-2**
plus
Base Model #: **CRT**

MFG CATALOG NUMBER	MFG MODEL NUMBER	TYPE	DESCRIPTION	TOTAL MAX WATTS	NUMBER OF LIGHT HEADS	WT. (LBS)	LIST
04885402	LED-37-1	LIGHT HEAD SOURCE	LED	37	1	6	417
04885302	LED-37-2			74	2	10	844
04803302	QH-2		QUARTZ HALOGEN	1000	2	10	267
04802702	PED	MOUNT/BASE	PEDESTAL	---	---	31	349
04802802	CRT		CART	---	---	27	303
04802602	FLR		FLOOR	---	---	4	98
04802402	CLP		CLAMP	---	---	2	54
04802502	MAG		MAGNET	---	---	3	65



M-LED-37-1



F-LED-37-1

Ordering Notes:

- All items shipped in individual cartons.
- Models FLR, CLP & MAG will only support 1-Light Head.
- LED37-1 cannot be used with model CLP.

WARNING: This product can expose you to chemicals including nickel which is known to the State of California to cause cancer, and chromium, which is known to the State of California to cause birth defects and/or reproductive harm. For more information go to www.P65Warnings.ca.gov.

Heavy Duty Portable Utility Lights

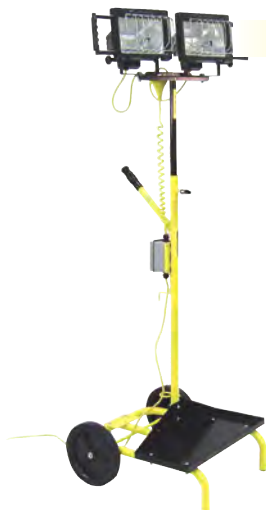

PUL-1000Q-CD

Quartz Halogen Light Heads

- (2) 500 Watt weatherproof die cast Aluminum light heads with 15' long, 3-conductor cord, and plug
- Quartz halogen lamps
- Impact resistant lens
- On-Off switch
- OSHA approved wire guards and bulb included with each light head
- Made in U.S.A. with domestic and foreign components.

WARNING: This product can expose you to chemicals including nickel which is known to the State of California to cause cancer, and chromium, which is known to the State of California to cause birth defects and/or reproductive harm. For more information go to www.P65Warnings.ca.gov.



PUL-1000Q-TC

Cart Light Stand With GFCI Features

- Upright adjust from 5' to 8' high
- 10" diameter rubber wheels
- 15' all-weather, water and oil resistant SJTW 18/3 cordset and molded NEMA 5-15 plug
- Weatherproof electrical box with a 15 Amp GFCI duplex receptacle

Tripod Light Stand Features

- Square 12 gauge steel tubing construction
- Adjustable legs fold up for storage, fold flat for sand bagging or can be set and locked at 6", 12", 18", or 24" ground clearances
- Height adjustable from 5' to 11' high
- Safety stop mechanism, at full extension, prevents the mast from being pulled out of the base
- 15' all-weather, water and oil resistant SJTW 18/3 cordset and molded NEMA 5-15 plug

Standard Models

MFG CATALOG NUMBER	MFG MODEL NUMBER	BASE TYPE	BULBS	WATTS	VOLTS	MAX LUMENS	AVE. BULB LIFE (HRS)	WT. (LBS)	LIST
04467802	PUL-1000Q-CD	CART	500W Quartz Halogen	1000	120	22,000	2,000	50	847
04468302	PUL-1000Q-TC	TRIPOD						41	895
04843102	TRI-HD	Heavy Duty Tri-Pod Sold Separately. Will Accommodate all TPI Light Heads.							595

Commercial Duty Portable Utility Lights

CL 300 (Clamp on Model)



WARNING: This product can expose you to chemicals including nickel which is known to the State of California to cause cancer, and chromium, which is known to the State of California to cause birth defects and/or reproductive harm. For more information go to www.P65Warnings.ca.gov.

Features

- Ceramic socket will accept incandescent bulbs A-19, R-40 or PAR bulbs up to 300 Watt. Fixture will also accept infrared heat lamps up to 250 Watts
- LED bulb included
- 8' long - 18/3 SPT cordset with NEMA 5-15 plug
- Imported to TPI specifications.

Standard Models

MFG CATALOG NUMBER	MFG MODEL NUMBER	BASE TYPE	DESCRIPTION	MAX. WATTS	VOLTS	MAX LUMENS	AVE. BULB LIFE HOURS	WT. (LBS)	LIST
02804900	CL-300	CLIP-ON	LED	9	120	800	25,000	3	89

CL-300 is shipped in ONE carton. LED bulb included

Loading Dock Lights - Shipped in 1-Carton

Light Head Features

- Chip resistant safety yellow & black powder coating finish for high visibility and durability
- 5' long 18/3 SJT, 120V cordset with NEMA 15-5 grounded plug
- On/Off switch & wire guard included on each light head
- 1-1/2" square, 11-gauge, steel tubing
- 3" x 5" x 3/16" mounting plate attached with (4) 3/8" bolts (not supplied)
- VA & DKLED models have vertical adjustment bracket allowing outer arm to adjust from 300° horizontally and 210° vertically
- All light heads will swivel 300°
- VA Models include an embedded electrical outlet for direct plug connection from the light head fixture and shipped fully-assembled
- DKLED units contain a die-cast aluminum light head with adjustable knobs, built-in on/off switch, and maintains an IP65 rating suitable for wet locations
- DKLED units use a 20° custom beam angle and 12 individual high-intensity LED emitters generating a neutral white color; with a CCT measuring 4,000K DKLED units provide a minimum life of 50,000 hours and offers a 5-year warranty, including CE & RoHS Certificates
- Designed for loading dock and work station environments
- ETL C/US Listed for indoor applications only, except QH models are semi-protected outdoor and DKLED models have IP65 rating suitable for wet location areas



Flexible elastomer arm moves when hit and then returns light to original position



LED 30-Watt



WARNING: This product can expose you to chemicals including nickel which is known to the State of California to cause cancer, and chromium, which is known to the State of California to cause birth defects and/or reproductive harm. For more information go to www.P65Warnings.ca.gov.

Standard Models (120V)

MFG CATALOG NUMBER	MFG MODEL NUMBER	ARM LENGTH	# OF ARMS	MAX WATTS	WT. (LBS)	LIST
NO BULB						
04466502	DKL-40VA-A	40"	2	Maximum 300	14	247
04466602	DKL-60VA-A	60"	2		17	296
03854001	DKL-25-FLX	25"	1		17	261
LED - 3,300 Lumens, 4,000K CCT, 50,000-hour Avg. Bulb Life						
04922802	DKLED-40-30W	40"	2	30	13	370
04922902	DKLED-42-30W	42"	3		14	390



Loading Dock Lights - Modular (shipped in multiple cartons)

Modular Lights



DKL-INC



DKL-LED37



DKL-QH



DKL-LED-30W-SP



DKLED-30W-WP

Features

- 14" long, 18/3 conductor cord plugs into electrical junction box on arm
- On/Off switch & wire guard included with each light head
- Bulb included with all light heads except DKL-INC
- Imported to TPI specifications.
- DKL-LED-37 is compliant with ROHS 2 Directive (2011/65/EU), that of which includes the application exemptions outlined in Annex III of the directive.



WARNING: This product can expose you to chemicals including nickel which is known to the State of California to cause cancer, and chromium, which is known to the State of California to cause birth defects and/or reproductive harm. For more information go to www.P65Warnings.ca.gov.

Standard Models

MFG CATALOG NUMBER	MFG MODEL NUMBER	LIGHT HEAD TYPE	MAX WATTS	MAX LUMENS	AVE. BULB LIFE (HRS)	WT. (LBS)	LIST
04465602	DKL-INC	No Bulb Included	300	3,700	2,000	5	98
04465702	DKL-QH	Quartz Halogen	500	11,000	2,000	6	147
04881302	DKL-LED-37	LED	37	2,373	>30,000	5	393
04923002	DKLED-30W-WP	LED w/ Pin Connector Plug	30	3,300	50,000	7	280
04923102	DKLED-30W-SP	LED w/ Grounded Plug	30	3,300	50,000	7	280

Mounting Arms



DKL-40VA-ARM



60-LDA



24-LDA



The outer arm on 40VA & 60VA arms will swing 300° in horizontal plane & 210° in vertical plane

Features

- 1 1/2" square, 11 gauge, steel tubing
- 3" x 5" x 3/16" mounting plate attaches with (4) 3/8" bolts
- 5' long, 18/3 SJTW conductor cord and NEMA 5-15 grounded plug
- Made in U.S.A.

WARNING: This product can expose you to chemicals including nickel which is known to the State of California to cause cancer, and chromium, which is known to the State of California to cause birth defects and/or reproductive harm. For more information go to www.P65Warnings.ca.gov.

Standard Models

MFG CATALOG NUMBER	MFG MODEL NUMBER	ARM LENGTH	TOTAL # OF ARMS	WT. (LBS)	LIST
04465402	DKL-40VA-ARM	40"	2	18	153
04465502	DKL-60VA-ARM	60"	2	24	194
04465302	24-LDA	24"	1	11	120
04466102	40-LDA**	40"	3	18	207
04466202	60-LDA**	60"	3	24	240

**Indicates heavy duty dock arms (Horizontal swing only, no vertical movement)

Loading Dock Arm Fan



Features

- 18" high velocity circulator, with 3 speed, 1/8 HP, 115V, 1 phase permanently lubricated, totally enclosed, PSC motor
- Modular fan plugs into electrical outlet on arm
- Coated steel guards and aluminum blades
- Imported to TPI specifications

WARNING: This product can expose you to chemicals including nickel which is known to the State of California to cause cancer, and chromium, which is known to the State of California to cause birth defects and/or reproductive harm. For more information go to www.P65Warnings.ca.gov.

Standard Models

MFG CATALOG NUMBER	MFG MODEL NUMBER	CFM			VELOCITY PROFILE MAX. CFM	AMPS HIGH	WT. (LBS)	LIST
		HIGH	MED	LOW				
07971802	LDF-18-TE	1800	1500	1300	2900	2.2	20	238

Note: Must be used with LDA (Heavy Duty) mounting arms

Machine Tool Lights

Water Resistant Fluorescent or LED Tube Lights



WARNING: This product can expose you to chemicals including nickel which is known to the State of California to cause cancer, and chromium, which is known to the State of California to cause birth defects and/or reproductive harm. For more information go to www.P65Warnings.ca.gov.

Features

- ETL C/US Listed for NEMA Type 13 applications - oil / water / coolant spray areas (not submersible) and dusty atmospheres
- Available with a durable, lightweight, economical, shatter resistant polycarbonate tube housing
- Model 21-TLP-IB-C includes a remote ballast, cordset, and on/off switch
- Stainless steel mounting hardware and fluorescent or LED bulb are included
- 8' long, 18/3 SJTOW cord with NEMA 5-15 plug on models with cords
- EOB units with internal ballast are factory wired for 120V w/ 8' long cordset. Units can be field converted for direct wiring for 90V to 277V. Terminal block provided for easy wire installation.
- Made in U.S.A.

Standard Models

MFG CATALOG NUMBER	MFG MODEL NUMBER	DESCRIPTION	WATTS	VOLTS	LUMENS	OVERALL LENGTH	TUBE MATERIAL	BALLAST INCLUDED	WT. (LBS)	LIST
02823200	21-TLP-IB-C	REMOTE BALLAST WITH CORDSET	36	120V	2900	21"	Polycarbonate	Yes	10	641
04829502	29-TLP-EOB-C	INTERNAL BALLAST WITH CORDSET	36	90 to 277V	2900	29"	Polycarbonate	Yes	7	542
04843402	29-TLP-A*	REMOTE BALLAST	50	120V	4300	29"	Polycarbonate	Yes	7	575
04829302	23-TLP-24VDC**	INTERNAL BALLAST	18	24VDC***	1250	23"	Polycarbonate	Yes	6	503
04891802	21-LEDTLP-120-16	LED WITH NO BALLAST	16	120V	1200	21"	Polycarbonate	No	3.44	575
04891902	29-LEDTLP-120-26	LED WITH NO BALLAST	26	120V	2800	29"	Polycarbonate	No	2.66	641

* Not ETL Listed / ** Not ETL Listed Low Voltage / *** Includes 2 ft. lead wires

Notes:

LED lights comply with part 15 of the FCC rule.
 LED Machine Tool Light 29" CFL equivalent is 40 watts.
 LED Machine Tool Light 21" CFL equivalent is 36 watts.

Accessories - Replacement Lamps

MFG CATALOG NUMBER	MFG MODEL NUMBER	DESCRIPTION	USED WITH	WT. (LBS)	LIST
3103300	TL-RB-18	Fluorescent Replacement Bulb, 18W, PL-L	All 18 Watt Models	1	76
3100800	TL-RB-36	Fluorescent Replacement Bulb, 36W, PL-L	All 36 Watt Models	1	81
3108200	TL-RB-50	Fluorescent Replacement Bulb, 50W, PL-L	All 50 & 100 Watt Models	1	90

Heavy Duty Machine Tool Lights

120V LED - Disc & Collar Task Lights



66-VCX-701B

WARNING: This product can expose you to chemicals including nickel which is known to the State of California to cause cancer, and chromium, which is known to the State of California to cause birth defects and/or reproductive harm. For more information go to www.P65Warnings.ca.gov.

Features

- Patented disc and collar swivel joints with adjustable bar knobs for securing arms into a variety of positions
- Shades constructed of a 22 Gauge steel and arms made of 5/8" steel tubing, with reach from 29" to 38"
- Charcoal gray powder coated finish
- Horizontal or vertical bolt down mounting bracket
- 10 amp rocker type on-off switch and lamp socket
- Includes an 8' 18/3 SJTO Cordset with NEMA 5-15 molded grounded plug
- 120V, 11-watt LED bulb included, 800-Lumens, 2700K CCT, 25,000-hour Avg. Bulb Life, A-19 screw base
- LED bulb included
- Made in U.S.A.

Standard Models

MFG CATALOG NUMBER	MFG MODEL NUMBER	BULB TYPE	BULB DESCRIPTION	WATTS	MAX LUMENS	AVE. BULB LIFE (HRS)	OVER-ALL REACH	WT. (LBS)	LIST
03813101	66-VCX-701B	LED	2700K, 800-Lumens	11	800	25,000	38"	6	279

Note: 66-VCX-701B is not included in the ETL C/US List

120V LED - Flexible Arm Machine Tool Light



12-R-M-3

WARNING: This product can expose you to chemicals including nickel which is known to the State of California to cause cancer, and chromium, which is known to the State of California to cause birth defects and/or reproductive harm. For more information go to www.P65Warnings.ca.gov.



Features

- 12" chrome plated flexible arm
- 3-1/2" magnet base
- Aluminum shade with black finish and white interior finish for maximum light performance
- On/Off turn knob located on the top of the shade
- LED 8-watt, 540-lumens, 4000K, bulb included
- 120V, 8' long 18/3 black cordset with molded plug
- Shipped fully assembled

Standard Models

MFG CATALOG NUMBER	MFG MODEL NUMBER	BULB	BASE	MAX LUMENS	OVER-ALL REACH	WT. (LBS)	LIST
04423002	12-R-M-3	8 Watt	Magnetic Base	540	12"	3	190

120V Fluorescent - Magnifier Task Light



45-MAG-W



WARNING: This product can expose you to chemicals including nickel which is known to the State of California to cause cancer, and chromium, which is known to the State of California to cause birth defects and/or reproductive harm. For more information go to www.P65Warnings.ca.gov.

Features

- 5", 8-diopter (3X power) magnifying clear lens for 200% magnification of an object with a focal length of 5"
- Suspension spring balanced arm assembly allowing up to 45" reach, with finger tighten control knobs to lock arms and shade into position
- 6' cordset with 2 prong polarized plug
- Housing consists of a sturdy white plastic 8 1/2" shade with an on-off rocker switch and glare protection cover located on the top of the shade
- Includes die-cast clamp-on base to attach to a flat surface up to 2 1/2" thick
- Factory installed 22W, 120V, T-9 deluxe cool white circline fluorescent lamp and protective lens
- Imported to TPI specifications

Standard Models

MFG CATALOG NUMBER	MFG MODEL NUMBER	MAGNIFICATION POWER	BULB	WATTS	MAX LUMENS	AVE. BULB LIFE (HRS)	OVER-ALL REACH	WT. (LBS)	LIST
04851502	45-MAG-W	3X	22W. Circline	22	1800	16,000	45"	10	289
3120300	MAG-22W	22W., 120V., T-9 deluxe cool white circline replacement lamp						1	39

Product Index Listing

MODEL	PAGE	MODEL	PAGE	MODEL	PAGE	MODEL	PAGE
12-R-M-3	48	BD24-2-WHS	42	CE 18-DV	26	CES-30	27
1A22-7	42	BD30-2-WHS	42	CE 20-D	25	CES-30G	25, 26
2-SW	42	BD36-2-WHS	42	CE 20-DS	24	CES-36	27
21-LEDTLP-120-16	47	CACU 20-P	8	CE 20-DV	26	CES-42	27
29-LEDTLP-120-26	47	CACU 20-W	8	CE 24-D	25	CES-48	27
21-TLP-IB-C	47	CACU 24-P	8	CE 24-DS	24	CESM-24	33
23-TLP-24VDC	47	CACU 24-PO	8	CE 24-DV	26	CESM-30	33
24-LDA	46	CACU 24-W	8	CE 30-D	25	CESM-36	33
24-LDF-TE	21	CACU 24-WO	8	CE 30-DS	24	CESM-42	33
29-TLP-A	47	CACU 30-P	8	CE 30-DV	26	CESM-48	33
29-TLP-EOB-C	47	CACU 30-P-HD	8	CE-24B	27	CESM-60	33
40-LDA	46	CACU 30-PO	8	CE-24B-3	27	CF-12	20
40-LDF-TE	21	CACU 30-PO-HD	8	CE-30B	27	CF-18	20
45-MAG-W	48	CACU 30-W	8	CE-30B-3	27	CF-20	20
60-LDA	46	CACU 30-WO	8	CE-36B	27	CL-300	44
60-LDF-TE	21	CAS - 18	16	CE-36B-3	27	CLP	43
66-VCX-701B	48	CAS - 48	16	CE-42B	27	CPB 30-D	9
ACH 20	3	CBT-24B	31	CE-42-B-3	27	CPB 36-B	9
ACH 20-O	3	CBT-24B-3	32	CE-48B	27	CPB 36-D	9
ACH 24	3	CBT-30B	32	CE-48-B-3	27	CPB 42-B	9
ACH 24-EX1	5	CBT-30B-3	32	CEFP-12	35	CPB 48-B	9
ACH 24-EX3	5	CBT-36B	32	CEFP-16	35	CPBS 24-DHV	9
ACH 24-O	3	CBT-36B-3	32	CEFP-18	35	CPBS 30-D	9
ACH 24-TE3	5	CBT-42B	32	CEFP-20	35	CRT	43
ACH 30-TE3	5	CBT-42B-3	32	CEFP-24	35	CS-10-W	42
ACH 30	3	CBT-48B	32	CEFP-30	35	CS-13-W	42
ACH 30-EX1	5	CBT-48B-3	32	CEFP-36	35	CS-14-W	42
ACH 30-EX3	5	CD-18	36	CEFP-42	35	CS-18-W	42
ACH 30-O	3	CD-24	36	CEFP-48	35	CS-19-W	42
ACM-C	6	CD-30	36	CEFP-60	35	DKL-25-FLX	45
ACM-I	6	CD-36	36	CES 12-HD	33	DKL-40VA-A	45
ACM-P	6	CD-42	36	CES 16-HD	33	DKL-40VA-ARM	46
ACM-PM	6	CD-48	36	CES 18-HD	33	DKL-60VA-A	45
ACM-S	6	CD-54	36	CES 20-HD	33	DKL-60VA-ARM	46
ACM-W	6	CD-60	36	CES 24-HD	33	DKL-INC	21, 46
ACM-WK	6	CE 10-D	25	CES 30-HD	33	DKLED-30W-WP	46
ACU 20-P	4	CE 10-DS	24	CES 36-HD	33	DKLED-30W-SP	46
ACU 20-PO	4	CE 10-DV	26	CES 42-HD	33	DKLED-40-30W	45
ACU 20-W	4	CE 12-D	25	CES 48-HD	33	DKLED-42-30W	45
ACU 20-WO	4	CE 12-DS	24	CES 54-HD	33	DKL-LED-37	46
ACU 24-P	4	CE 12-DV	26	CES 60-HD	34	DKL-QH	21, 46
ACU 24-PO	4	CE 14-D	26	CES-10G	25, 26	DMKP1	35
ACU 24-W	4	CE 14-DS	24	CES-12G	25, 26	DMKP2	36
ACU 24-WO	4	CE 14-DV	26	CES-14G	25, 26	DR36	24
ACU 30-P	4	CE 16-D	25	CES-16G	25, 26	E-56CF	23
ACU 30-PO	4	CE 16-DS	24	CES-18G	25, 26	E-60CF	23
ACU 30-W	4	CE 16-DV	26	CES-20G	25, 26	E-60CFC	23
ACU 30-WO	4	CE 18-D	25	CES-24	27	EHB24-1	31
AGD-1416B-G	42	CE 18-DS	24	CES-24G	25, 26	EHB24-1-3	31

MODEL	PAGE	MODEL	PAGE	MODEL	PAGE	MODEL	PAGE
EHB24-1/2	31	EHB48-2	31	EHD30-2-3	30	HDH 24	2
EHB24-1/2-3	31	EHB48-2-3	31	EHD30-3-3	30	HDH 24-G	3
EHB24-1/4	31	EHB48-3-3	31	EHD30-3/4	30	HDH 24-GJR	3
EHB24-1/4-3	31	EHB48-3/4	31	EHD30-3/4-3	30	HDH 24-JR	2
EHB24-3/4	31	EHB48-3/4-3	31	EHD36-1	30	HDH 30	2
EHB24-3/4-3	31	EHB48-5-3	31	EHD36-1-3	30	HDH 30-G	3
EHB30-1	31	EHB60-1	31	EHD36-2-3	30	HDH 30-GJR	3
EHB30-1 1/2	31	EHB60-1 1/2	31	EHD36-3-3	30	HDH 30-JR	2
EHB30-1 1/2-3	31	EHB60-1 1/2-3	31	EHD36-5-3	30	HDH 36	3
EHB30-1-3	31	EHB60-1-3	31	EHD42-1-3	30	HDM-C	6
EHB30-1/2	31	EHB60-2	31	EHD42-2	30	HDM-I	6
EHB30-1/2-3	31	EHB60-2-3	31	EHD42-2-3	30	HDM-P	6
EHB30-1/3	31	EHB60-3-3	31	EHD42-3-3	30	HDM-W	6
EHB30-1/3-3	31	EHB60-5-3	31	EHD42-5-3	30	HV-1	15
EHB30-1/4	31	EHD12-1/4	30	EHD48-3-3	30	HV-2	15
EHB30-1/4-3	31	EHD12-1/4-3	30	EHD48-5-3	30	HV-3	15
EHB30-3/4	31	EHD16-1/4	30	EHD60-10-3	30	HV-4-18	15
EHB30-3/4-3	31	EHD16-1/4-3	30	EHD60-3-3	30	HV-4-24	15
EHB36-1	31	EHD18-1/2	30	EHD60-5-5	30	HV-4-30	15
EHB36-1 1/2	31	EHD18-1/2-3	30	EHD60-7 1/2-3	30	HV-5-18	15
EHB36-1 1/2-3	31	EHD18-1/3	30	EMF-12	34	HV-5-24	15
EHB36-1-3	31	EHD18-1/3-3	30	EMF-16	34	HV-5-30	15
EHB36-1/2	31	EHD20-1	30	EMF-20	34	HV-6-18	15
EHB36-1/2-3	31	EHD20-1-3	30	EMF-24	34	HV-6-24	15
EHB36-1/3	31	EHD20-1/2	30	EMF-30	34	HV-6-30	15
EHB36-1/3-3	31	EHD20-1/2-3	30	EMF-36	34	HV-7-DC-1	15
EHB36-2	31	EHD20-1/4	30	EMF-42	34	HV-7-DC-3	15
EHB36-2-3	31	EHD20-1/4-3	30	EMF-48	34	HV-8	15
EHB36-3/4	31	EHD24-1	30	EMF-60	34	HV18-120V	15
EHB36-3/4-3	31	EHD24-1-3	30	F-12-TE	18	HV18-208/240V	15
EHB42-1	31	EHD24-1/2	30	F-18-CR	18	HV18-277V	15
EHB42-1 1/2	31	EHD24-1/2-3	30	F-18-TE	18	HV18-480V	15
EHB42-1 1/2-3	31	EHD24-1/3	30	F-18H-CR	18	HV24-120V	15
EHB42-1-3	31	EHD24-1/3-3	30	F-18H-TE	18	HV24-208/240V	15
EHB42-1/2	31	EHD24-1/4	30	F-24-CR	18	HV24-277V	15
EHB42-1/2-3	31	EHD24-1/4-3	30	F-24-TE	18	HV24-480V	15
EHB42-1/3	31	EHD24-2	30	F-24-TE-HV	18	HV30-120V	15
EHB42-1/3-3	31	EHD24-2-3	30	F-24H-CR	18	HV30-208/240V	15
EHB42-2	31	EHD24-3-3	30	F-24H-TE	18	HV30-277V	15
EHB42-2-3	31	EHD24-3/4	30	FLR	43	HV30-480V	15
EHB42-3-3	31	EHD24-3/4-3	30	FLS-18	35	HV18-480V-3	15
EHB42-3/4	31	EHD30-1 1/2	30	FLS-24	36	HV24-480V-3	15
EHB42-3/4-3	31	EHD30-1 1/2-3	30	FLS-30	36	HV30-480V-3	15
EHB48-1	31	EHD30-1-3	30	FLS-36	36	IBG-12	34
EHB48-1 1/2	31	EHD30-1/2	30	FLS-42	36	IBG-16	34
EHB48-1 1/2-3	31	EHD30-1/2-3	30	FLS-48	36	IBG-18	34
EHB48-1-3	31	EHD30-1/3	30	FLS-54	36	IBG-20	34
EHB48-1/2	31	EHD30-1/3-3	30	FLS-60	36	IBG-24	34
EHB48-1/2-3	31	EHD30-2	30	GV-405-2B-G	42	IBG-30	34

Product Index Listing

MODEL	PAGE	MODEL	PAGE	MODEL	PAGE	MODEL	PAGE
IBG-36	34	IE48-3/4-3	29	MCD30-1	16, 17	PBS 42-B-3	11
IBG-42	34	IE48-5-3	29	MCD30-1 1/2	16, 17	PBS 42-B-HL	11
IBG-48	34	IE60-2	29	MCD30-1/2	16, 17	PBSX 42-D	10
IBG-60	34	IE60-2-3	29	MCD30-1/3	16, 17	PBSX 48-B	11
IE24-1	29	IE60-3-3	29	MCD30-2	16, 17	PBS 48-B-3	11
IE24-1-3	29	IE60-5-3	29	MCD30-3	16, 17	PBS 48-B-HL	11
IE24-1/2	29	IED12-1/4	28	MCD30-3/4	16, 17	PBS 48-D-OP	10
IE24-1/2-3	29	IED12-1/4-3	28	MCD36-1	16, 17	PCBT 36-B	13
IE24-1/3	29	IED16-1/3	28	MCD36-1 1/2	16, 17	PCBT 42-B	13
IE24-1/3-3	29	IED16-1/3-3	28	MCD36-2	16, 17	PCBT 48-B	13
IE24-3/4	29	IED18-1/2	28	MCD36-3	16, 17	PDV-305-1MB-BLK-G	42
IE24-3/4-3	29	IED18-1/2-3	28	MCD36-5	16, 17	PDV-305-1MB-BR-G	42
IE30-1	29	IED20-3/4	28	MCD42-2	16	PDV-305-1MB-GY-G	42
IE30-1-3	29	IED20-3/4-3	28	MCD42-5	16	PED	43
IE30-1/2	29	IED24-1	28	MCD48-10	16	PM-1	19
IE30-1/2-3	29	IED24-1-3	28	MCD48-5	16	PM-1.5	19
IE30-1/3	29	IED30-1	28	MCD48-7 1/2	16	PM-18C	22
IE30-1/3-3	29	IED30-1-3	28	MCD60-10	16	PM-18FO	22
IE30-3/4	29	IED36-1 1/2	28	MCD60-15	16	PM-18S	22
IE30-3/4-3	29	IED36-1 1/2-3	28	MCD60-3	16	PM-2	19
IE36-1	29	IED42-2-3	28	MCD60-5	16	PM-2.5	19
IE36-1 1/2	29	IED48-3-3	28	MCD60-7 1/2	16	PM-3	19
IE36-1 1/2-3	29	IHP 20-H-WD	5	MK-1	33	PM-18S	22
IE36-1-3	29	IHP 24-H	3	MK-2	33	PM-18C	22
IE36-1/2	29	IHP 24-H-277	5	MK-3	33	PM-18FO	22
IE36-1/2-3	29	IHP 24-H-WD	5	N-12	21	PUL-1000Q-CD	44
IE36-1/3	29	IHP 30-H	3	NK-PM18	22	PUL-1000Q-TC	44
IE36-1/3-3	29	IHP 30-H-277	5	ODF-12	20	QH-2	44
IE36-2	29	IHP 30-H-WD	5	ODF-16	20	RDS-18	36
IE36-2-3	29	KBWC-110K	23	OSF-16	20	RDS-24	36
IE36-3/4	29	KBWC-15SK	23	PBX 30-D	10	RDS-30	36
IE36-3/4-3	29	LDF-18-TE	21, 46	PBX 36-B	11	RDS-36	36
IE42-1	29	MAG	43	PB 36-B-3	11	RDS-42	36
IE42-1 1/2	29	MAG-22W	48	PB 36-B-HL	11	RDS-48	36
IE42-1 1/2-3	29	MB 24-DF	13	PBX 36-D	10	RDS-54	36
IE42-1-3	29	MB 24-DY	13	PBX 42-B	11	RDS-60	36
IE42-2	29	MB 30-DF	13	PB 42-B-3	11	RE24-1	37
IE42-2-3	29	MB 30-DY	13	PB 42-B-HL	11	RE24-1-3	37
IE42-3-3	29	MBM-W	13	PBX 42-D	10	RE24-1/2	37
IE42-3/4	29	MCD18-1	16, 17	PBX 48-B	11	RE24-1/2-3	37
IE42-3/4-3	29	MCD18-1/3	16, 17	PB 48-B-3	11	RE24-1/4	37
IE48-1	29	MCD18-1/4	16, 17	PB 48-B-HL	11	RE24-1/4-3	37
IE48-1 1/2	29	MCD24-1	16, 17	PB 48-D-OP	10	RE24-3/4	37
IE48-1 1/2-3	29	MCD24-1 1/2	16, 17	PBSX 30-D	10	RE24-3/4-3	37
IE48-1-3	29	MCD24-1/2	16, 17	PBSX 36-B	11	RE30-1	37
IE48-2	29	MCD24-1/3	16, 17	PBS 36-B-3	11	RE30-1 1/2	37
IE48-2-3	29	MCD24-1/4	16, 17	PBS 36-B-HL	11	RE30-1 1/2-3	37
IE48-3-3	29	MCD24-3	16, 17	PBSX 36-D	10	RE30-1-3	37
IE48-3/4	29	MCD24-3/4	16, 17	PBSX 42-B	11	RE30-1/2	37

MODEL	PAGE	MODEL	PAGE	MODEL	PAGE	MODEL	PAGE
RE30-1/2-3	37	RE60-1-3	37	TL-RB-36	47	TXB30-1 1/2	41
RE30-1/3	37	RE60-2	37	TL-RB-50	47	TXB30-1 1/2-3	41
RE30-1/3-3	37	RE60-2-3	37	TRI-HD	42	TXB30-1-3	41
RE30-3/4	37	RE60-3-3	37	TXB12-1/2	41	TXB30-1/2	41
RE30-3/4-3	37	RE60-5-3	37	TXB12-1/2-3	41	TXB30-1/2-3	41
RE36-1	37	RE60-7 1/2-3	37	TXB12-1/3	41	TXB30-2	41
RE36-1 1/2	37	SBX 30-D	12	TXB12-1/3-3	41	TXB30-2-3	41
RE36-1 1/2-3	37	SBX 36-B	12	TXB12-1/4	41	TXB30-3-3	41
RE36-1-3	37	SB 36-B-3	12	TXB12-1/4-3	41	TXB30-5-3	41
RE36-1/2	37	SB 36-B-HL	12	TXB12-3/4	41	TXB34-1 1/2	41
RE36-1/2-3	37	SBX 36-D	12	TXB12-3/4-3	41	TXB34-1 1/2-3	41
RE36-1/3	37	SBX 42-B	12	TXB15-1/2	41	TXB34-2	41
RE36-1/3-3	37	SB 42-B-3	12	TXB15-1/2-3	41	TXB34-2-3	41
RE36-2	37	SB 42-B-HL	12	TXB15-1/3	41	TXB34-3-3	41
RE36-2-3	37	SBX 42-D	12	TXB15-1/3-3	41	TXB34-5-3	41
RE36-3/4	37	SBX 48-B	12	TXB15-1/4	41	TXB42-1 1/2	41
RE36-3/4-3	37	SB 48-B-3	12	TXB15-1/4-3	41	TXB42-1 1/2-3	41
RE42-1	37	SB 48-B-HL	12	TXB15-3/4	41	TXB42-2	41
RE42-1 1/2	37	SF-12	34	TXB15-3/4-3	41	TXB42-2-3	41
RE42-1 1/2-3	37	SF-16	34	TXB18-1	41	TXB42-3-3	41
RE42-1-3	37	SF-18	34	TXB18-1 1/2	41	TXB42-5-3	41
RE42-1/2	37	SF-20	34	TXB18-1 1/2-3	41	TXB48-5-3	41
RE42-1/2-3	37	SF-24	34	TXB18-1-3	41	TXB48-7 1/2-3	41
RE42-2	37	SLS-18	36	TXB18-1/2	41	TXD12-1/2	39
RE42-2-3	37	SLS-24	36	TXB18-1/2-3	41	TXD12-1/2-3	39
RE42-3-3	37	SLS-30	36	TXB18-1/3	41	TXD12-1/4	39
RE42-3/4	37	SLS-36	36	TXB18-1/3-3	41	TXD12-1/4-3	39
RE42-3/4-3	37	SLS-42	36	TXB18-1/4	41	TXD12-3/4	39
RE48-1	37	SLS-48	36	TXB18-1/4-3	41	TXD12-3/4-3	39
RE48-1 1/2	37	SLS-54	36	TXB24-1	41	TXD18-1	39
RE48-1 1/2-3	37	SLS-60	36	TXB24-1 1/2	41	TXD18-1-3	39
RE48-1-3	37	SR-12	34	TXB24-1 1/2-3	41	TXD18-1/2	39
RE48-2	37	SR-16	34	TXB24-1-3	41	TXD18-1/2-3	39
RE48-2-3	37	SR-18	34	TXB24-1/2	41	TXD18-1/3	39
RE48-3-3	37	SR-20	34	TXB24-1/2-3	41	TXD18-1/3-3	39
RE48-3/4	37	SR-24	34	TXB24-2	41	TXD18-1/4	39
RE48-3/4-3	37	SW-1	16	TXB24-2-3	41	TXD18-1/4-3	39
RE48-5-3	37	SW-1 1/2	16	TXB24-3-3	41	TXD24-1	39
RE54-1	37	SW-1 1/2-3	16	TXB24-3/4	41	TXD24-1-3	39
RE54-1 1/2	37	SW-1-3	16	TXB24-3/4-3	41	TXD24-1/2	39
RE54-1 1/2-3	37	SW-1/2	16	TXB27-1	41	TXD24-1/2-3	39
RE54-1-3	37	SW-1/2-3	16	TXB27-1 1/2	41	TXD24-1/3	39
RE54-2	37	SW-1/4	16	TXB27-1 1/2-3	41	TXD24-1/3-3	39
RE54-2-3	37	SW-1/4-3	16	TXB27-1-3	41	TXD24-1/4	39
RE54-3-3	37	SW-2-3	16	TXB27-2	41	TXD24-1/4-3	39
RE54-5-3	37	SW-3-3	16	TXB27-2-3	41	TXD24-2	39
RE60-1	37	SW-5-3	16	TXB27-3/4	41	TXD24-2-3	39
RE60-1 1/2	37	SW-7 1/2-3	16	TXB27-3/4-3	41	TXD24-3-3	39
RE60-1 1/2-3	37	TL-RB-18	47	TXB30-1	41	TXD24-3/4	39

Product Index Listing

MODEL	PAGE	MODEL	PAGE	MODEL	PAGE	MODEL	PAGE
TXD24-3/4-3	39	UEB24-1/2-3	38	UEB60-3-3	38	WH-12	35
TXD27-1	39	UEB24-1/3	38	UEB60-5-3	38	WH-16	35
TXD27-1-3	39	UEB24-1/3-3	38	UED18-1	37	WH-18	35
TXD27-1/2	39	UEB24-3/4	38	UED18-1-3	37	WH-20	35
TXD27-1/2-3	39	UEB24-3/4-3	38	UED18-1/2	37	WH-24	35
TXD27-2	39	UEB30-1	38	UED18-1/2-3	37	WH-30	35
TXD27-2-3	39	UEB30-1-3	38	UED18-1/3	37	WH-36	35
TXD30-1/2	39	UEB30-1/2	38	UED18-1/3-3	37	WH-42	35
TXD30-1/2-3	39	UEB30-1/2-3	38	UED18-1/4	37	WH-48	35
TXD30-2	39	UEB30-3/4	38	UED18-1/4-3	37	WH-60	35
TXD30-2-3	39	UEB30-3/4-3	38	UED24-1	37		
TXD30-3-3	39	UEB36-1	38	UED24-1-3	37		
TXD30-3/4	39	UEB36-1 1/2	38	UED24-1/4	37		
TXD30-3/4-3	39	UEB36-1 1/2-3	38	UED24-1/4-3	37		
TXD34-1 1/2	39	UEB36-1-3	38	UED24-3-3	37		
TXD34-1 1/2-3	39	UEB36-1/2	38	UED24-3/4	37		
TXD34-2	39	UEB36-1/2-3	38	UED24-3/4-3	37		
TXD34-2-3	39	UEB36-3/4	38	UED30-1 1/2	37		
TXD34-3-3	39	UEB36-3/4-3	38	UED30-1 1/2-3	37		
TXD34-5-3	39	UEB42-1	38	UED30-1-3	37		
TXD36-2	39	UEB42-1 1/2	38	UED30-2	37		
TXD36-2-3	39	UEB42-1 1/2-3	38	UED30-2-3	37		
TXD36-3-3	39	UEB42-1-3	38	UED30-3-3	37		
TXD42-1-3	39	UEB42-2	38	UED30-3/4	37		
TXD42-2	39	UEB42-2-3	38	UED30-3/4-3	37		
TXD42-2-3	39	UEB42-3-3	38	UED36-2	37		
TXD42-3-3	39	UEB42-3/4	38	UED36-2-3	37		
TXD42-5-3	39	UEB42-3/4-3	38	UED36-3-3	37		
TXD48-3-3	39	UEB48-1	38	UED36-5-3	37		
TXD48-5-3	39	UEB48-1 1/2	38	UED42-2	37		
TXG-12	39	UEB48-1 1/2-3	38	UED42-2-3	37		
TXG-15	39	UEB48-1-3	38	UED42-5-3	37		
TXG-18	39	UEB48-2	38	UED48-10-3	37		
TXG-24	39	UEB48-2-3	38	UED48-3-3	37		
TXG-27	39	UEB48-3-3	38	UED48-5-3	37		
TXG-30	39	UEB48-3/4	38	UED48-7 1/2-3	37		
TXG-34	39	UEB48-3/4-3	38	UED60-5-3	37		
TXG-36	39	UEB54-1	38	UED60-7 1/2-3	37		
TXG-42	39	UEB54-1 1/2	38	UHP 24-P	4		
TXG-48	39	UEB54-1 1/2-3	38	UHP 24-PJR	4		
U-12-TE	19	UEB54-1-3	38	UHP 24-W	4		
U-18-CR	18	UEB54-2	38	UHP 24-WJR	4		
U-18-TE	19	UEB54-2-3	38	UHP 30-IJR	4		
U-18-TE-HD	19	UEB54-3-3	38	UHP 30-P	4		
U-24-CR	18	UEB54-5-3	38	UHP 30-PJR	4		
U-24-TE	19	UEB60-1 1/2	38	UHP 30-W	4		
U-24-TE-HD	19	UEB60-1 1/2-3	38	UHP 30-WJR	4		
U-24-TE-HV	19	UEB60-2	38	WACM-P	6		
UEB24-1/2	38	UEB60-2-3	38	WACM-W	6		